

Towers Wills

Town & Country

£165,000



6 Coldharbour, Sherborne, Dorset, DT9 4AH

Towers Wills welcome to the market this charming character cottage located a short distance away from the town centre and walking distance of local shops, schools and amenities. Briefly comprising: Entrance, living room with open fire, kitchen, bathroom, two bedrooms, rear garden.

Key Features

- VIDEO TOUR AVAILABLE
- Character home
- Two bedrooms
- Walking distance to local schools, supermarket, shops & amenities
- Wood burning stove

Entrance Hall

Timber front door, cupboard housing the gas and electric meters.

Lounge 16' 9" max x 11' 7" max (5.11m max x 3.53m max)

Under stairs cupboard, stove fireplace, telephone point, television aerial point and a radiator.

Kitchen 11' 10" max x 6' 5" (3.61m max x 1.96m)

Rear facing window, doors to the outside and the hallway, fitted kitchen with wall and base units, work surfaces, tiling, 1 1/2 bowl stainless steel sink and drainer, electric cooker point, plumbing for a washing machine, space for an under counter fridge, radiator and access to the loft.



Bathroom 8' 11" x 5' 8" (2.72m x 1.73m)

Rear facing double glazed window, bath with a shower over, WC, wash hand basin, tiling to splash back and a radiator.

Landing

Airing cupboard housing the hot water tank.

Bedroom One 11' 5" x 8' 8" (3.48m x 2.64m)

Rear facing double glazed window, built in wardrobe and a radiator.



Bedroom Two 15' max x 6' 7" (4.57m max x 2.01m)

Front facing secondary glazed window, radiator and access to the loft.

Rear Garden

To the rear there is a paved seating area with the remainder laid to lawn with flower and shrub borders, timber shed and a side access gate.



Floor Plan

Energy Efficiency and
Environmental Impact
Pending

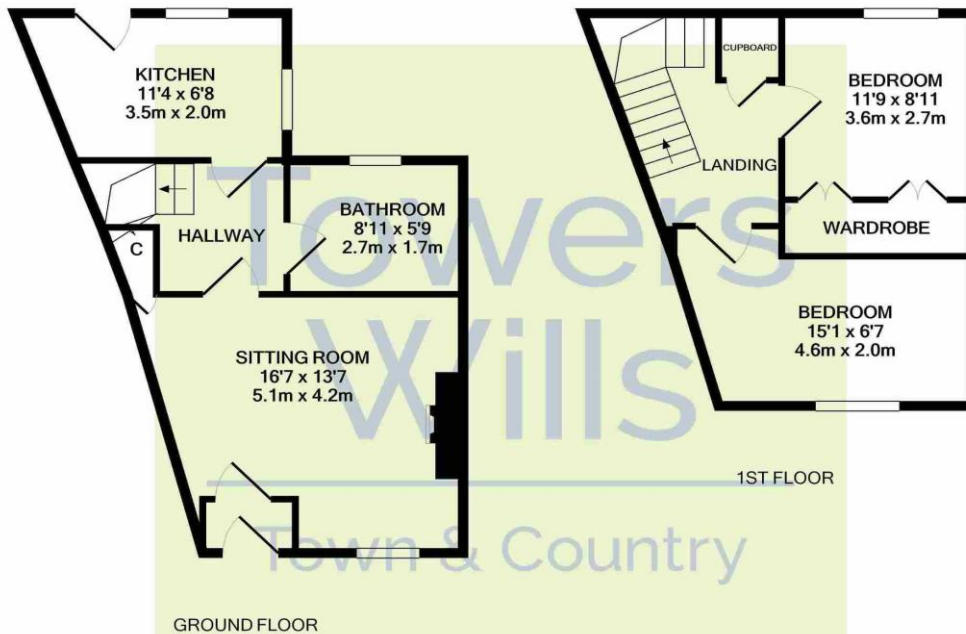

Whilst every attempt has been made to ensure the accuracy of the floor plan contained here, measurements of doors, windows, rooms and any other items are approximate and no responsibility is taken for any error, omission, or mis-statement. This plan is for illustrative purposes only and should be used as such by any prospective purchaser. The services, systems and appliances shown have not been tested and no guarantee as to their operability or efficiency can be given
Made with Metropix ©2020

Please Note No tests have been undertaken of any of the services and any intending purchasers should satisfy themselves in this regard. Towers Wills Ltd for themselves and for the vendor of this property whose agents they are, give notice that, (i) these particulars do not constitute any part of an offer or contract, (ii) all statements contained within these particulars are made without responsibility on the part of Towers Wills or the vendor, (iii) whilst made in good faith, none of the statements contained within these particulars are to be relied upon as a statement of representation or fact, (iv) any intending purchaser must satisfy him/herself by inspection or otherwise as to the correctness of each of the statements contained within these particulars, (v) the vendor does not make or give either Towers Wills or any person in their employment any authority to make or give representation or warranty whatsoever in relation to this property.

Photographs / Floor Plans Photographs are reproduced for general information and it must not be inferred that any item is included for sale with this property. Please note floor plans are not to scale and are for identification purposes only. The photographs used in these particulars may have been taken with the use of a wide angle lens. If you have any queries as to the size of the accommodation or plot, please address these with the agent prior to making an appointment to view.

Towers Wills

The White House, 114 Hendford Hill, Yeovil BA20 2RF

Yeovil 01935 577032 / South Petherton 01460 298530

info@towerswills.co.uk www.towerswills.co.uk