

Towers Wills

Town & Country

Offers in excess of
£230,000



15 Akeman Close, Yeovil, Somerset, BA21 3QS

Towers Wills welcome to market this detached family home situated on the Western side of Yeovil. Selling with no onward chain the property is less than a mile walk to local amenities including; convenience stores, schools (secondary & primary) and would make an ideal first time buy or buy to let investment.

Key Features

- Three bedrooms
- Detached
- Cloak W.C
- No onward chain
- Parking & Garage
- Popular residential location

Entrance Hall

Double glazed door to the front, double glazed window to the side and radiator.

W.C

Double glazed window to the front, radiator, w.c, wash hand basin and plumbing for washing machine.

Lounge 5.35m x 4.38m - maximum measurements

Two radiators, double glazed window to the front and stairs leading to the first floor.

Kitchen Diner 3.00m x 4.36m - maximum measurements

Comprising of a range of wall, base and drawer units, work surfacing with stainless steel one bowl sink drainer, radiator, double glazed French doors to the rear, double glazed window to the rear, under stairs cupboard, space for dishwasher, integrated gas hob and electric oven with cooker hood over, space for fridge freezer and central heating boiler.

First Floor Landing

Double glazed window to the side, loft hatch and airing cupboard with tank.

Bedroom One 4.07m x 2.54m - maximum measurements

Radiator and double glazed window to the front.

En-suite

Comprising shower cubicle, wash hand basin, w.c, double glazed window to the side, radiator, shaver point and extractor fan.

Bedroom Two 3.22m x 2.54m - maximum measurements

Radiator and double glazed window to the rear.

Bedroom Three 2.67m x 1.76m

Radiator and double glazed window to the front.

Bathroom

Suite comprising bath with electric shower over, wash hand basin, w.c, double glazed window to the rear, radiator and extractor fan.

Outside

Front Garden

Enjoying a private front aspect. To the front there is a gravel area.

Rear Garden

To the rear there is an area of lawn, patio and side gate.

Garage in a Block

With 'up and over' door and one parking space in front.

Parking

For x2 vehicles



Floor Plan

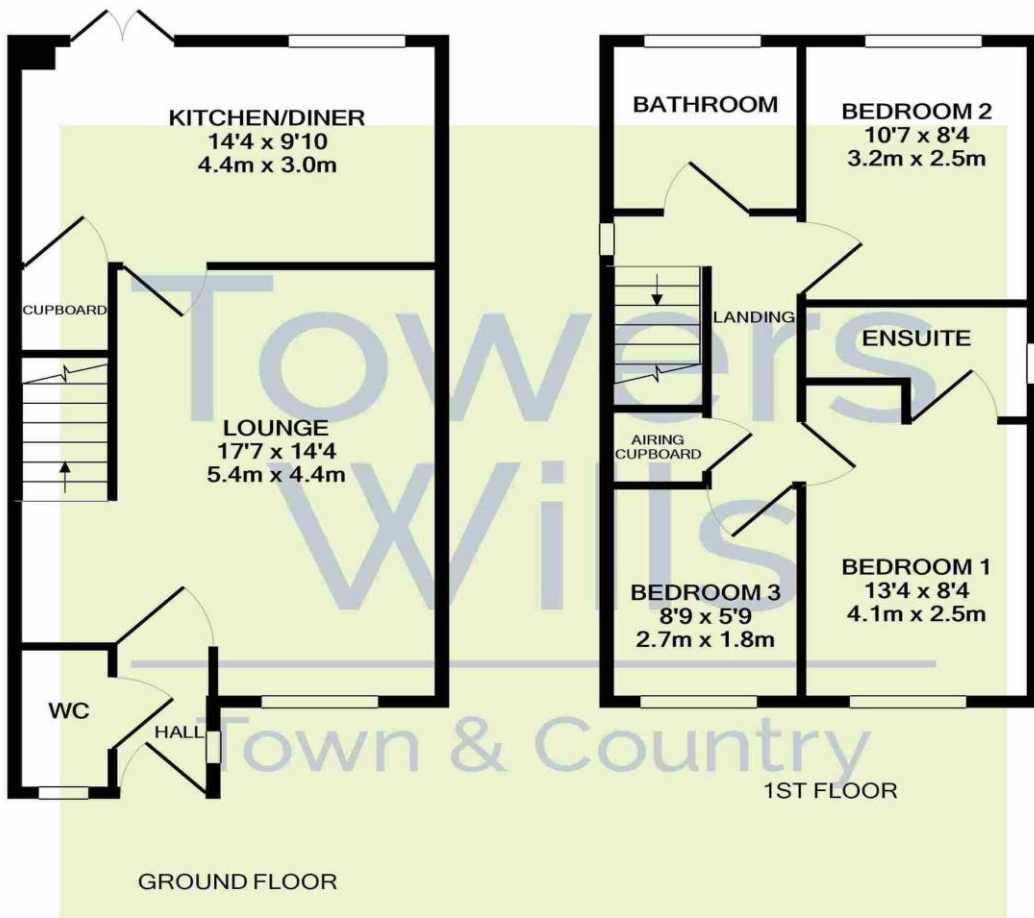

Whilst every attempt has been made to ensure the accuracy of the floor plan contained here, measurements of doors, windows, rooms and any other items are approximate and no responsibility is taken for any error, omission, or mis-statement. This plan is for illustrative purposes only and should be used as such by any prospective purchaser. The services, systems and appliances shown have not been tested and no guarantee as to their operability or efficiency can be given
Made with Metropix ©2021

Please Note No tests have been undertaken of any of the services and any intending purchasers should satisfy themselves in this regard. Towers Wills Ltd for themselves and for the vendor of this property whose agents they are, give notice that, (i) these particulars do not constitute any part of an offer or contract, (ii) all statements contained within these particulars are made without responsibility on the part of Towers Wills or the vendor, (iii) whilst made in good faith, none of the statements contained within these particulars are to be relied upon as a statement of representation or fact, (iv) any intending purchaser must satisfy him/herself by inspection or otherwise as to the correctness of each of the statements contained within these particulars, (v) the vendor does not make or give either Towers Wills or any person in their employment any authority to make or give representation or warranty whatsoever in relation to this property.

Photographs / Floor Plans Photographs are reproduced for general information and it must not be inferred that any item is included for sale with this property. Please note floor plans are not to scale and are for identification purposes only. The photographs used in these particulars may have been taken with the use of a wide angle lens. If you have any queries as to the size of the accommodation or plot, please address these with the agent prior to making an appointment to view.

Towers Wills

The White House, 114 Hendford Hill, Yeovil BA20 2RF

Yeovil 01935 577032 / South Petherton 01460 298530

info@towerswills.co.uk www.towerswills.co.uk