

Towers Wills

Town & Country

£120,000



83a Greenwood Road, Yeovil, Somerset, BA21 3LF

Towers Wills welcome to market this well-presented first floor apartment, an ideal first time buy or buy to let investment. With its own street level entrance and stairs leading to the apartment, the property consists of two bedrooms (one with own toilet), kitchen, lounge/diner, bathroom and on-street parking. Selling with no onward chain, this is one not to miss! Please contact Towers Wills to arrange a viewing.

Key Features

- First floor flat
- Two good size bedrooms
- In excellent condition throughout
- NO ONWARD CHAIN
- Popular location

Entrance

Double glazed door to the front with stairs to the flat.

Hall/Landing

Radiator, cupboard and loft hatch which is boarded and has a ladder.

Kitchen 2.77m x 2.40m

Comprising of a range of wall, base and drawer units, work surfacing with stainless steel one and a half bowl sink/drain, double glazed window to the rear, integrated electric oven/grill, integrated gas hob with cookerhood over, space for washing machine, space for dishwasher, space for fridge/freezer and gas central heating boiler.

Lounge/Diner 3.77m x 5.04m - maximum measurements

Double glazed window to the front and radiator.

Bathroom

Suite comprising shower cubicle, wash hand basin, w.c, shaver point, heated towel rail and double-glazed window to the rear.

Bedroom One 3.92m x 2.86m

Double glazed window to the rear and radiator.

En-suite

Comprising wash hand basin, w.c. and radiator.

Bedroom Two 4.32m x 3.28m - maximum measurements

Double glazed window to the front, radiator and built-in cupboard.

Agents Note

Vendor has advised Towers Wills of the following: Lease to be renewed on completion. £1 per annum ground rent and no service charge.



Floor Plan

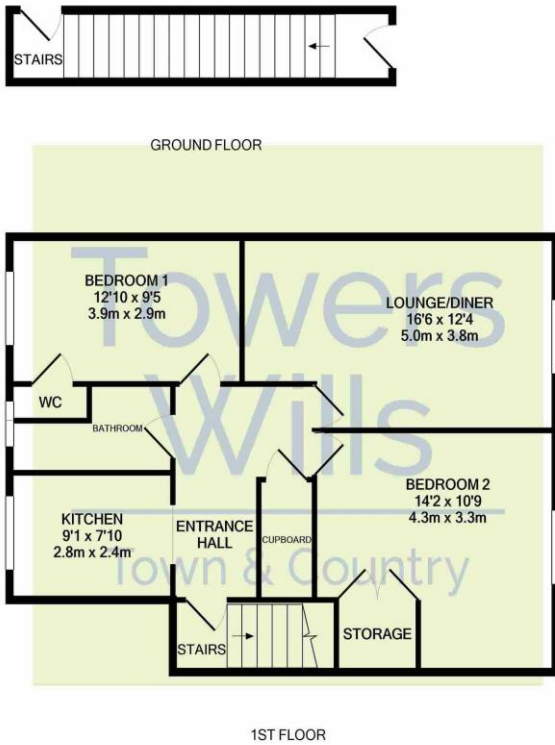

Whilst every attempt has been made to ensure the accuracy of the floor plan contained here, measurements of doors, windows, rooms and any other items are approximate and no responsibility is taken for any error, omission, or mis-statement. This plan is for illustrative purposes only and should be used as such by any prospective purchaser. The services, systems and appliances shown have not been tested and no guarantee as to their operability or efficiency can be given
Made with Metropix ©2021

Energy Efficiency

Score	Energy rating	Current	Potential
92+	A		
81-91	B		
69-80	C		73 C
55-68	D	64 D	
39-54	E		
21-38	F		
1-20	G		

Please Note No tests have been undertaken of any of the services and any intending purchasers should satisfy themselves in this regard. Towers Wills Ltd for themselves and for the vendor of this property whose agents they are, give notice that, (i) these particulars do not constitute any part of an offer or contract, (ii) all statements contained within these particulars are made without responsibility on the part of Towers Wills or the vendor, (iii) whilst made in good faith, none of the statements contained within these particulars are to be relied upon as a statement of representation or fact, (iv) any intending purchaser must satisfy him/herself by inspection or otherwise as to the correctness of each of the statements contained within these particulars, (v) the vendor does not make or give either Towers Wills or any person in their employment any authority to make or give representation or warranty whatsoever in relation to this property.

Photographs / Floor Plans Photographs are reproduced for general information and it must not be inferred that any item is included for sale with this property. Please note floor plans are not to scale and are for identification purposes only. The photographs used in these particulars may have been taken with the use of a wide angle lens. If you have any queries as to the size of the accommodation or plot, please address these with the agent prior to making an appointment to view.

Towers Wills

The White House, 114 Hendford Hill, Yeovil BA20 2RF

Yeovil 01935 577032 / South Petherton 01460 298530

info@towerswills.co.uk www.towerswills.co.uk