

# Towers Wills

Town & Country

📞 01935 577 032 | 01460 298 530 | ✉ info@towerswills.co.uk



31, Paulls Close, Martock, Somerset TA12 6DE

Offers Over **£110,000**

Towers Wills are delighted to be chosen to bring to market this one bed ground floor apartment situated in the sought after village location of Martock, with many local amenities nearby. The flat benefits from a secure allocated parking space, while inside an open plan kitchen/living area, double bedroom and shower room and storage throughout. An ideal first time buy or investment.

## Description

Towers Wills are delighted to be chosen to bring to market this one bed ground floor apartment situated in the sought after village location of Martock, with many local amenities nearby. The flat benefits from a secure allocated parking space, while inside an open plan kitchen/living area, double bedroom and shower room and storage throughout. An ideal first time buy or investment.

## Entrance Hall

With two storage cupboards and housing the hot water cylinder, radiator and window to the rear.

## Bedroom

With double glazed window to the front, radiator and double storage cupboard.

## Bathroom

Suite comprising bath with shower over, wash hand basin, w.c, heated towel rail, tiled floor and frosted window to the rear.

## Open Plan Living/Kitchen

### Living Room

With double glazed window to the front, radiator and being open plan to the kitchen.

### Kitchen Area

Comprising of a range of wall, base and drawer units, work surfacing with stainless steel sink/drain, space for fridge/freezer, space for washing machine, NEFF double electric oven with hob over, four ring hob and window overlooking the allocated parking space.

## Outside

There is one allocated parking space.

## Agents Note

Lease hold length - 83 years remaining

Ground Rent- None

Service Charge - £142.63 a month = £1711.52pa also communal area gardening: £110.00pa

## Key Features

- Desirable village location
- Open plan Living
- Allocated parking space
- Ground Floor
- One Bedroom

## Contact Us

### Towers Wills Estate Agents - Yeovil

114, Hendford Hill

Yeovil

Somerset

BA202RF

T: 01935 577032

E: [info@towerswills.co.uk](mailto:info@towerswills.co.uk)

## Energy Efficiency

Score	Energy rating	Current	Potential
92+	A		
81-91	B		81   B
69-80	C	75   C	
55-68	D		
39-54	E		
21-38	F		
1-20	G		



# Floor Plan

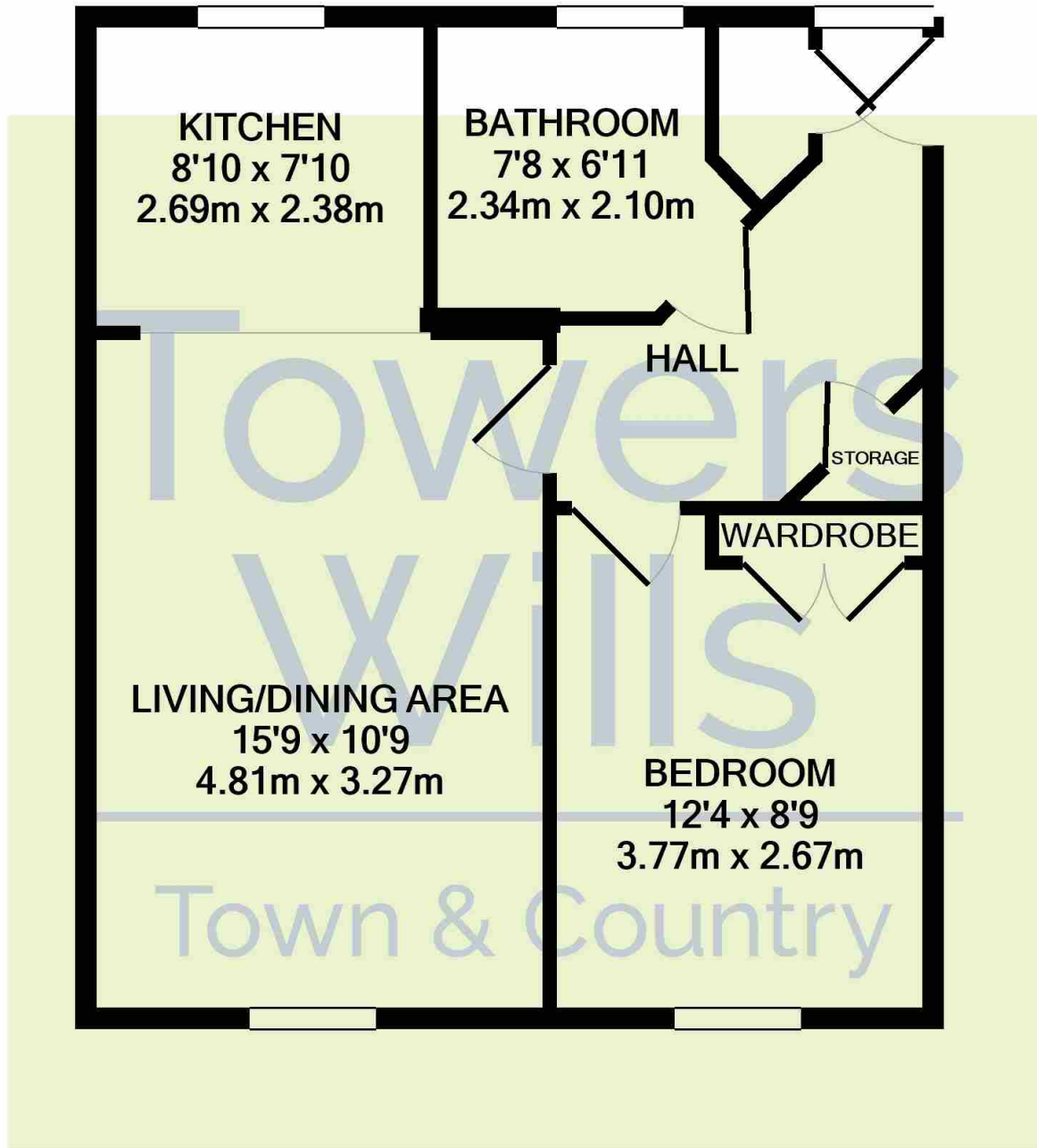

Whilst every attempt has been made to ensure the accuracy of the floor plan contained here, measurements of doors, windows, rooms and any other items are approximate and no responsibility is taken for any error, omission, or mis-statement. This plan is for illustrative purposes only and should be used as such by any prospective purchaser. The services, systems and appliances shown have not been tested and no guarantee as to their operability or efficiency can be given  
Made with Metropix ©2022

Please Note No tests have been undertaken of any of the services and any intending purchasers should satisfy themselves in this regard. Towers Wills Ltd for themselves and for the vendor of this property whose agents they are, give notice that, (i) these particulars do not constitute any part of an offer or contract, (ii) all statements contained within these particulars are made without responsibility on the part of Towers Wills or the vendor, (iii) whilst made in good faith, none of the statements contained within these particulars are to be relied upon as a statement of representation or fact, (iv) any intending purchaser must satisfy him/herself by inspection or otherwise as to the correctness of each of the statements contained within these particulars, (v) the vendor does not make or give either Towers Wills or any person in their employment any authority to make or give representation or warranty whatsoever in relation to this property.

**Towers Wills**

The White House, 114 Hendford Hill, Yeovil BA20 2RF

Yeovil 01935 577032 / South Petherton 01460 298530

[info@towerswills.co.uk](mailto:info@towerswills.co.uk) | [www.towerswills.co.uk](http://www.towerswills.co.uk)