

# Towers Wills

Town & Country

☎ 01935 577 032 | 01460 298 530 | ✉ [info@towerswills.co.uk](mailto:info@towerswills.co.uk)



**15, Holly Tree Walk, Yeovil, Somerset BA20 2NT**

**Guide Price £190,000**

Towers Wills welcome to the market this immaculately presented two bedroom property. Comprising: Porch, living room, kitchen/ diner, two bedrooms, bathroom, garden and garage. The property is an excellent first time/ investment opportunity within walking distance of Holy Trinity primary school, Leonardo Helicopters and local supermarkets.

**Porch:**

With double glazed door and window to the front.

**Living room:** 4.23m x 3.38m (14' x 11'1")

With double glazed window to the front, radiator.

**Kitchen / diner** 4.24m x 2.71m (14' x 9')

A beautifully presented refitted kitchen comprising of a range of wall and base units, work surfacing with stainless steel sink inset. Electric and gas cooker points. Plumbing for washing machine. Two good sized under stairs storage cupboard. Double glazed door and window to the rear. Radiator.

**Landing:**

Stairs from inner hallway. Loft access.

**Bedroom one:** 4.24m x 3.44m (14' x 11'3")

With double glazed window to the front, built in wardrobe, radiator.

**Bedroom two:** 2.77m x 2.28m ( 9'1" x 7'5")

With double glazed window to the rear, built in wardrobe, radiator.

**Bathroom:**

An immaculately presented refitted white suite comprising bath with shower over and glass screen, W.C, wash hand basin, shaver point, part wall tiling, double glazed window to the rear.

**Outside:**

To the front the garden is laid to lawn with path leading to the entrance. To the rear an immaculate enclosed garden has been beautifully landscaped for low maintenance. Shrub borders, small vegetable garden, security light and tap. A path and gate to the rear which leads to the garage and car park area.

**Garage:**

Situated in a block to the rear with 'up and over door'.

## Key Features

- Two bedrooms
- Kitchen/ diner
- Beautifully presented
- Close proximity to Leonardo Helicopters, Holy Trinity School and amenities
- Garage
- Gas central heated
- Double glazed

## Contact Us

**Towers Wills Estate Agents - Yeovil**

114, Hendford Hill  
Yeovil

Somerset

BA202RF

T: 01935 577032

E: [info@towerswills.co.uk](mailto:info@towerswills.co.uk)



# Floor Plan

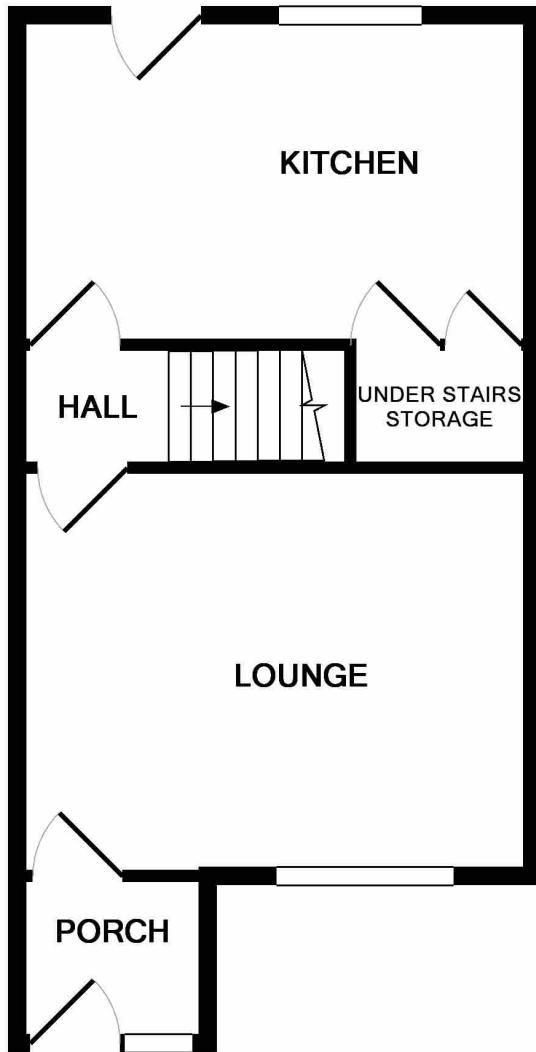

GROUND FLOOR

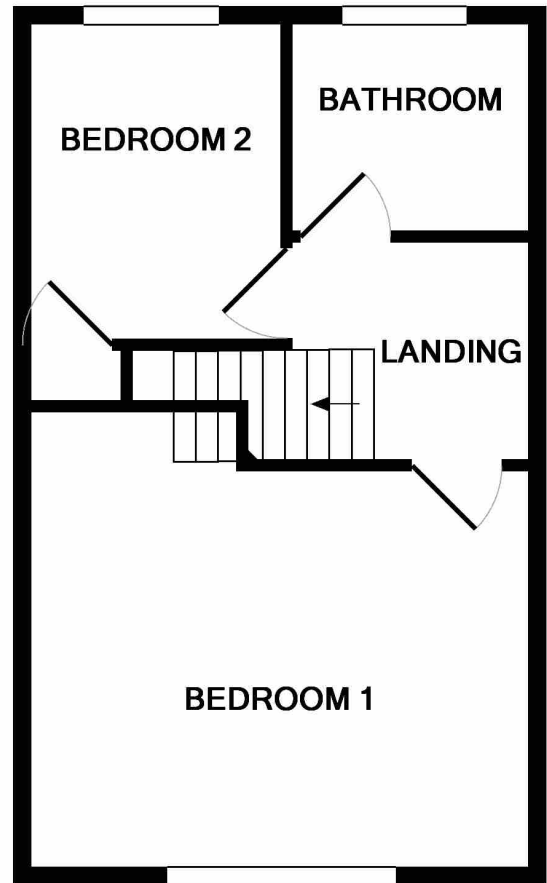

1ST FLOOR

Whilst every attempt has been made to ensure the accuracy of the floor plan contained here, measurements of doors, windows, rooms and any other items are approximate and no responsibility is taken for any error, omission, or mis-statement. This plan is for illustrative purposes only and should be used as such by any prospective purchaser. The services, systems and appliances shown have not been tested and no guarantee as to their operability or efficiency can be given  
Made with Metropix ©2018

Please Note No tests have been undertaken of any of the services and any intending purchasers should satisfy themselves in this regard. Towers Wills Ltd for themselves and for the vendor of this property whose agents they are, give notice that, (i) these particulars do not constitute any part of an offer or contract, (ii) all statements contained within these particulars are made without responsibility on the part of Towers Wills or the vendor, (iii) whilst made in good faith, none of the statements contained within these particulars are to be relied upon as a statement of representation or fact, (iv) any intending purchaser must satisfy him/herself by inspection or otherwise as to the correctness of each of the statements contained within these particulars, (v) the vendor does not make or give either Towers Wills or any person in their employment any authority to make or give representation or warranty whatsoever in relation to this property.

Photographs / Floor Plans Photographs are reproduced for general information and it must not be inferred that any item is included for sale with this property. Please note floor plans are not to scale and are for identification purposes only. The photographs used in these particulars may have been taken with the use of a wide angle lens. If you have any queries as to the size of the accommodation or plot, please address these with the agent prior to making an appointment to view

**Towers Wills**

The White House, 114 Hendford Hill, Yeovil BA20 2RF

Yeovil 01935 577032 / South Petherton 01460 298530

[info@towerswills.co.uk](mailto:info@towerswills.co.uk) | [www.towerswills.co.uk](http://www.towerswills.co.uk)