

Towers Wills

Town & Country

☎ 01935 577 032 | 01460 298 530 | ✉ info@towerswills.co.uk



78, Nelson Way, Yeovil, Somerset BA21 5DT

OIEO £130,000

An ideal first time buy or investment property! This well-presented first floor apartment comes with allocated parking, two double bedrooms with master en-suite, bathroom and open plan kitchen/lounge area with balcony access and far-reaching countryside views. Please contact Towers Wills for more information and to arrange viewings.

Description

An ideal first time buy or investment property! This well-presented first floor apartment comes with allocated parking, two double bedrooms with master en-suite, bathroom and open plan kitchen/lounge area with balcony access and far-reaching countryside views. Please contact Towers Wills for more information and to arrange viewings.

Ground floor communal entrance:

With stairs leading to the first floor.

Entrance Hall

Double glazed window to the rear, door to communal hallway, radiator, intercom and two storage cupboards.

Bedroom One 3.03m x 4.54m – maximum measurements

Radiator and double glazed window to the front.

En-suite

Suite comprising shower cubicle, wash hand basin, w.c, heated towel rail, extractor fan and shaver point.

Bedroom Two 3.53m x 2.63m

Radiator and double glazed window to the front.

Bathroom

Suite comprising bath with mixer tap shower over, wash hand basin, w.c, double glazed window to the rear, heated towel rail, extractor fan and shaver point.

Open Plan Kitchen & Lounge 4.49m x 5.86m – maximum measurements

Double glazed patio doors leading to the balcony at the front of the property, radiator and double glazed window to the rear.

Kitchen Area

Comprising of a range of wall, base and drawer units, work surfacing with stainless steel one bowl sink drainer, integrated gas hob with cookerhood over, integrated electric oven, radiator, extractor fan, integrated dishwasher, integrated fridge, integrated freezer, integrated washer/dryer and gas central heating boiler.

Outside

The property has one allocated car parking space.

Agents Note

The vendor has advised that the most recent fees for the property were:

Maintenance charge: £53.66 per 6 months

Ground rent: £87.50 per 6 months

Service Charge: Circa £130/month

The property is selling with circa 115 years remaining on the lease.

Key Features

- First Floor Apartment
- Two Bedrooms
- En-suite
- Allocated Parking
- Far-reaching Countryside Views

Contact Us

Towers Wills Estate Agents - Yeovil

114, Hendford Hill

Yeovil

Somerset

BA202RF

T: 01935 577032

E: info@towerswills.co.uk



Floor Plan

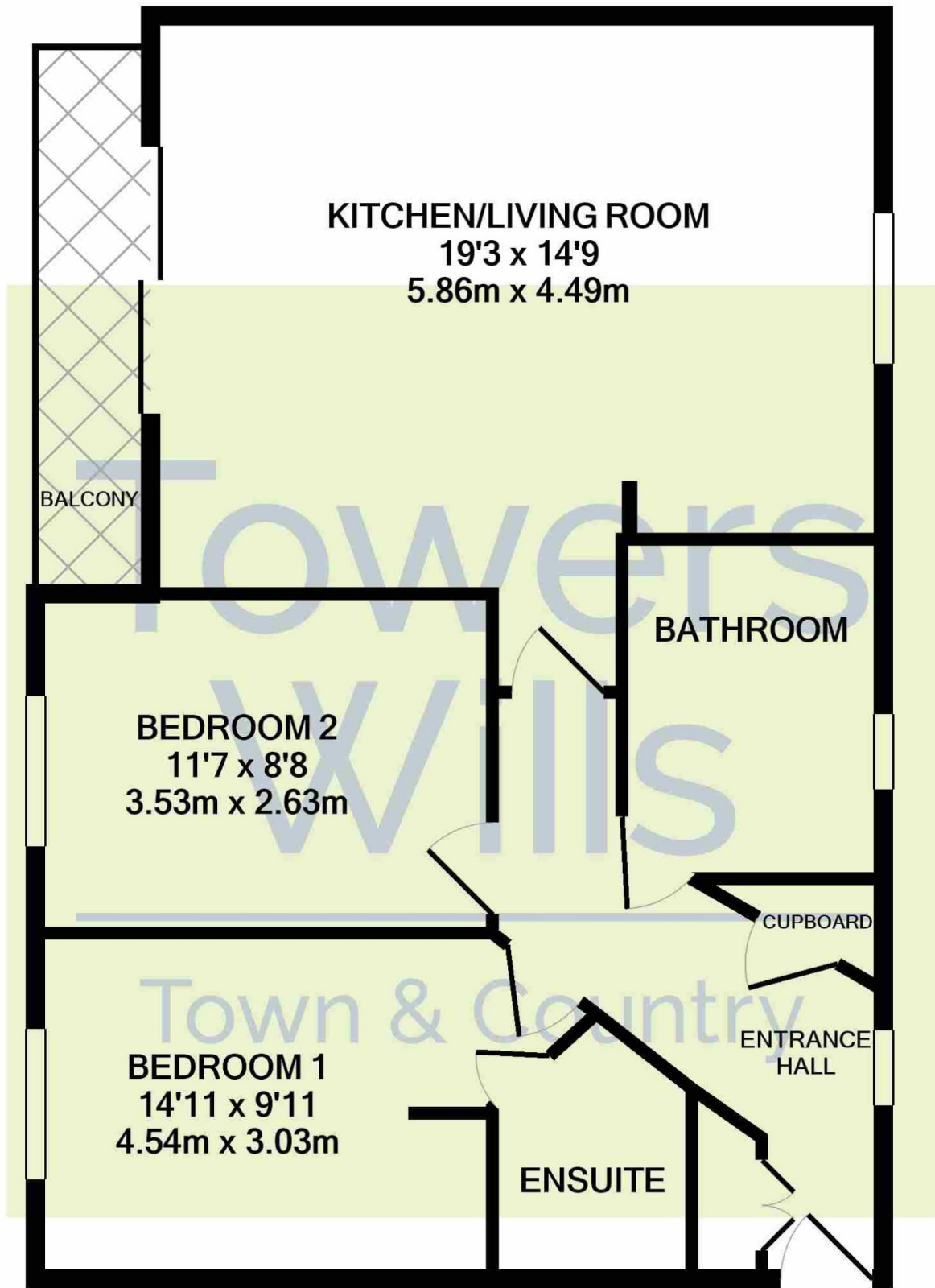

Whilst every attempt has been made to ensure the accuracy of the floor plan contained here, measurements of doors, windows, rooms and any other items are approximate and no responsibility is taken for any error, omission, or mis-statement. This plan is for illustrative purposes only and should be used as such by any prospective purchaser. The services, systems and appliances shown have not been tested and no guarantee as to their operability or efficiency can be given
 Made with Metropix ©2022

Please Note No tests have been undertaken of any of the services and any intending purchasers should satisfy themselves in this regard. Towers Wills Ltd for themselves and for the vendor of this property whose agents they are, give notice that, (i) these particulars do not constitute any part of an offer or contract, (ii) all statements contained within these particulars are made without responsibility on the part of Towers Wills or the vendor, (iii) whilst made in good faith, none of the statements contained within these particulars are to be relied upon as a statement of representation or fact, (iv) any intending purchaser must satisfy him/herself by inspection or otherwise as to the correctness of each of the statements contained within these particulars, (v) the vendor does not make or give either Towers Wills or any person in their employment any authority to make or give representation or warranty whatsoever in relation to this property.

Photographs / Floor Plans Photographs are reproduced for general information and it must not be inferred that any item is included for sale with this property. Please note floor plans are not to scale and are for identification purposes only. The photographs used in these particulars may have been taken with the use of a wide angle lens. If you have any queries as to the size of the accommodation or plot, please address these with the agent prior to making an appointment to view

Towers Wills

The White House, 114 Hendford Hill, Yeovil BA20 2RF

Yeovil 01935 577032 / South Petherton 01460 298530

info@towerswills.co.uk | www.towerswills.co.uk