

Towers Wills

Town & Country

📞 01935 577 032 | 01460 298 530 | ✉ info@towerswills.co.uk



10, Arundel Road, Yeovil, Somerset BA21 5JZ

Offers Over **£200,000**

Towers Wills welcome to the market this well presented terrace property in this popular location. A perfect first time buy and briefly comprises lounge, kitchen/diner, three bedrooms, modern bathroom, low maintenance garden and benefits from NO ONWARD CHAIN. Early viewing advised.

Door leading into the dining room.

Dining Room 3.08m x 3.21m

Open plan to the kitchen, laminate flooring and recess lighting.

Kitchen 2.54m x 4.50m

A modern kitchen fitted with patterned worktops, coloured doors with a good range of wall and base units. A sink drainer unit with mixer tap, a five ring gas hob with splashback and extractor hood over, separate oven, space for fridge, plumbing for washing machine, space for dishwasher and window with outlook to the front.

Hallway

With laminate flooring, radiator, stairs to first floor landing and door leading to the conservatory.

Conservatory 2.08m x 5.51m

With double doors leading out to the rear.

Lounge 3.80m x 3.84m maximum measurements

With window outlook to the rear, laminate flooring and tv point.

First Floor Landing

With cupboard and hatch to roof space.

Bedroom One 3.72m x 3.78m maximum measurements

With window outlook to the rear and double built-in wardrobe.

Bedroom Two 2.86m x 3.30m

With window outlook to the front, radiator and double built-in wardrobe.

Bedroom Three 2.40m x 2.62m

With window outlook to the rear and radiator.

Bathroom 1.80m x 2.62m

A modern suite with freestanding bath, mixer tap, separate double shower, WC, wash hand basin vanity unit, mixer tap, double cupboard under and window with outlook to the front.

Garden

To the rear the garden is low maintenance with patio area, decking area, enclosed by lap panel fencing and gate leading out to the rear. To the front the garden is tiered with patio area and shed.

Key Features

- Terrace
- Three bedrooms
- Ideal First Time Buy
- NO ONWARD CHAIN
- Early Viewing Advised

Contact Us

Towers Wills Estate Agents - Yeovil

114, Hendford Hill
Yeovil

Somerset

BA202RF

T: 01935 577032

E: info@towerswills.co.uk



Floor Plan

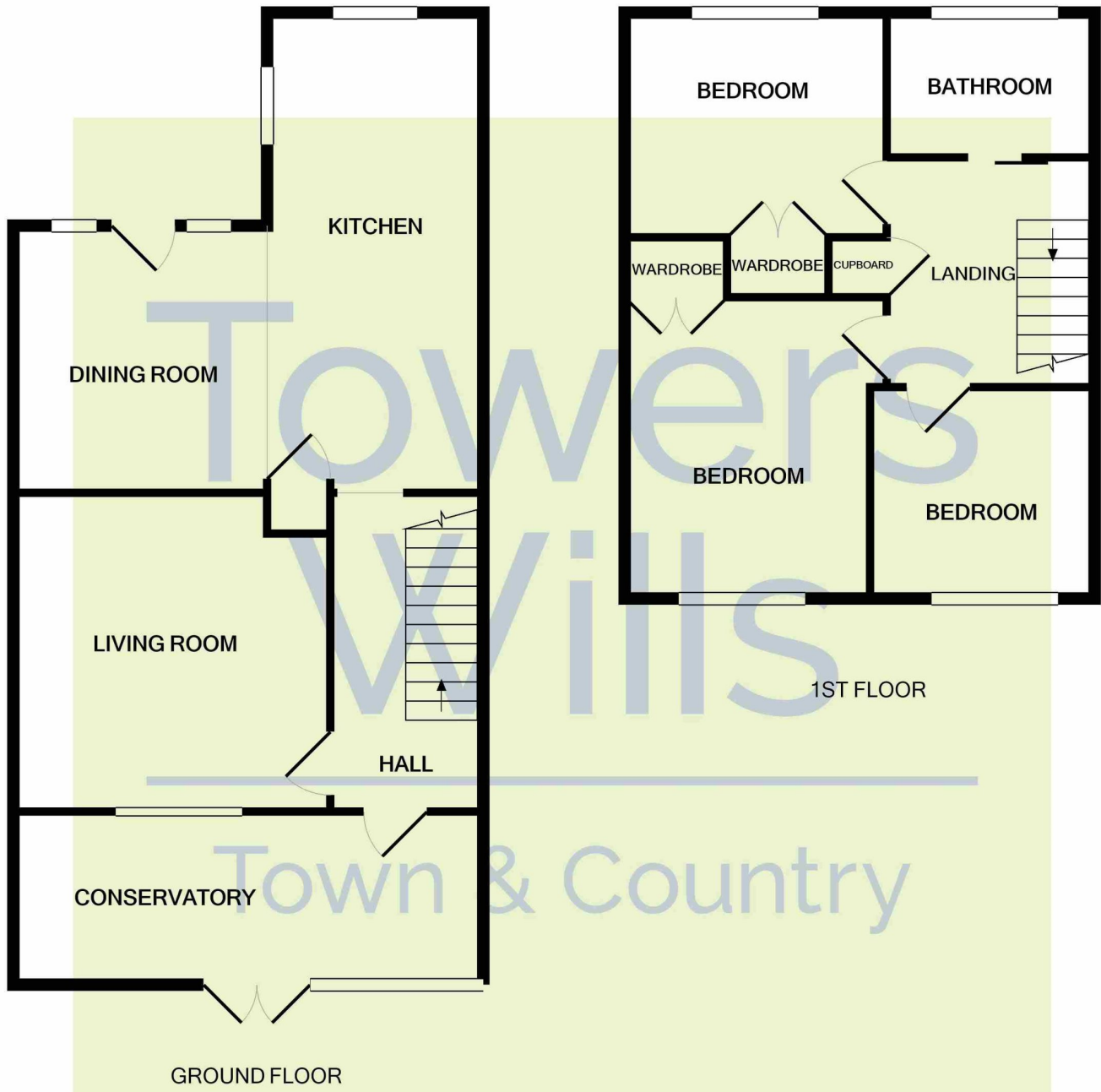

Whilst every attempt has been made to ensure the accuracy of the floor plan contained here, measurements of doors, windows, rooms and any other items are approximate and no responsibility is taken for any error, omission, or mis-statement. This plan is for illustrative purposes only and should be used as such by any prospective purchaser. The services, systems and appliances shown have not been tested and no guarantee as to their operability or efficiency can be given
Made with Metropix ©2022

Please Note No tests have been undertaken of any of the services and any intending purchasers should satisfy themselves in this regard. Towers Wills Ltd for themselves and for the vendor of this property whose agents they are, give notice that, (i) these particulars do not constitute any part of an offer or contract, (ii) all statements contained within these particulars are made without responsibility on the part of Towers Wills or the vendor, (iii) whilst made in good faith, none of the statements contained within these particulars are to be relied upon as a statement of representation or fact, (iv) any intending purchaser must satisfy him/herself by inspection or otherwise as to the correctness of each of the statements contained within these particulars, (v) the vendor does not make or give either Towers Wills or any person in their employment any authority to make or give representation or warranty whatsoever in relation to this property.

Photographs / Floor Plans Photographs are reproduced for general information and it must not be inferred that any item is included for sale with this property. Please note floor plans are not to scale and are for identification purposes only. The photographs used in these particulars may have been taken with the use of a wide angle lens. If

Towers Wills

The White House, 114 Hendford Hill, Yeovil BA20 2RF

Yeovil 01935 577032 / South Petherton 01460 298530

info@towerswills.co.uk | www.towerswills.co.uk