

Towers Wills

Town & Country

📞 01935 577 032 | 01460 298 530 | ✉ info@towerswills.co.uk



26, Combe Street Lane, Yeovil, Somerset BA21 3PD

Guide Price £500,000

This well-presented detached family home is situated in one of the most sought-after locations in Yeovil and offers stunning countryside views from the rear of the property. The property comprises of open plan kitchen and dining area, separate lounge, laundry, study/bedroom 5, downstairs cloakroom and conservatory. Upstairs the four double bedrooms with master ensuite and family bathroom. Outside the property has ample driveway parking, storage sheds (one with power), seating areas to the rear ideal for alfresco dining plus patio and lawned area.

Entrance Hall

Double glazed door to the front, radiator and under stairs cupboard.

Kitchen Area 6.13m x 2.33m – maximum measurements

Comprising of a range of wall, base and drawer units, Quartz worktops with stainless steel one and a half bowl sink drainer, three double glazed windows to the front, space for American style fridge freezer, integrated microwave, radiator, Rangemaster cooker with five ring gas hob and electric oven, cookerhood over, integrated dishwasher and open arch to the dining area.

Dining Area 4.41m x 3.32m – maximum measurements

Radiator, double glazed patio doors to conservatory and under stairs larder.

Lounge 3.57m x 4.77m – maximum measurements

Double glazed window to conservatory, double glazed French doors to conservatory, radiator, gas fireplace and wall lighting.

Downstairs W.C

Double glazed window to the side, wash hand basin and w.c.

Cupboard/Boot Room

Double glazed window to the side.

Utility Room 1.02m x 4.27m – maximum measurements

Single glazed window to the rear, space for washing machine, space for dryer, worktop and base units.

Study/Bedroom 5 2.44m x 4.99m – maximum measurements

Electric mounted wall heater, double glazed window to the rear, double glazed door to the rear and cupboard which includes the gas central heating boiler.

Conservatory 8.32m x 2.43m increasing to 3.45m – maximum measurements

Three radiators, double glazed windows to rear and double glazed French doors to the rear.

First Floor Landing

Loft hatch.

Bedroom One 3.40m x 4.78m – maximum measurements

Two double glazed windows to the rear with countryside views and radiator.

En-suite

Suite comprising shower cubicle, wash hand basin, w.c, double glazed window to the side, extractor fan and heated towel rail.

Bedroom Two 3.32m x 2.75m – maximum measurements

Double glazed window to the rear with countryside views, radiator and

Key Features

- Desirable Location
- Countryside Views
- Ample Off Road Parking
- Study/Additional Downstairs Bedroom
- Master En-suite
- Large conservatory

Contact Us

Towers Wills Estate Agents - Yeovil
114, Hendford Hill
Yeovil
Somerset
BA202RF
T: 01935 577032
E: info@towerswills.co.uk

Energy Efficiency

Score	Energy rating	Current	Potential
92+	A		
81-91	B		82 B
69-80	C	76 C	
55-68	D		
39-54	E		
21-38	F		
1-20	G		

built-in wardrobe.

Bedroom Three 2.52m x 4.48m – maximum measurements

Two double glazed windows to the front and radiator.

Bedroom Four 3.03m x 3.05m

Double glazed window to the front, radiator and built-in wardrobe.

Bathroom

Suite comprising corner Jacuzzi bath with shower over, wash hand basin, w.c, double glazed window to the side and heated towel rail.

Outside

To the front of the property there is a driveway providing ample parking for four cars, lawn area, mature planted beds and outside tap.

Rear Garden

To the rear of the property is a tiered garden offering countryside views, large patio area, lawn, storage shed to the side of the property with power and light, garden shed and outside power.



Floor Plan

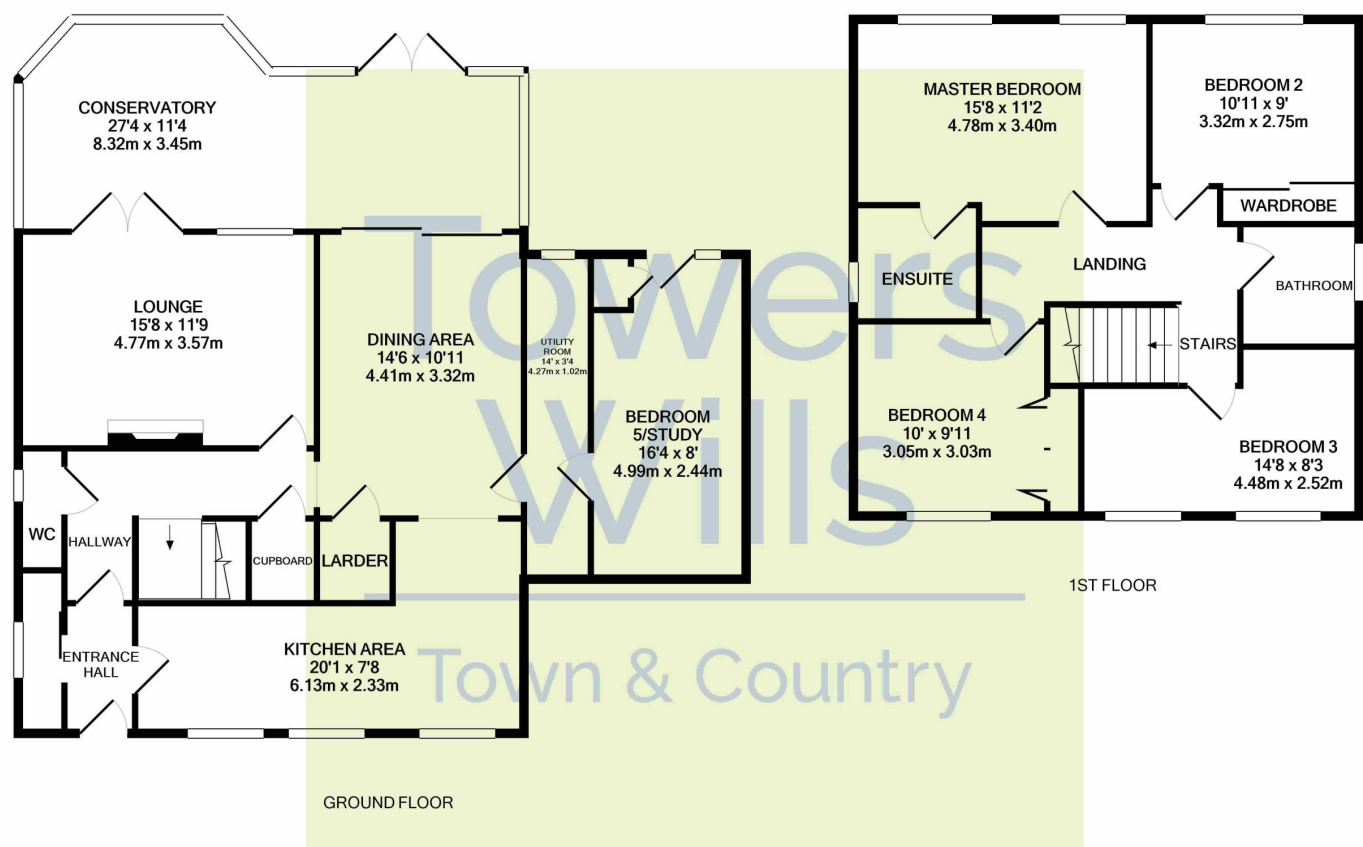

Whilst every attempt has been made to ensure the accuracy of the floor plan contained here, measurements of doors, windows, rooms and any other items are approximate and no responsibility is taken for any error, omission, or mis-statement. This plan is for illustrative purposes only and should be used as such by any prospective purchaser. The services, systems and appliances shown have not been tested and no guarantee as to their operability or efficiency can be given.
Made with Metropix ©2022

Please Note No tests have been undertaken of any of the services and any intending purchasers should satisfy themselves in this regard. Towers Wills Ltd for themselves and for the vendor of this property whose agents they are, give notice that, (i) these particulars do not constitute any part of an offer or contract, (ii) all statements contained within these particulars are made without responsibility on the part of Towers Wills or the vendor, (iii) whilst made in good faith, none of the statements contained within these particulars are to be relied upon as a statement of representation or fact, (iv) any intending purchaser must satisfy him/herself by inspection or otherwise as to the correctness of each of the statements contained within these particulars, (v) the vendor does not make or give either Towers Wills or any person in their employment any authority to make or give representation or warranty whatsoever in relation to this property.

Photographs / Floor Plans Photographs are reproduced for general information and it must not be inferred that any item is included for sale with this property. Please note floor plans are not to scale and are for identification purposes only. The photographs used in these particulars may have been taken with the use of a wide angle lens. If you have any queries as to the size of the accommodation or plot, please address these with the agent prior to making an appointment to view

Towers Wills

The White House, 114 Hendford Hill, Yeovil BA20 2RF

Yeovil 01935 577032 / South Petherton 01460 298530

info@towerswills.co.uk | www.towerswills.co.uk