



84, Nelson Way, Yeovil, Somerset BA21 5DT

OIEO £140,000

Towers Wills are pleased to bring to market this well-presented top-floor apartment, an ideal first time buy or buy to let investment! Selling with no onward chain, the flat comes with allocated parking, two double bedrooms, including master en-suite, bathroom, open plan kitchen/lounge area with integrated appliances and a balcony from which you can enjoy far reaching countryside views.

Entrance Hall

With window to the rear, two cupboards and radiator.

Bedroom One 3.03m x 4.49m – maximum measurements

Double glazed window to the front, radiator and built-in double wardrobe.

En-suite

Suite comprising shower cubicle, wash hand basin, w.c, extractor fan, heated towel rail and shaver point.

Bedroom Two 3.54m x 2.61m – maximum measurements

Double glazed window to the front and radiator.

Bathroom

Suite comprising bath, wash hand basin, w.c, double glazed window to the rear, heated towel rail and shaver point.

Open Plan Kitchen/Lounge Area 4.51m x 5.84m – maximum measurements

Lounge Area

Double glazed patio doors leading to the balcony to the front and two radiators.

Kitchen Area

Comprising of a range of wall, base and drawer units, work surfacing with one bowl stainless steel sink drainer, double glazed window to the rear, central heating boiler, integrated gas hob with cookerhood over, integrated electric oven, integrated dishwasher, integrated fridge and integrated freezer.

Parking

There is one allocated parking space for the property.

Agents Note

The vendor has advised that the most recent fees for the property were:

Maintenance charge: £55 per 6 months

Ground rent: £87.50 per 6 months

Service Charge: Circa £130/month

The property is selling with circa 115 years remaining on the lease.

Key Features

- Well Presented Top Floor Apartment
- Two Bedrooms
- En-suite
- Allocated Parking
- Far Reaching Countryside Views
- No Onward Chain

Contact Us

Towers Wills Estate Agents - Yeovil

114, Hendford Hill

Yeovil

Somerset

BA202RF

T: 01935 577032

E: info@towerswills.co.uk



Floor Plan

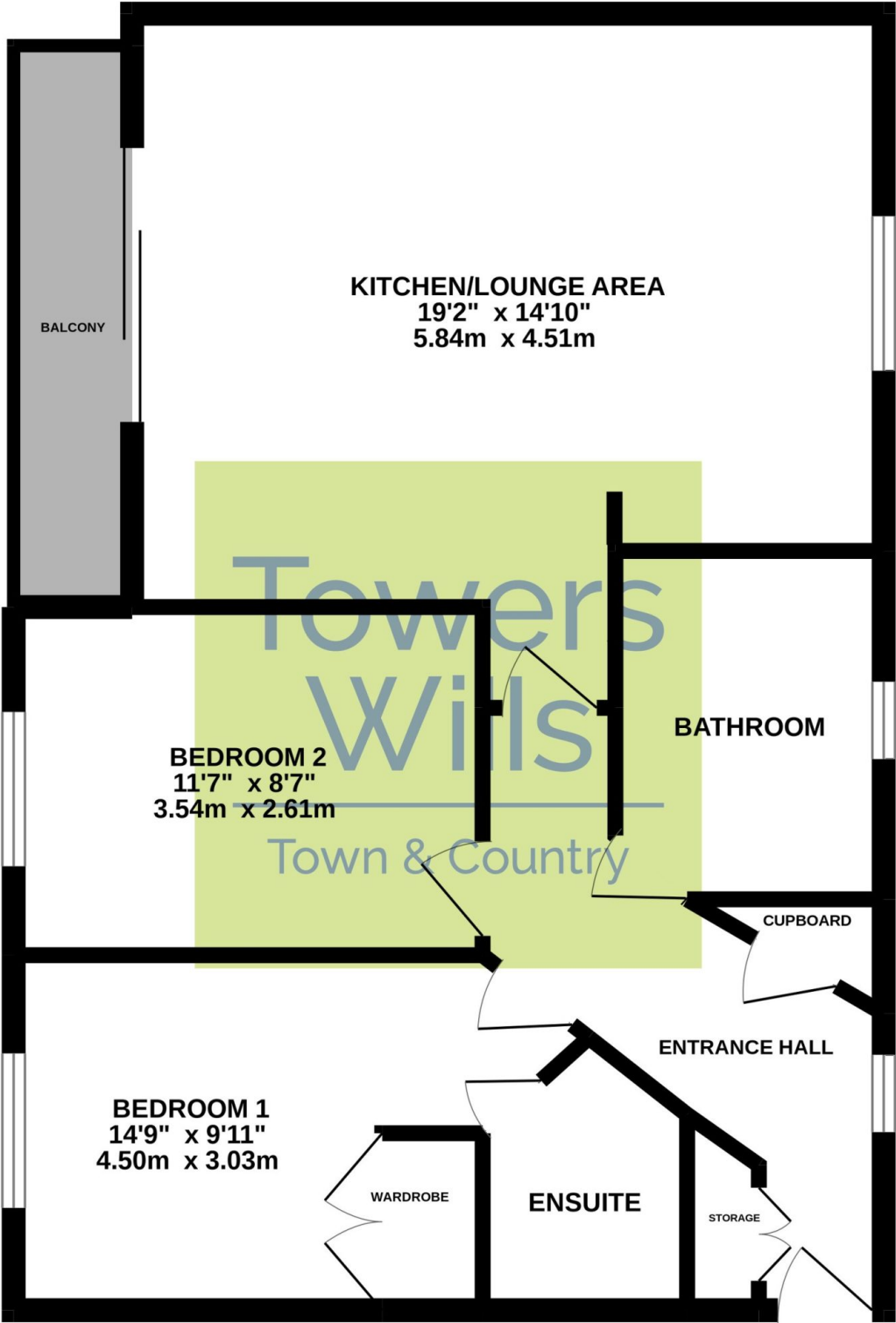

Whilst every attempt has been made to ensure the accuracy of the floorplan contained here, measurements of doors, windows, rooms and any other items are approximate and no responsibility is taken for any error, omission or mis-statement. This plan is for illustrative purposes only and should be used as such by any prospective purchaser. The services, systems and appliances shown have not been tested and no guarantee as to their operability or efficiency can be given.
Made with Metropix ©2022

Please Note No tests have been undertaken of any of the services and any intending purchasers should satisfy themselves in this regard. Towers Wills Ltd for themselves and for the vendor of this property whose agents they are, give notice that, (i) these particulars do not constitute any part of an offer or contract, (ii) all statements contained within these particulars are made without responsibility on the part of Towers Wills or the vendor , (iii) whilst made in good faith, none of the statements contained within these particulars are to be relied upon as a statement of representation or fact , (iv) any intending purchaser must satisfy him/herself by inspection or otherwise as to the correctness of each of the statements contained within these particulars, (v) the vendor does not make or give either Towers Wills or any person in their employment any authority to make or give representation or warranty whatsoever in relation to this property.

Photographs / Floor Plans Photographs are reproduced for general information and it must not be inferred that any item is included for sale with this property. Please note floor plans are not to scale and are for identification purposes only. The photographs used in these particulars may have been taken with the use of a wide angle lens. If you have any queries as to the size of the accommodation or plot, please address these with the agent prior to making an appointment to view

Towers Wills

The White House, 114 Hendford Hill, Yeovil BA20 2RF

Yeovil 01935 577032 / South Petherton 01460 298530

info@towerswills.co.uk | www.towerswills.co.uk