

Towers Wills

Town & Country

📞 01935 577 032 | 01460 298 530 | ✉ info@towerswills.co.uk



37, Greenwood Road, Yeovil, Somerset BA21 3LF

OIEO £240,000

Towers Wills welcome to the market this well presented three bedroom semi-detached family home situated in a popular residential location and briefly comprising: reception hallway, living room, kitchen diner, three bedrooms, bathroom, front and rear gardens and garage.

Reception Hallway

Door to the front and radiator.

Living Room

A spacious family living area with window to the front, gas fire, radiator and under stairs storage cupboard.

Kitchen Diner

A well presented fitted kitchen comprising of a range of glass wall, base and drawer units, work surfacing with inset stainless steel sink/drain, integrated double electric oven, integrated electric hob with cookerhood over, integrated fridge, two integrated freezers, LED plinth lighting, integrated dishwasher, window to the rear, tiled flooring and being open plan to the dining area.

Dining Area

With radiator, patio doors opening to the rear and continuation of wall units.

First Floor Landing

Stairs from reception hallway, window to the side, airing cupboard and loft access.

Bedroom One

With window to the front and radiator.

Bedroom Two

With window to the rear and radiator.

Bedroom Three

With window to the front, over stairs storage cupboard and radiator.

Bathroom

A well presented suite comprising of bath with shower over, twin wash hand basins with vanity units under, w.c, window to the rear, tiling and heated towel rail.

Outside

To the front of the property the garden has been laid to lawn. To the rear of the property is a low maintenance garden laid to patio with gated side access, outside light and tap.

Garage 6.24m x 3.36m

A larger than average garage with 'up and over' door, power, light and personal door to the garden.

Local Authority

South Somerset District Council

Council Tax - Band C

Key Features

- Well Presented
- Semi-Detached House
- Three Bedrooms
- Front & Rear Gardens
- Garage

Contact Us

Towers Wills Estate Agents - Yeovil

114, Hendford Hill
Yeovil

Somerset
BA202RF

T: 01935 577032

E: info@towerswills.co.uk

Energy Efficiency

Score	Energy rating	Current	Potential
92+	A		
81-91	B		
69-80	C		79 C
55-68	D	65 D	
39-54	E		
21-38	F		
1-20	G		



Floor Plan

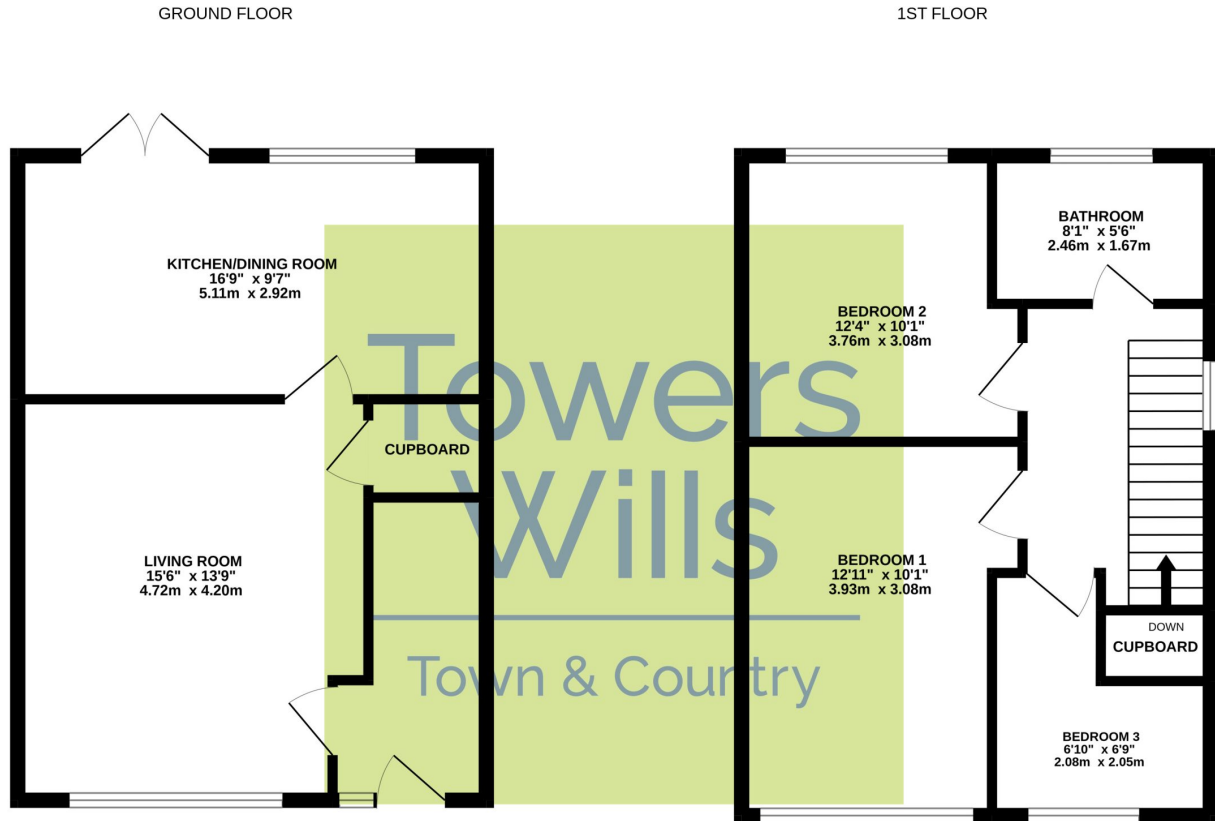

Whilst every attempt has been made to ensure the accuracy of the floorplan contained here, measurements of doors, windows, rooms and any other items are approximate and no responsibility is taken for any error, omission or mis-statement. This plan is for illustrative purposes only and should be used as such by any prospective purchaser. The services, systems and appliances shown have not been tested and no guarantee as to their operability or efficiency can be given.
Made with Metropix ©2022

Please Note No tests have been undertaken of any of the services and any intending purchasers should satisfy themselves in this regard. Towers Wills Ltd for themselves and for the vendor of this property whose agents they are, give notice that, (i) these particulars do not constitute any part of an offer or contract, (ii) all statements contained within these particulars are made without responsibility on the part of Towers Wills or the vendor, (iii) whilst made in good faith, none of the statements contained within these particulars are to be relied upon as a statement of representation or fact, (iv) any intending purchaser must satisfy him/herself by inspection or otherwise as to the correctness of each of the statements contained within these particulars, (v) the vendor does not make or give either Towers Wills or any person in their employment any authority to make or give representation or warranty whatsoever in relation to this property.

Photographs / Floor Plans Photographs are reproduced for general information and it must not be inferred that any item is included for sale with this property. Please note floor plans are not to scale and are for identification purposes only. The photographs used in these particulars may have been taken with the use of a wide angle lens. If you have any queries as to the size of the accommodation or plot, please address these with the agent prior to making an appointment to view

Towers Wills

The White House, 114 Hendford Hill, Yeovil BA20 2RF

Yeovil 01935 577032 / South Petherton 01460 298530

info@towerswills.co.uk | www.towerswills.co.uk