

Towers Wills

Town & Country

📞 01935 577 032 | 01460 298 530 | ✉ info@towerswills.co.uk



1, Rope Walk, Martock, Somerset TA12 6HZ

Offers Over £260,000

Towers Wills are delighted to market this semi-detached property in this popular village, situated in a quiet location. Early viewing comes highly recommended, the property briefly comprises of; hall, w.c, kitchen, lounge/diner, conservatory, three bedrooms, shower room, low maintenance rear garden, parking and garage. No onward chain.

Part glazed entrance door leading into the:

Hall

With storage cupboard, stairs to first floor landing and radiator.

W.C 0.84m x 1.90m

With w.c, wash hand basin with vanity unit, radiator and window with outlook to the front.

Kitchen 2.81m x 3.41m

Fitted with timber effect work tops and cream doors with a range of wall and base units, a sink drainer unit with mixer tap, space for freestanding electric cooker, space for fridge freezer, plumbing for washing machine, central heating boiler and window with outlook to the front.

Lounge Diner 4.34m x 4.84m

A good size lounge diner with cupboard under the stairs, sliding doors leading into the conservatory, two radiators, TV and telephone points.

Conservatory 2.50m x 2.66m

With door leading out to the rear garden.

First Floor Landing

With hatch to roof space and cupboard over the stairs.

Bedroom One 2.69m x 4.16m

With two windows out to the front, radiator, cupboard and further double built-in wardrobe.

Bedroom Two 2.69m x 3.43m

With window outlook to the rear and radiator.

Bedroom Three 2.08m x 2.58m

With window outlook to the rear and radiator.

Shower Room 1.55m x 2.70m

With large walk-in shower, w.c, pedestal hand basin, window with outlook to the side and radiator.

Rear Garden

The rear garden is mostly laid to lawn with shed, outside water tap, side access and is enclosed by part walling and fencing.

Parking

A short walk from the property is a driveway and garage.

Key Features

- Semi-detached
- Three Bedrooms
- Desirable Village Location
- Off Road Parking
- Garage
- No Onward Chain
- Priced for Immediate Interest
- Early Viewing Advised

Contact Us

Towers Wills Estate Agents - Yeovil

114, Hendford Hill
Yeovil

Somerset
BA202RF

T: 01935 577032

E: info@towerswills.co.uk



Floor Plan

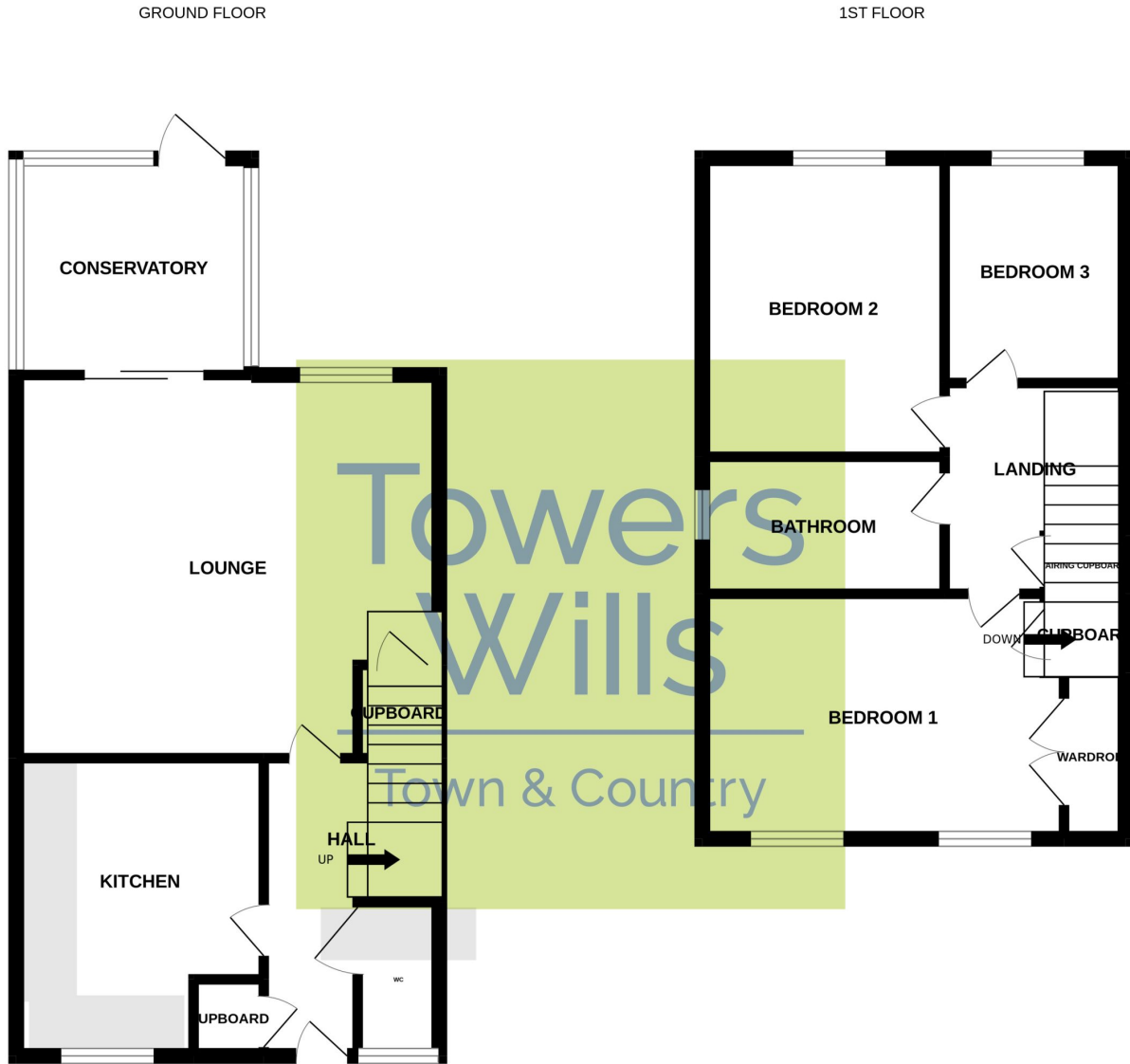

Whilst every attempt has been made to ensure the accuracy of the floorplan contained here, measurements of doors, windows, rooms and any other items are approximate and no responsibility is taken for any error, omission or mis-statement. This plan is for illustrative purposes only and should be used as such by any prospective purchaser. The services, systems and appliances shown have not been tested and no guarantee as to their operability or efficiency can be given.
Made with Metropix ©2022

Please Note No tests have been undertaken of any of the services and any intending purchasers should satisfy themselves in this regard. Towers Wills Ltd for themselves and for the vendor of this property whose agents they are, give notice that, (i) these particulars do not constitute any part of an offer or contract, (ii) all statements contained within these particulars are made without responsibility on the part of Towers Wills or the vendor, (iii) whilst made in good faith, none of the statements contained within these particulars are to be relied upon as a statement of representation or fact, (iv) any intending purchaser must satisfy him/herself by inspection or otherwise as to the correctness of each of the statements contained within these particulars, (v) the vendor does not make or give either Towers Wills or any person in their employment any authority to make or give representation or warranty whatsoever in relation to this property.

Photographs / Floor Plans Photographs are reproduced for general information and it must not be inferred that any item is included for sale with this property. Please note floor plans are not to scale and are for identification purposes only. The photographs used in these particulars may have been taken with the use of a wide angle lens. If you have any queries as to the size of the accommodation or plot, please address these with the agent prior to making an appointment to view

Towers Wills

The White House, 114 Hendford Hill, Yeovil BA20 2RF

Yeovil 01935 577032 / South Petherton 01460 298530

info@towerswills.co.uk | www.towerswills.co.uk