

Towers Wills

Town & Country

📞 01935 577 032 | 01460 298 530 | ✉ info@towerswills.co.uk



20, The Green, Stoford, Yeovil, Somerset BA22 9UD

Offers Over £270,000

Towers Wills welcome to the market this three bedroom detached property, situated in the heart of this popular village with pleasant outlook across the village green. The property comprises: entrance, kitchen, living room, dining room, two bedrooms, bedroom three/nursery, bathroom, front and rear gardens and off road parking for two vehicles.

Entrance

Stable door to the front.

Kitchen 3.30m x 2.90m

Fitted with a range of wall, base and drawer units, work surfacing with inset one and a half bowl stainless steel sink/drainer, space for Range cooker, electric hob with cookerhood over, space for fridge/freezer, plumbing for washing machine, plumbing for dishwasher, radiator, window to the front and window to the side.

Dining Room 3.30m x 4.10m

With flagstone floors, under stairs storage cupboard, radiator, window to the side and central heating boiler.

Living Room 3.37m x 3.56m

With window and double doors opening out to the rear garden, radiator and window to the side.

First Floor Landing

Stairs from dining room, window to the side and loft access.

Bedroom One 3.38m x 3.57m

Window to the rear, radiator and wall lights.

Bedroom Two 3.31m x 2.92m

Windows to the front and side, radiator and wall lights.

Bedroom Three/Nursery 2.42m x 1.83m

Window to the side and radiator.

Bathroom 2.34m x 2.09m

Comprising of corner bath, wash hand basin, wc, separate shower cubicle, part tiled, radiator and window to the side.

Outside

Rear Garden

A mature cottage garden being majority laid to lawn with patio area, hedgerow borders and side gate.

Key Features

- Overlooking pretty village green
- Three bedrooms
- Detached
- Off Road Parking for Two Vehicles
- Character home

Contact Us

Towers Wills Estate Agents - Yeovil

114, Hendford Hill
Yeovil

Somerset

BA202RF

T: 01935 577032

E: info@towerswills.co.uk

Energy Efficiency

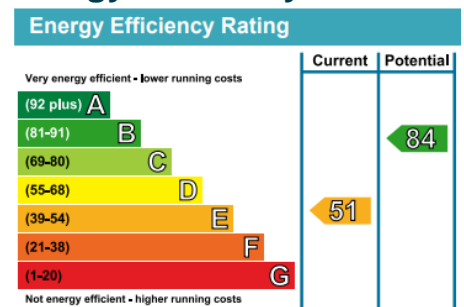



Floor Plan

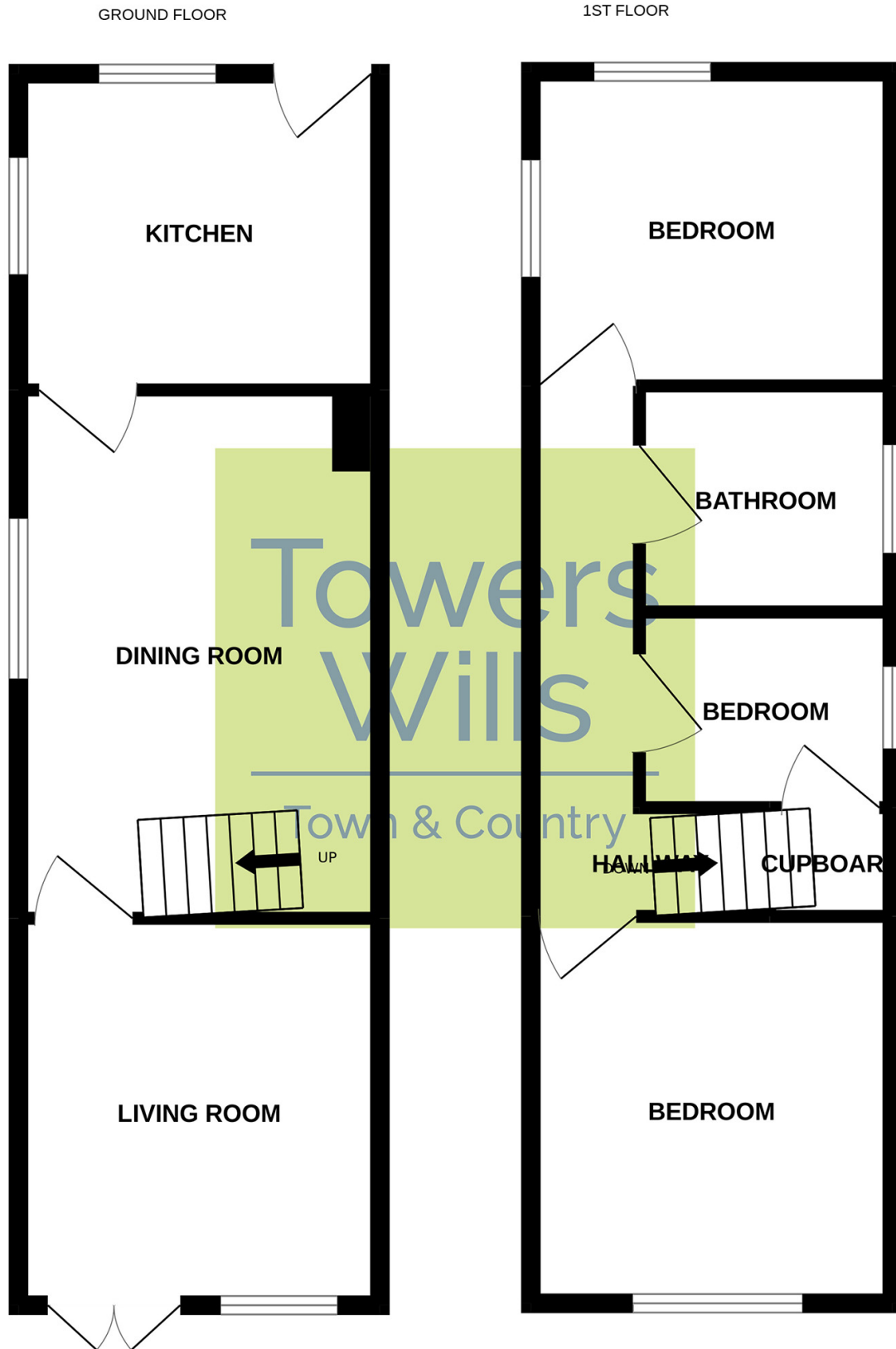

Whilst every attempt has been made to ensure the accuracy of the floorplan contained here, measurements of doors, windows, rooms and any other items are approximate and no responsibility is taken for any error, omission or mis-statement. This plan is for illustrative purposes only and should be used as such by any prospective purchaser. The services, systems and appliances shown have not been tested and no guarantee as to their operability or efficiency can be given.
Made with Metropix ©2022

Please Note No tests have been undertaken of any of the services and any intending purchasers should satisfy themselves in this regard. Towers Wills Ltd for themselves and for the vendor of this property whose agents they are, give notice that, (i) these particulars do not constitute any part of an offer or contract, (ii) all statements contained within these particulars are made without responsibility on the part of Towers Wills or the vendor, (iii) whilst made in good faith, none of the statements contained within these particulars are to be relied upon as a statement of representation or fact, (iv) any intending purchaser must satisfy him/herself by inspection or otherwise as to the correctness of each of the statements contained within these particulars, (v) the vendor does not make or give either Towers Wills or any person in their employment any authority to make or give representation or warranty whatsoever in relation to this property.

Photographs / Floor Plans Photographs are reproduced for general information and it must not be inferred that any item is included for sale with this property. Please note floor plans are not to scale and are for identification purposes only. The photographs used in these particulars may have been taken with the use of a wide angle lens. If you have any queries as to the size of the accommodation or plot, please address these with the agent prior to making an appointment to view

Towers Wills

The White House, 114 Hendford Hill, Yeovil BA20 2RF

Yeovil 01935 577032 / South Petherton 01460 298530

info@towerswills.co.uk | www.towerswills.co.uk