

Towers Wills

Town & Country

📞 01935 577 032 | 01460 298 530 | ✉ info@towerswills.co.uk



4, Somerville Close, Yeovil, Somerset BA21 5FU

OIEO £170,000

Towers Wills are pleased to welcome to the market this two bedroom coach house with garage and allocated parking. The property is perfect for buy to let investment or first time buyer and is still in immaculate condition throughout. The property was built in 2017 and still benefits from remaining years of NHSBC guarantee. The property briefly comprises of living room/diner, kitchen, two bedrooms, family bathroom, garage and allocated parking.

Entrance Hallway

With stairs rising to the first floor accommodation.

Landing

With two storage cupboards, skylight creating a wealth of light and access to all the accommodation.

Master Bedroom

Of double proportions with double glazed windows to the front, radiator and space for storage.

Bedroom Two

With double glazed windows to the front and over stairs storage cupboard.

Bathroom

Suite comprising bath with shower over, wash hand basin, w.c, radiator and skylight.

Living/Dining Room

Living Area

With two double glazed windows to the front and radiator.

Dining Area

Space for six-seater dining table and access into the kitchen.

Kitchen

Comprising of a range of wall, base and drawer units, work surfacing with stainless steel sink drainer, built-in appliances including: fridge freezer, dishwasher and washing machine, integrated Zanussi oven, four ring gas hob with extractor over, cupboard storing the Logic gas combination boiler. To one side of the kitchen is a newly built breakfast bar area.

Outside

Driveway

There is driveway parking for one car on the drive and one car in the garage.

Garage 5.47m x 2.59m

With 'up and over' door, power, light and storage cupboard under the stairs.

Key Features

- Coach House – Freehold
- Two Bedrooms
- Garage
- Parking
- Beautifully Presented Throughout
- Ideal First Time Buy / Buy to Let

Contact Us

Towers Wills Estate Agents - Yeovil

114, Hendford Hill

Yeovil

Somerset

BA202RF

T: 01935 577032

E: info@towerswills.co.uk

Energy Efficiency

Score	Energy rating	Current	Potential
92+	A		92 A
81-91	B		
69-80	C	79 c	
55-68	D		
39-54	E		
21-38	F		
1-20	G		



Floor Plan

GROUND FLOOR

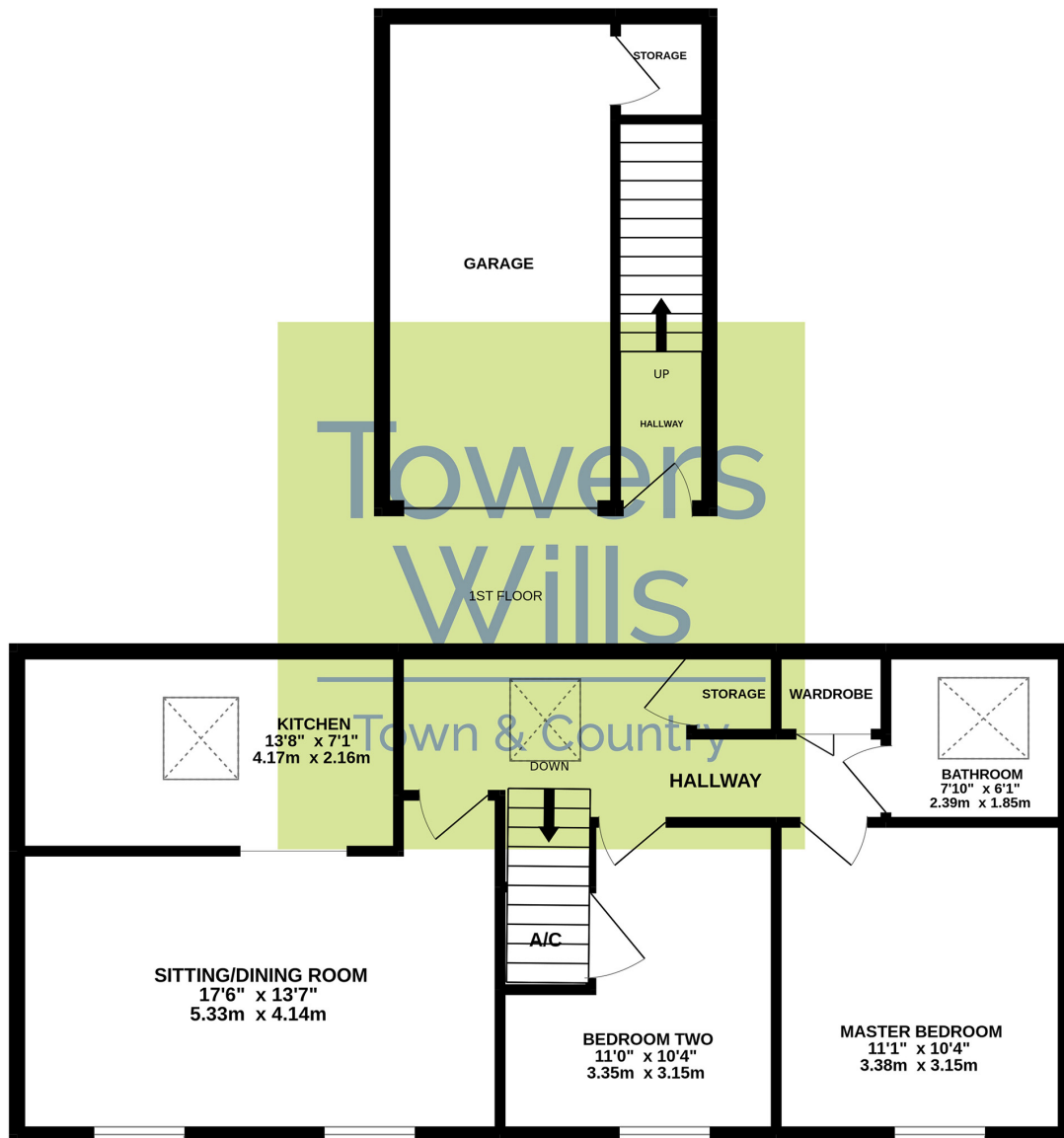

Whilst every attempt has been made to ensure the accuracy of the floorplan contained here, measurements of doors, windows, rooms and any other items are approximate and no responsibility is taken for any error, omission or mis-statement. This plan is for illustrative purposes only and should be used as such by any prospective purchaser. The services, systems and appliances shown have not been tested and no guarantee as to their operability or efficiency can be given.
Made with Metropix ©2022

Please Note No tests have been undertaken of any of the services and any intending purchasers should satisfy themselves in this regard. Towers Wills Ltd for themselves and for the vendor of this property whose agents they are, give notice that, (i) these particulars do not constitute any part of an offer or contract, (ii) all statements contained within these particulars are made without responsibility on the part of Towers Wills or the vendor, (iii) whilst made in good faith, none of the statements contained within these particulars are to be relied upon as a statement of representation or fact, (iv) any intending purchaser must satisfy him/herself by inspection or otherwise as to the correctness of each of the statements contained within these particulars, (v) the vendor does not make or give either Towers Wills or any person in their employment any authority to make or give representation or warranty whatsoever in relation to this property.

Photographs / Floor Plans Photographs are reproduced for general information and it must not be inferred that any item is included for sale with this property. Please note floor plans are not to scale and are for identification purposes only. The photographs used in these particulars may have been taken with the use of a wide angle lens. If you have any queries as to the size of the accommodation or plot, please address these with the agent prior to making an appointment to view

Towers Wills

The White House, 114 Hendford Hill, Yeovil BA20 2RF

Yeovil 01935 577032 / South Petherton 01460 298530

info@towerswills.co.uk | www.towerswills.co.uk