

# Towers Wills

Town & Country

📞 01935 577 032 | 01460 298 530 | ✉ info@towerswills.co.uk



**131, Westfield Grove, Yeovil, Somerset BA21 3DW**

**Offers Over £170,000**

Towers Wills welcome to the market this well presented three bedroom mid terrace property situated in a quiet position, within easy reach of local schools and amenities. The property briefly comprises; hallway, living room, kitchen, cloak w.c, three bedrooms, re-fitted bathroom, driveway and enclosed rear garden.

## Reception Hallway

Door to the front.

## Living Room

With window to the front, open fireplace and radiator.

## Kitchen

A well presented kitchen comprising of a range of wall, base and drawer units, work surfacing with inset stainless steel sink/drainers, plumbing for washing machine, space for fridge/freezer, gas cooker point, cookerhood, tiling to splash prone areas and two windows to the rear.

## Inner Hallway

With under stairs storage cupboard, radiator and door to the rear garden.

## Cloak W.C

Comprising wash hand basin, w.c, fully tiled and window to the rear.

## First Floor Landing

Stairs from reception hallway with loft access.

## Bedroom One

With window to the rear and radiator.

## Bedroom Two

With window to the front and radiator.

## Bedroom Three

With window to the front, over stairs storage cupboard and radiator.

## Loft Room

Accessed via pull-down ladder with two velux skylights, power and light.

## Bathroom

A beautifully re-fitted modern suite comprising of wash hand basin with vanity unit under, w.c, bath, separate shower cubicle, heated towel rail, fully tiled and window to the rear.

## Outside

To the front of the property is a driveway providing off road parking for two vehicles.

## Rear Garden

To the rear of the property is an enclosed garden being majority laid to lawn with patio area.

## Agents Note

There is a right of way across the rear garden for neighbouring properties.

## Key Features

- Mid Terrace
- Three Bedrooms
- Re-fitted Bathroom
- Driveway
- Enclosed Rear Garden

## Contact Us

### Towers Wills Estate Agents - Yeovil

114, Hendford Hill

Yeovil

Somerset

BA202RF

T: 01935 577032

E: [info@towerswills.co.uk](mailto:info@towerswills.co.uk)

## Energy Efficiency

Score	Energy rating	Current	Potential
92+	A		
81-91	B		83   B
69-80	C		
55-68	D	63   D	
39-54	E		
21-38	F		
1-20	G		



# Floor Plan

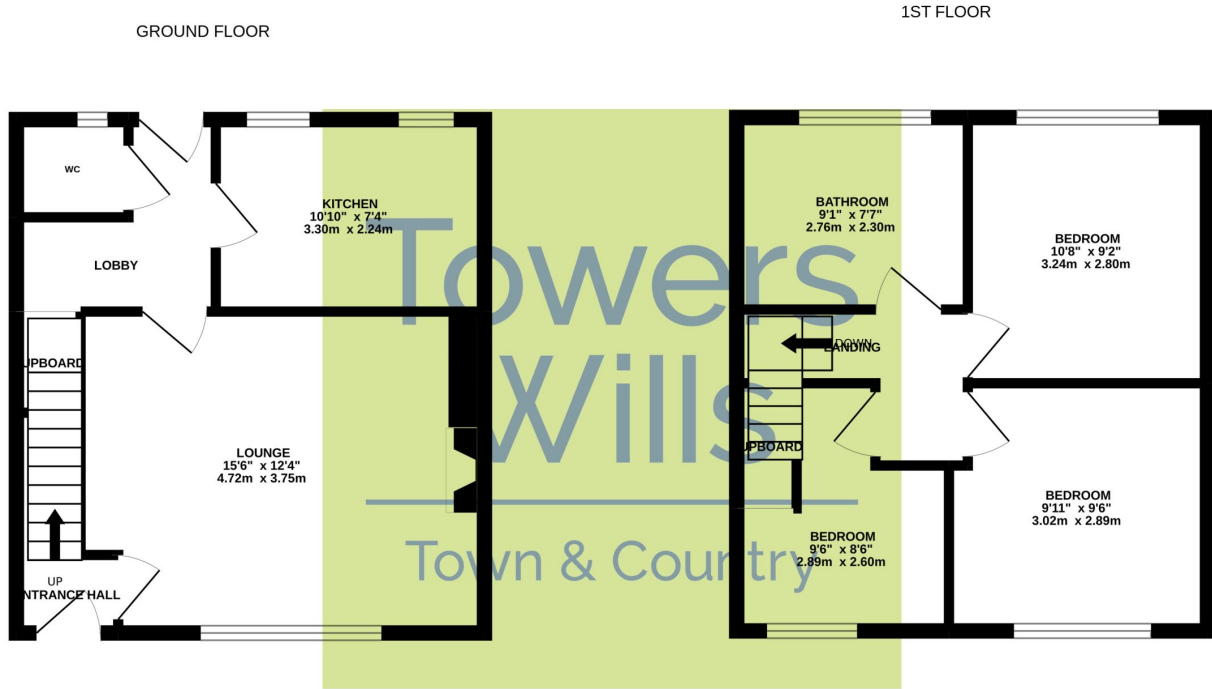

Whilst every attempt has been made to ensure the accuracy of the floorplan contained here, measurements of doors, windows, rooms and any other items are approximate and no responsibility is taken for any error, omission or mis-statement. This plan is for illustrative purposes only and should be used as such by any prospective purchaser. The services, systems and appliances shown have not been tested and no guarantee as to their operability or efficiency can be given.  
Made with Metropix ©2022

Please Note No tests have been undertaken of any of the services and any intending purchasers should satisfy themselves in this regard. Towers Wills Ltd for themselves and for the vendor of this property whose agents they are, give notice that, (i) these particulars do not constitute any part of an offer or contract, (ii) all statements contained within these particulars are made without responsibility on the part of Towers Wills or the vendor, (iii) whilst made in good faith, none of the statements contained within these particulars are to be relied upon as a statement of representation or fact, (iv) any intending purchaser must satisfy him/herself by inspection or otherwise as to the correctness of each of the statements contained within these particulars, (v) the vendor does not make or give either Towers Wills or any person in their employment any authority to make or give representation or warranty whatsoever in relation to this property.

Photographs / Floor Plans Photographs are reproduced for general information and it must not be inferred that any item is included for sale with this property. Please note floor plans are not to scale and are for identification purposes only. The photographs used in these particulars may have been taken with the use of a wide angle lens. If you have any queries as to the size of the accommodation or plot, please address these with the agent prior to making an appointment to view

**Towers Wills**

The White House, 114 Hendford Hill, Yeovil BA20 2RF

Yeovil 01935 577032 / South Petherton 01460 298530

[info@towerswills.co.uk](mailto:info@towerswills.co.uk) | [www.towerswills.co.uk](http://www.towerswills.co.uk)