

Towers Wills

Town & Country

📞 01935 577 032 | 01460 298 530 | ✉ info@towerswills.co.uk



42, Gainsborough Way, Yeovil, Somerset BA21 5XT

Offers Over £175,000

Towers Wills are pleased to welcome to market this well-presented two-bedroom end terraced property, located in a quiet residential cul de sac location, and within close proximity to local shops/amenities. The house briefly comprises of entrance porch, spacious living room, kitchen/diner, two double bedrooms and a family bathroom. Outside there is a driveway providing off road parking, further parking to the side and garden with side access. Perfect for First Time Buyer or Investment.

ENTRANCE PORCH

White double-glazed front door leading into a small entrance porch with storage cupboard, door leading into sitting room.

SITTING ROOM (3.84m x 4.82m)

Double glazed window to the front, feature spiral staircase leading to the first floor, electric fireplace and door to kitchen. Please note, there is a gas supply which is capped off should a future owner wish to install a gas fire.

KITCHEN (3.85m x 2.42m)

A range of fitted wall, base and drawer units with work surface over and complementary tiled surround, one and half bowl sink and drainer with mixer tap. Space for free standing cooker, washing machine, tumble dryer and fridge/freezer, double glazed window onto the rear and double glazed door leading to garden.

LANDING

Wall mounted electric heater.

BEDROOM ONE (2.52m x 3.84m)

Double bedroom with front aspect double glazed window and sliding bedroom door.

BEDROOM TWO (3.85m x 2.27m)

Double bedroom with rear aspect double glazed window, airing cupboard and sliding bedroom door.

BATHROOM

Family bathroom with white suite of bath, WC and basin, shower over bath, extractor fan and shaving point.

OUTSIDE

To the rear of the house is a low-maintenance garden with patio area, mature shrubs and borders, side access leading to the front of the property. The property also benefits from driveway parking at the front and additional parking to the side.

AGENTS NOTE

The vendor advises that there is a gas supply to the property.

Key Features

- End of Terrace
- Two Double Bedrooms
- Driveway & Additional Parking
- Garden
- First Time Buyer or Investment Opportunity

Contact Us

Towers Wills Estate Agents - Yeovil

114, Hendford Hill
Yeovil

Somerset
BA202RF

T: 01935 577032

E: info@towerswills.co.uk

Energy Efficiency

Score	Energy rating	Current	Potential
92+	A		
81-91	B		90 B
69-80	C		
55-68	D		
39-54	E	42 E	
21-38	F		
1-20	G		

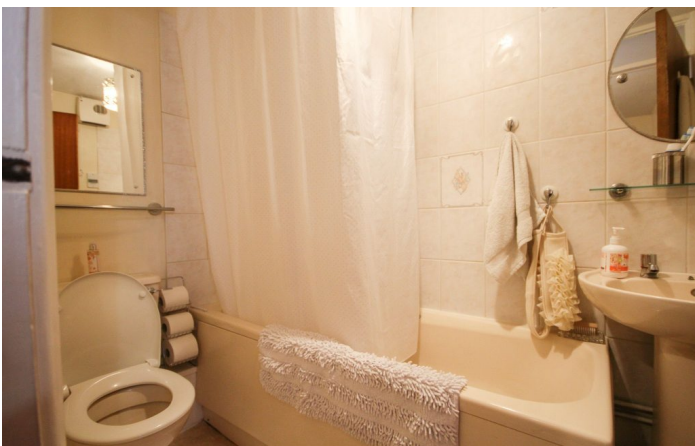

Floor Plan

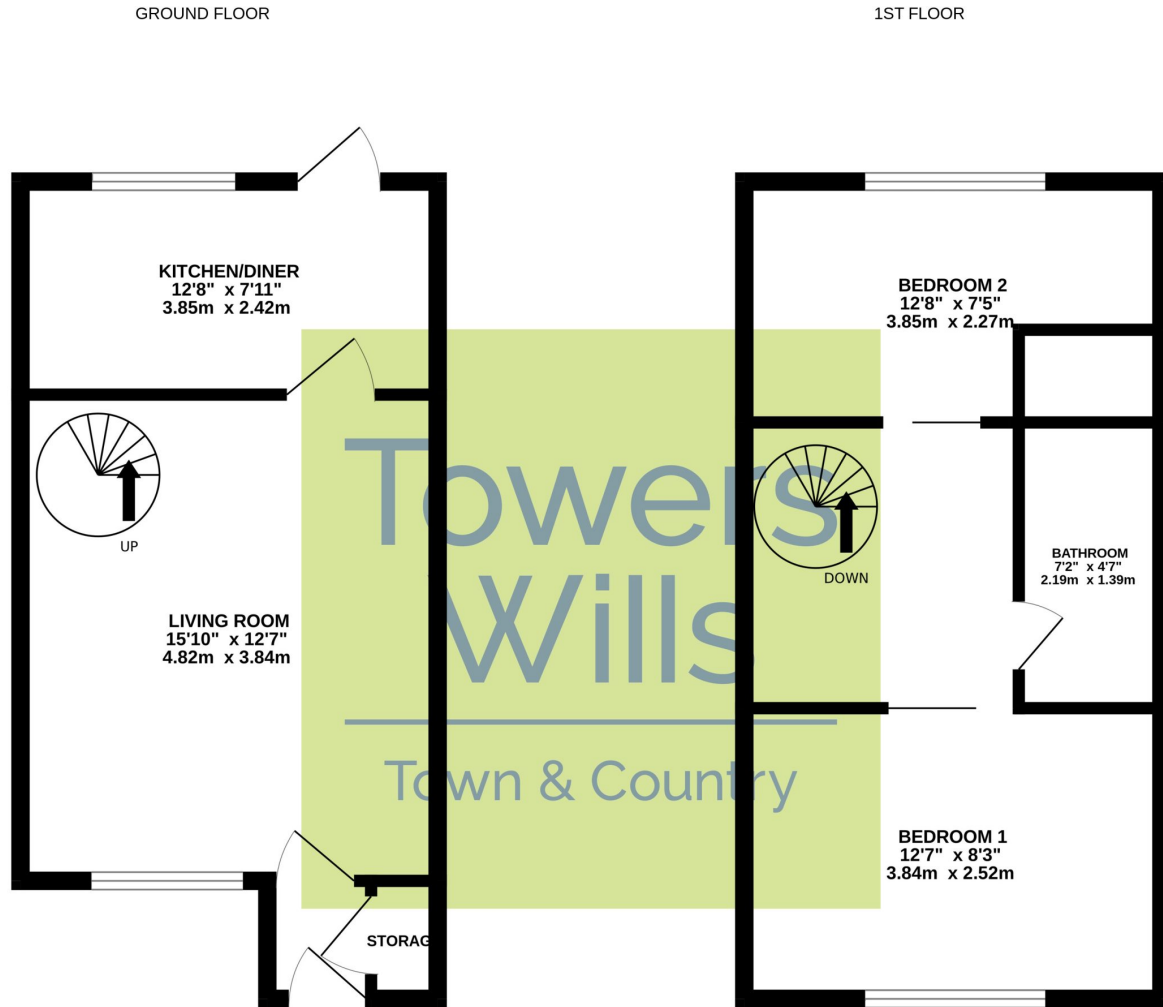

Whilst every attempt has been made to ensure the accuracy of the floorplan contained here, measurements of doors, windows, rooms and any other items are approximate and no responsibility is taken for any error, omission or mis-statement. This plan is for illustrative purposes only and should be used as such by any prospective purchaser. The services, systems and appliances shown have not been tested and no guarantee as to their operability or efficiency can be given.
Made with Metropix ©2023

Please Note No tests have been undertaken of any of the services and any intending purchasers should satisfy themselves in this regard. Towers Wills Ltd for themselves and for the vendor of this property whose agents they are, give notice that, (i) these particulars do not constitute any part of an offer or contract, (ii) all statements contained within these particulars are made without responsibility on the part of Towers Wills or the vendor, (iii) whilst made in good faith, none of the statements contained within these particulars are to be relied upon as a statement of representation or fact, (iv) any intending purchaser must satisfy him/herself by inspection or otherwise as to the correctness of each of the statements contained within these particulars, (v) the vendor does not make or give either Towers Wills or any person in their employment any authority to make or give representation or warranty whatsoever in relation to this property.

Photographs / Floor Plans Photographs are reproduced for general information and it must not be inferred that any item is included for sale with this property. Please note floor plans are not to scale and are for identification purposes only. The photographs used in these particulars may have been taken with the use of a wide angle lens. If you have any queries as to the size of the accommodation or plot, please address these with the agent prior to making an appointment to view

Towers Wills

The White House, 114 Hendford Hill, Yeovil BA20 2RF

Yeovil 01935 577032 / South Petherton 01460 298530

info@towerswills.co.uk | www.towerswills.co.uk