

Towers Wills

Town & Country

📞 01935 577 032 | 01460 298 530 | ✉ info@towerswills.co.uk



14, Sunningdale Road, Yeovil, Somerset BA21 5LZ

OIEO £190,000

Towers Wills welcome to the market this spacious three bedroom property situated within easy reach of local shops, schools and amenities. The property would benefit from some modernisation but comes to the market in good condition and briefly comprising; reception hallway, lounge/diner, kitchen/breakfast room, utility room, conservatory, three bedrooms, bathroom, front and rear gardens.

Reception Hallway

Double glazed door to the front and staircase to the first floor landing.

Lounge/Diner

A spacious living area with window to the front, window to the rear, tiled fireplace and electric radiator.

Kitchen/Breakfast Room

Comprising of a range of wall, base and drawer units, work surfacing with inset stainless steel sink/drainage, space for cooker, electric cooker point, electric radiator, space for table and chair set, window to the front and door to utility room.

Utility Room

With wall, base and drawer units, work surfacing, space for tumble dryer, space for fridge/freezer, window to the rear and door to conservatory.

Conservatory

With pleasant outlook onto the rear garden and double glazed doors opening onto the patio area.

First Floor Landing

Stairs from reception hallway, loft access, window to the rear and electric radiator.

Bedroom One

With window to the front and electric radiator.

Bedroom Two

With window to the front, electric radiator, built-in wardrobes and airing cupboard.

Bedroom Three

With window to the rear.

Bathroom

Suite comprising of bath with shower over, wash hand basin, Dimplex wall mounted heater, window to the rear and wall tiling.

Separate W.C

With window to the rear and w.c.

Outside

To the front of the property is an area of front garden whilst to the rear of the property is an enclosed garden with side access, majority laid to patio with shrub borders and garden shed.

Key Features

- Spacious Property
- Three Bedrooms
- Conservatory
- Front & Rear Gardens

Contact Us

Towers Wills Estate Agents - Yeovil

114, Hendford Hill

Yeovil

Somerset

BA202RF

T: 01935 577032

E: info@towerswills.co.uk



Floor Plan

GROUND FLOOR

1ST FLOOR

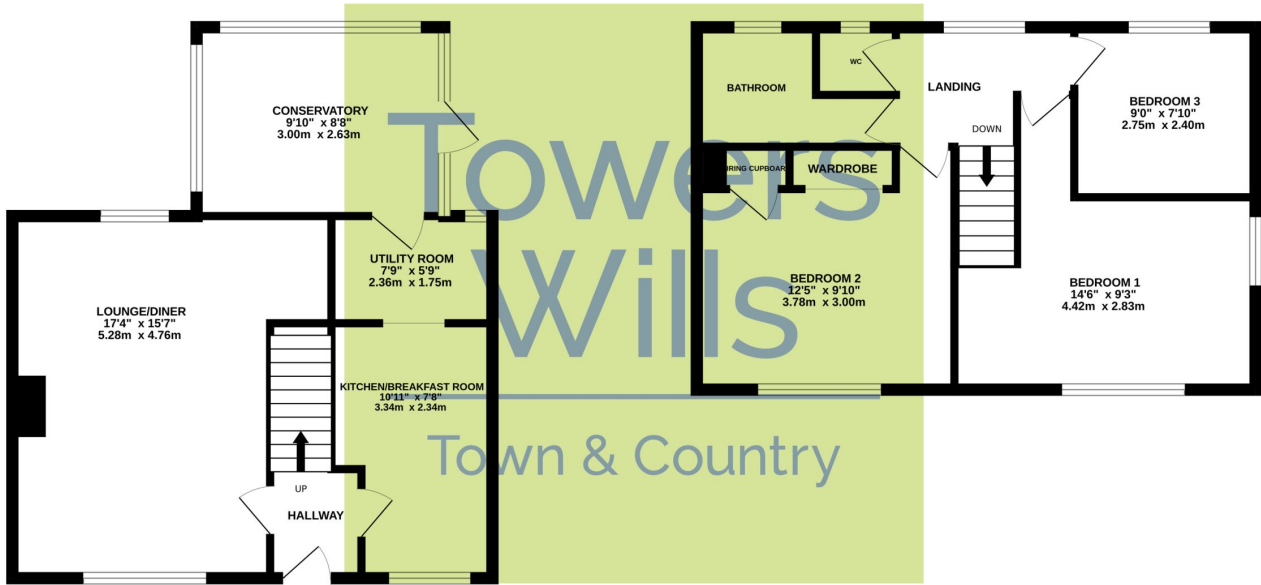

Whilst every attempt has been made to ensure the accuracy of the floorplan contained here, measurements of doors, windows, rooms and any other items are approximate and no responsibility is taken for any error, omission or mis-statement. This plan is for illustrative purposes only and should be used as such by any prospective purchaser. The services, systems and appliances shown have not been tested and no guarantee as to their operability or efficiency can be given.
Made with Metropix ©2023

Please Note No tests have been undertaken of any of the services and any intending purchasers should satisfy themselves in this regard. Towers Wills Ltd for themselves and for the vendor of this property whose agents they are, give notice that, (i) these particulars do not constitute any part of an offer or contract, (ii) all statements contained within these particulars are made without responsibility on the part of Towers Wills or the vendor, (iii) whilst made in good faith, none of the statements contained within these particulars are to be relied upon as a statement of representation or fact, (iv) any intending purchaser must satisfy him/herself by inspection or otherwise as to the correctness of each of the statements contained within these particulars, (v) the vendor does not make or give either Towers Wills or any person in their employment any authority to make or give representation or warranty whatsoever in relation to this property.

Photographs / Floor Plans Photographs are reproduced for general information and it must not be inferred that any item is included for sale with this property. Please note floor plans are not to scale and are for identification purposes only. The photographs used in these particulars may have been taken with the use of a wide angle lens. If you have any queries as to the size of the accommodation or plot, please address these with the agent prior to making an appointment to view

Towers Wills

The White House, 114 Hendford Hill, Yeovil BA20 2RF

Yeovil 01935 577032 / South Petherton 01460 298530

info@towerswills.co.uk | www.towerswills.co.uk