

Towers Wills

Town & Country

📞 01935 577 032 | 01460 298 530 | ✉ info@towerswills.co.uk



13, Marwin Close, Martock, Somerset TA12 6HJ

Offers Over £170,000

Towers Wills welcome to the market this terraced property in a popular village location. Priced for immediate interest and briefly comprises, hall, lounge/diner, kitchen, two good size bedrooms, bathroom, low maintenance rear garden and benefits from a garage in a block.

Door leading into the porch area and further UPVC part glazed entrance leading into the hall.

Hall

With stairs to first floor landing.

Lounge 3.65m x 4.25m maximum measurements

Window with outlook to the front, radiator, TV point and under stairs storage cupboard.

Dining Room 2.44m x 2,75m

Open plan to the lounge, radiator, window and door leading out to the rear.

Kitchen 2.08m x 2.59m

Fitted with patterned worktops, timber effect doors with a range of wall and base units. A stainless steel sink drainer unit with mixer tap, space for a freestanding gas cooker, plumbing for washing machine, space for fridge /freezer, tiled floor, part tiled walls and window with outlook to the rear.

Landing

With hatch to roof space and cupboard housing the combination boiler.

Bedroom One 3.13m x 3.72m plus recess for wardrobe

With window outlook to the front, radiator, cupboard and recess space for a further wardrobe if required.

Bedroom Two 2.84m x 3.20m

With window outlook to the rear, radiator and cupboard.

Bathroom 1.67m x 2.15m

Fitted with a panelled bath, mixer tap and shower attachment, pedestal hand basin, low level WC, radiator, part tiled walls and window with outlook to the rear.

Garden s

To the front there is a lawned area, whilst to the rear, the garden is low maintenance with gate leading out to the rear.

Garage

A short walk form the property the garage is in a block with up and over door.

Key Features

- Terrace
- Two bedrooms
- Popular village location
- Priced for immediate interest
- Garage in a block

Contact Us

Towers Wills Estate Agents - Yeovil

114, Hendford Hill
Yeovil

Somerset
BA202RF

T: 01935 577032

E: info@towerswills.co.uk

Energy Efficiency

Score	Energy rating	Current	Potential
92+	A		
81-91	B		90 B
69-80	C		
55-68	D	68 D	
39-54	E		
21-38	F		
1-20	G		



Floor Plan

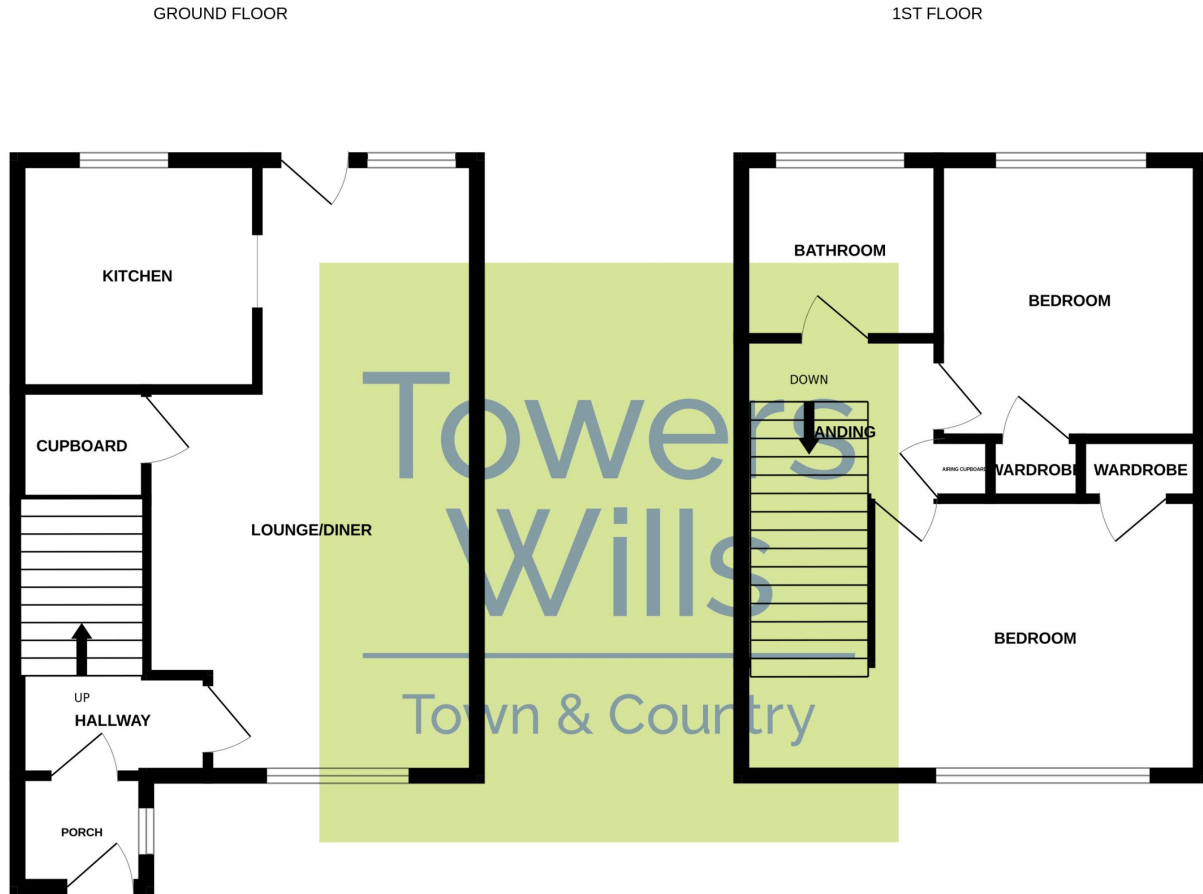

Whilst every attempt has been made to ensure the accuracy of the floorplan contained here, measurements of doors, windows, rooms and any other items are approximate and no responsibility is taken for any error, omission or mis-statement. This plan is for illustrative purposes only and should be used as such by any prospective purchaser. The services, systems and appliances shown have not been tested and no guarantee as to their operability or efficiency can be given.
Made with Metropix ©2023

Please Note No tests have been undertaken of any of the services and any intending purchasers should satisfy themselves in this regard. Towers Wills Ltd for themselves and for the vendor of this property whose agents they are, give notice that, (i) these particulars do not constitute any part of an offer or contract, (ii) all statements contained within these particulars are made without responsibility on the part of Towers Wills or the vendor, (iii) whilst made in good faith, none of the statements contained within these particulars are to be relied upon as a statement of representation or fact, (iv) any intending purchaser must satisfy him/herself by inspection or otherwise as to the correctness of each of the statements contained within these particulars, (v) the vendor does not make or give either Towers Wills or any person in their employment any authority to make or give representation or warranty whatsoever in relation to this property.

Photographs / Floor Plans Photographs are reproduced for general information and it must not be inferred that any item is included for sale with this property. Please note floor plans are not to scale and are for identification purposes only. The photographs used in these particulars may have been taken with the use of a wide angle lens. If you have any queries as to the size of the accommodation or plot, please address these with the agent prior to making an appointment to view

Towers Wills

The White House, 114 Hendford Hill, Yeovil BA20 2RF

Yeovil 01935 577032 / South Petherton 01460 298530

info@towerswills.co.uk | www.towerswills.co.uk