

Towers Wills

Town & Country

📞 01935 577 032 | 01460 298 530 | ✉ info@towerswills.co.uk



24, Hertford Road, Yeovil, Somerset BA21 5UZ

Offers Over £250,000

Towers Wills are delighted to bring to market this immaculate three bedroom extended terraced house, an ideal first time buy the property comprises of; open plan kitchen, lounge, and dining room, three good sized bedrooms and a stunning bathroom. Outside the front of the property overlooks open parkland while the rear is a well-kept low maintenance garden which has rear gated access to the shared parking area. One not to miss!

Entrance Hall

Double glazed door to the front, cupboard including central heating boiler and w.c.

Open Plan Kitchen/Diner 4.52m x 4.47m

Finished to an extremely high standard, the kitchen comprises of a range of wall, base and drawer units, work surfacing with one and a half bowl sink/drainers, space for American style fridge freezer, integrated double oven and microwave, five ring hob with extractor fan, integrated dishwasher, space for washing machine, radiator and double glazed window to front.

Lounge Area 4.50m x 5.69m

Double glazed sliding doors leading to garden, radiator and electric feature fireplace.

First Floor Landing

Airing cupboard and loft hatch.

Bedroom One 3.90m x 2.39m

Double glazed window to the front, radiator and fitted wardrobes.

Bedroom Two 2.23m x 5.07m

Double glazed window to the rear and radiator.

Bedroom Three 2.23m x 2.13m

Double glazed window to the rear and radiator.

Bathroom

Suite comprising newly renovated shower cubicle, jacuzzi bath, wash hand basin, w.c, heated towel rail and extractor fan.

Rear Garden

To the rear the garden is mainly laid to patio with area of artificial grass, outbuilding and gated rear access.

Key Features

- Three bedroom extended house
- Finished to an extremely high standard
- Downstairs W/C
- Outlook onto fields
- Popular location
- Viewing advised

Contact Us

Towers Wills Estate Agents - Yeovil

114, Hendford Hill

Yeovil

Somerset

BA202RF

T: 01935 577032

E: info@towerswills.co.uk

Energy Efficiency

Score	Energy rating	Current	Potential
92+	A		
81-91	B	87 B	88 B
69-80	C		
55-68	D		
39-54	E		
21-38	F		
1-20	G		



Floor Plan

GROUND FLOOR

1ST FLOOR

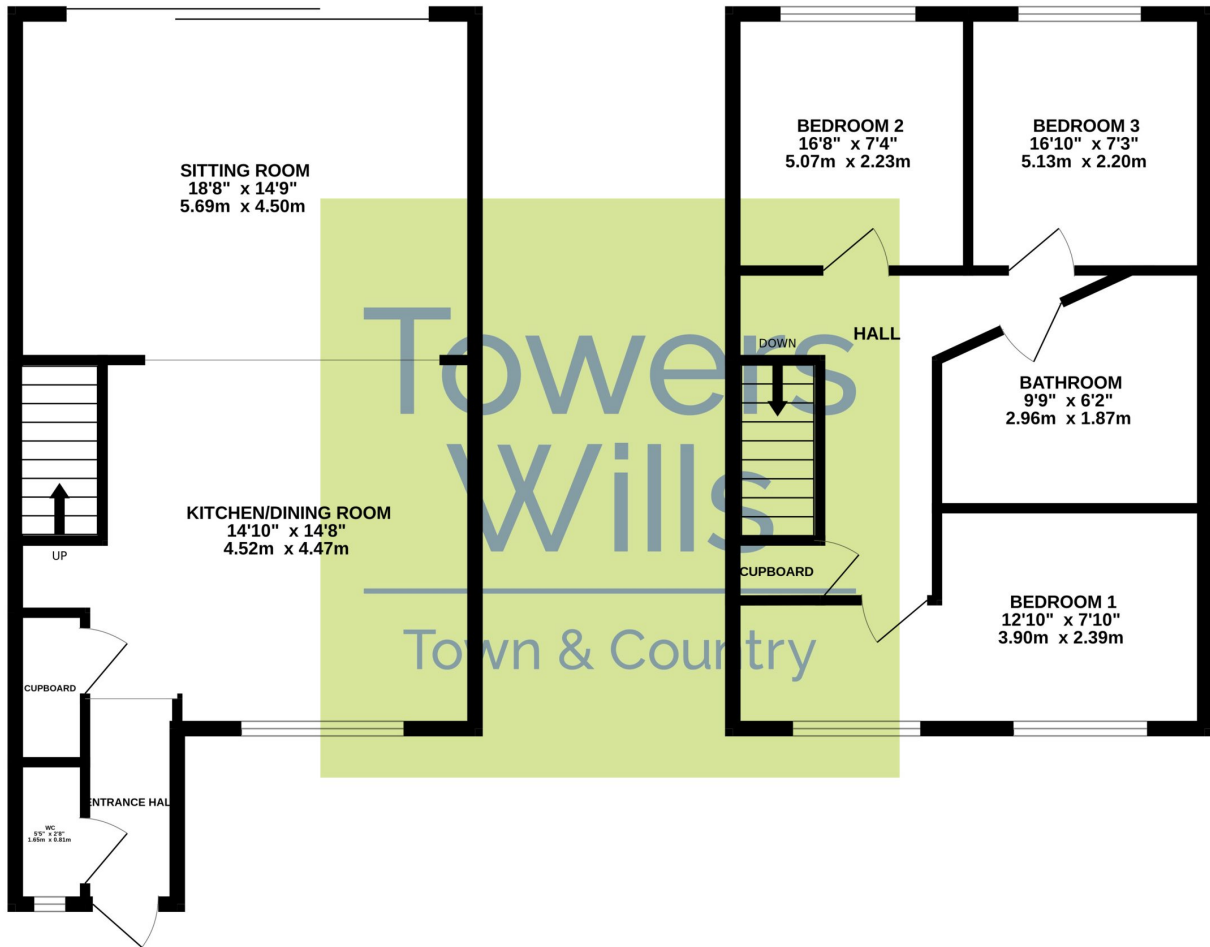

Whilst every attempt has been made to ensure the accuracy of the floorplan contained here, measurements of doors, windows, rooms and any other items are approximate and no responsibility is taken for any error, omission or mis-statement. This plan is for illustrative purposes only and should be used as such by any prospective purchaser. The services, systems and appliances shown have not been tested and no guarantee as to their operability or efficiency can be given.
Made with Metropix ©2023

Please Note No tests have been undertaken of any of the services and any intending purchasers should satisfy themselves in this regard. Towers Wills Ltd for themselves and for the vendor of this property whose agents they are, give notice that, (i) these particulars do not constitute any part of an offer or contract, (ii) all statements contained within these particulars are made without responsibility on the part of Towers Wills or the vendor, (iii) whilst made in good faith, none of the statements contained within these particulars are to be relied upon as a statement of representation or fact, (iv) any intending purchaser must satisfy him/herself by inspection or otherwise as to the correctness of each of the statements contained within these particulars, (v) the vendor does not make or give either Towers Wills or any person in their employment any authority to make or give representation or warranty whatsoever in relation to this property.

Photographs / Floor Plans Photographs are reproduced for general information and it must not be inferred that any item is included for sale with this property. Please note floor plans are not to scale and are for identification purposes only. The photographs used in these particulars may have been taken with the use of a wide angle lens. If you have any queries as to the size of the accommodation or plot, please address these with the agent prior to making an appointment to view

Towers Wills

The White House, 114 Hendford Hill, Yeovil BA20 2RF

Yeovil 01935 577032 / South Petherton 01460 298530

info@towerswills.co.uk | www.towerswills.co.uk