

Towers Wills

Town & Country

📞 01935 577 032 | 01460 298 530 | ✉ info@towerswills.co.uk



124, Monks Dale, Yeovil, Somerset BA21 3HT

£180,000

Towers Wills welcome to market this ideal first home or buy to let investment. Situated in a popular location close to local schools and amenities, the property benefits from good sized lounge, kitchen/diner, two double bedrooms, bathroom, pleasant south easterly facing rear garden and garage (situated in a separate block).

Entrance Hall

Double glazed door to the front and cupboard.

Lounge 5.04m x 3.89m – maximum measurements

Double glazed window to the front, two radiators, gas fireplace and stairs to the first floor.

Kitchen/Diner 3.18m x 3.87m – maximum measurements

Comprising of a range of wall, base and drawer units, work surfacing with stainless steel one and a half bowl sink drainer, double glazed patio doors to the rear, double glazed window to the rear, radiator, space for fridge freezer, space for washing machine, space for dryer, integrated gas hob with cookerhood over and integrated electric oven.

First Floor Landing

Includes loft hatch and airing cupboard which includes the gas boiler.

Bathroom

Comprising bath with centre taps and shower over, wash hand basin, w.c, radiator, extractor fan and shaver point.

Bedroom One 3.03m x 3.88m

Double glazed window to the rear and radiator.

Bedroom Two 3.10m x 3.90m – maximum measurements

Double glazed window to the front and radiator.

Outside

To the front of the property there is a slate gravelled bed. To the rear the garden is largely laid to lawn with patio area, outside tap and rear access.

Garage in a Block

With 'up and over' door to the front.

Key Features

- Popular Location
- Two Double Bedrooms
- Rear Garden
- Garage in a Block

Contact Us

Towers Wills Estate Agents - Yeovil

114, Hendford Hill

Yeovil

Somerset

BA202RF

T: 01935 577032

E: info@towerswills.co.uk

Energy Efficiency

Score	Energy rating	Current	Potential
92+	A		
81-91	B		91 B
69-80	C		
55-68	D	65 D	
39-54	E		
21-38	F		
1-20	G		



Floor Plan

GROUND FLOOR

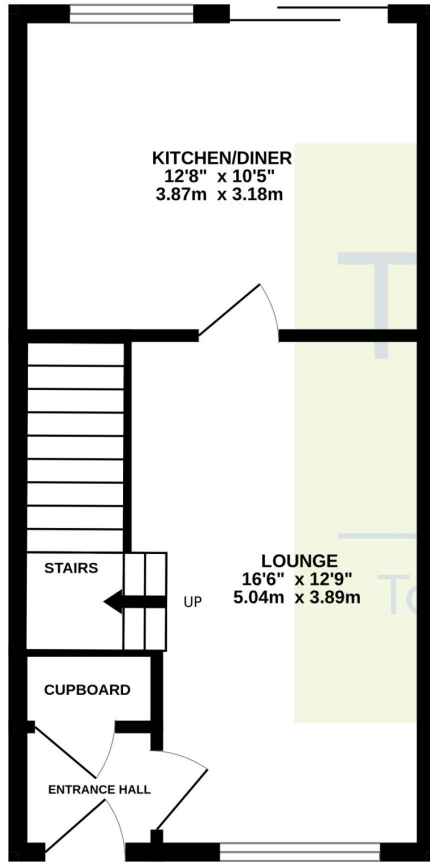

1ST FLOOR

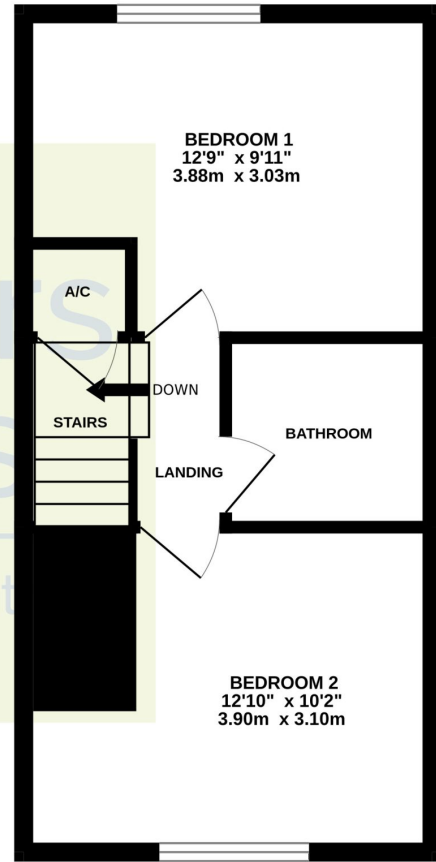

Whilst every attempt has been made to ensure the accuracy of the floorplan contained here, measurements of doors, windows, rooms and any other items are approximate and no responsibility is taken for any error, omission or mis-statement. This plan is for illustrative purposes only and should be used as such by any prospective purchaser. The services, systems and appliances shown have not been tested and no guarantee as to their operability or efficiency can be given.
Made with Metropix ©2023

Please Note No tests have been undertaken of any of the services and any intending purchasers should satisfy themselves in this regard. Towers Wills Ltd for themselves and for the vendor of this property whose agents they are, give notice that, (i) these particulars do not constitute any part of an offer or contract, (ii) all statements contained within these particulars are made without responsibility on the part of Towers Wills or the vendor, (iii) whilst made in good faith, none of the statements contained within these particulars are to be relied upon as a statement of representation or fact, (iv) any intending purchaser must satisfy him/herself by inspection or otherwise as to the correctness of each of the statements contained within these particulars, (v) the vendor does not make or give either Towers Wills or any person in their employment any authority to make or give representation or warranty whatsoever in relation to this property.

Photographs / Floor Plans Photographs are reproduced for general information and it must not be inferred that any item is included for sale with this property. Please note floor plans are not to scale and are for identification purposes only. The photographs used in these particulars may have been taken with the use of a wide angle lens. If you have any queries as to the size of the accommodation or plot, please address these with the agent prior to making an appointment to view

Towers Wills

The White House, 114 Hendford Hill, Yeovil BA20 2RF

Yeovil 01935 577032 / South Petherton 01460 298530

info@towerswills.co.uk | www.towerswills.co.uk