

Towers Wills

Town & Country

📞 01935 577 032 | 01460 298 530 | ✉ info@towerswills.co.uk



18, Kenmore Drive, Yeovil, Somerset BA21 4BG

Offers Over £250,000

Towers Wills welcome to the market this two bedroom semi-detached chalet bungalow, situated in a popular tucked-away position, within walking distance of Yeovil Town and Yeovil District Hospital and briefly comprising; reception hallway, living room, dining room/bedroom two, kitchen, conservatory, bedroom, shower room, galleried landing, loft room, driveway, garage and rear garden.

Reception Hallway

With double glazed door to the side and radiator.

Living Room

A spacious living area with window to the front and radiator.

Kitchen

A modern kitchen comprising of a range of wall, base and drawer units, work surfacing with sink/drainers, integrated double electric oven, integrated hob with cookerhood over, integrated microwave, space and plumbing for both dishwasher and washing machine, Worcester combination boiler, window to the side and door through to the conservatory.

Conservatory

With radiator, windows overlooking onto the rear garden and door to the patio area.

Dining Room/Bedroom Two

With window to the rear, radiator and stairs rising to the first floor.

Bedroom One

With bay window to the front and radiator.

Shower Room

Comprising of shower cubicle, wash hand basin, w.c, two windows to the side, tiling, extractor fan and heated towel rail.

First Floor Galleried Landing Area

A useful space, ideal for a study/hobby area, with velux skylight, storage to the eaves and door to the loft room.

Loft Room

With window to the rear.

Outside

To the front of the property is an area of parking for one vehicle, further area of shared driveway leading to the detached garage.

Garage

With 'up and over' door, power and light.

Rear Garden

There is an enclosed, landscaped garden with patio area, stone chip area, green house and there is side access.

Key Features

- Semi-detached Bungalow
- Popular Location
- Conservatory
- Loft room
- Driveway & Garage
- Rear Garden

Contact Us

Towers Wills Estate Agents - Yeovil

114, Hendford Hill
Yeovil

Somerset
BA202RF

T: 01935 577032

E: info@towerswills.co.uk

Energy Efficiency

Score	Energy rating	Current	Potential
92+	A		
81-91	B		
69-80	C	69 C	83 B
55-68	D		
39-54	E		
21-38	F		
1-20	G		



Floor Plan

GROUND FLOOR

1ST FLOOR

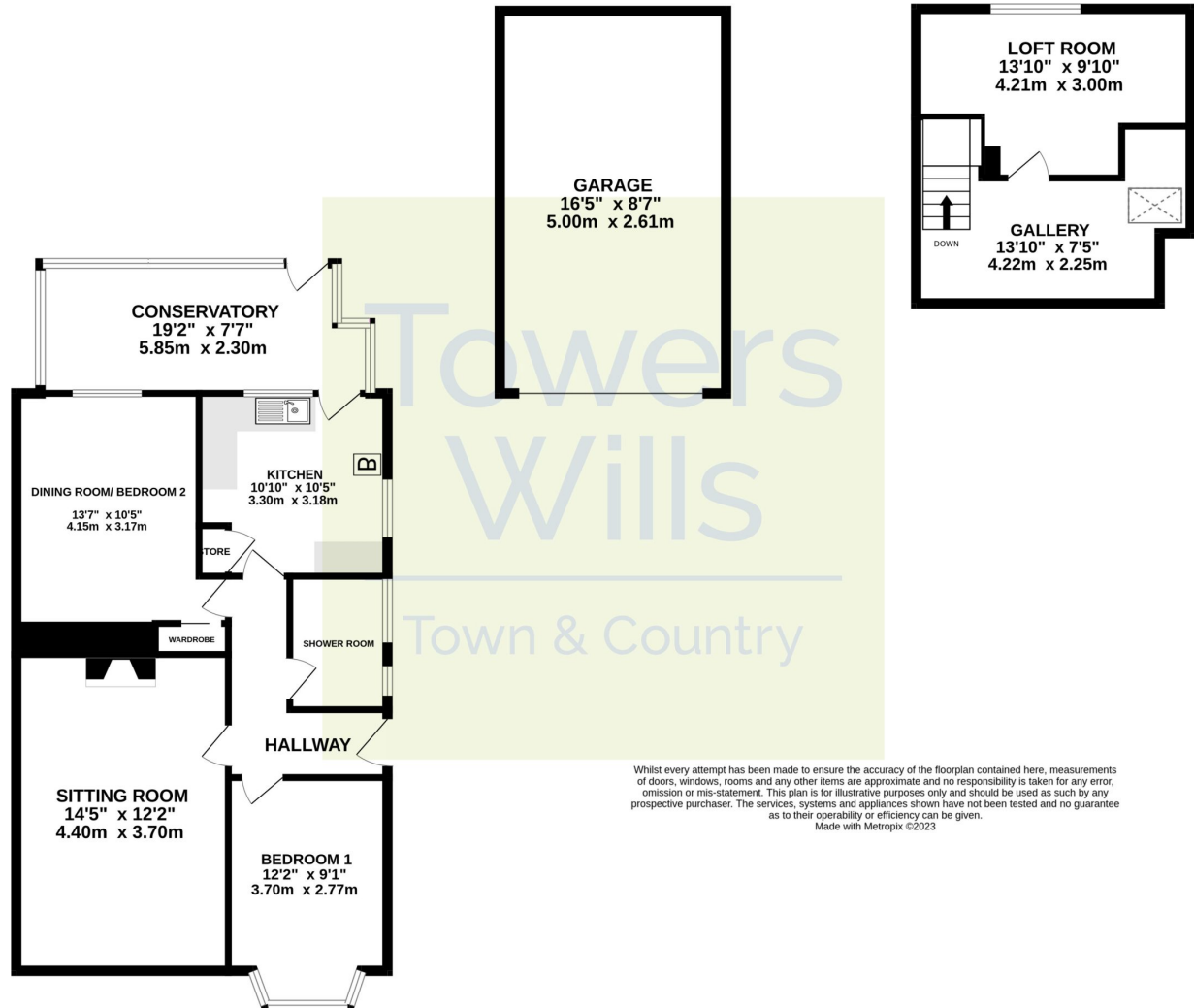

Please Note No tests have been undertaken of any of the services and any intending purchasers should satisfy themselves in this regard. Towers Wills Ltd for themselves and for the vendor of this property whose agents they are, give notice that, (i) these particulars do not constitute any part of an offer or contract, (ii) all statements contained within these particulars are made without responsibility on the part of Towers Wills or the vendor, (iii) whilst made in good faith, none of the statements contained within these particulars are to be relied upon as a statement of representation or fact, (iv) any intending purchaser must satisfy him/herself by inspection or otherwise as to the correctness of each of the statements contained within these particulars, (v) the vendor does not make or give either Towers Wills or any person in their employment any authority to make or give representation or warranty whatsoever in relation to this property.

Photographs / Floor Plans Photographs are reproduced for general information and it must not be inferred that any item is included for sale with this property. Please note floor plans are not to scale and are for identification purposes only. The photographs used in these particulars may have been taken with the use of a wide angle lens. If you have any queries as to the size of the accommodation or plot, please address these with the agent prior to making an appointment to view

Towers Wills

The White House, 114 Hendford Hill, Yeovil BA20 2RF

Yeovil 01935 577032 / South Petherton 01460 298530

info@towerswills.co.uk | www.towerswills.co.uk