

Towers Wills

Town & Country

📞 01935 577 032 | 01460 298 530 | ✉ info@towerswills.co.uk



63, North Street, Martock, Somerset TA12 6EH

£175,000

Towers Wills welcome to the market this beautifully presented character cottage, situated in the heart of this thriving village and within easy reach of the village centre and amenities. The property is available with no onward chain and briefly comprises; entrance, lounge/diner, kitchen, two bedrooms, bathroom, front and rear gardens, gas central heated and double glazed.

Entrance

Double glazed door to the front.

Lounge/Diner

A light dual aspect lounge/diner with the lounge area being set around a beautiful hamstone fireplace and wood burning stove, double glazed window to the front with window seat and storage cupboard.

Dining Area

With room for table and chair set, double glazed window to the rear and radiator.

Kitchen

Comprising of a range of wall, base and drawer units, timber work surfacing with stainless steel sink/drain, integrated electric oven, integrated electric hob, space for fridge/freezer, plumbing for washing machine and double glazed door to the rear garden.

First Floor Landing

With stairs from reception hallway.

Bedroom One

Double glazed window to the front and radiator.

Bedroom Two

Double glazed window to the rear, radiator and over stairs storage cupboard.

Bathroom

A re-fitted white suite comprising of bath with shower over, wash hand basin with vanity unit under, w.c and tiling.

Outside

To the front of the property is an enclosed area of front garden with gate and path leading to the entrance. To the rear of the property is an enclosed courtyard garden with storage shed (with power and light).

Key Features

- Character Cottage
- Beautifully Presented
- Two Bedrooms
- Gardens
- NO ONWARD CHAIN

Contact Us

Towers Wills Estate Agents - Yeovil

114, Hendford Hill

Yeovil

Somerset

BA202RF

T: 01935 577032

E: info@towerswills.co.uk

Energy Efficiency

| Score | Energy rating | Current | Potential |
|-------|---------------|---------|-----------|
| 92+ | A | | |
| 81-91 | B | | 90 B |
| 69-80 | C | | |
| 55-68 | D | 68 D | |
| 39-54 | E | | |
| 21-38 | F | | |
| 1-20 | G | | |



Floor Plan

GROUND FLOOR

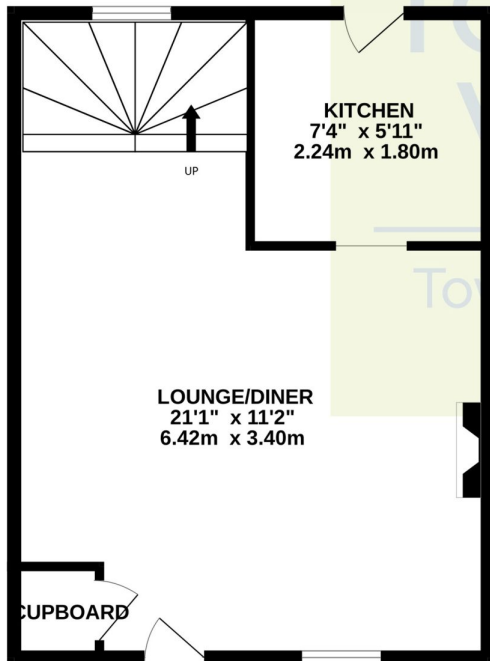

1ST FLOOR

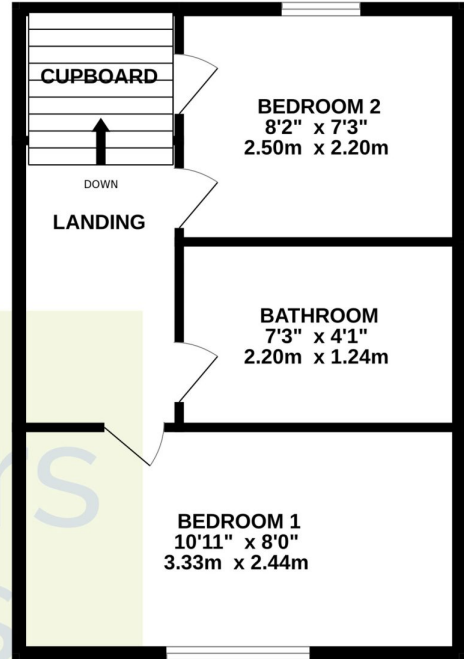

Whilst every attempt has been made to ensure the accuracy of the floorplan contained here, measurements of doors, windows, rooms and any other items are approximate and no responsibility is taken for any error, omission or mis-statement. This plan is for illustrative purposes only and should be used as such by any prospective purchaser. The services, systems and appliances shown have not been tested and no guarantee as to their operability or efficiency can be given.
Made with Metropix ©2023

Please Note No tests have been undertaken of any of the services and any intending purchasers should satisfy themselves in this regard. Towers Wills Ltd for themselves and for the vendor of this property whose agents they are, give notice that, (i) these particulars do not constitute any part of an offer or contract, (ii) all statements contained within these particulars are made without responsibility on the part of Towers Wills or the vendor, (iii) whilst made in good faith, none of the statements contained within these particulars are to be relied upon as a statement of representation or fact, (iv) any intending purchaser must satisfy him/herself by inspection or otherwise as to the correctness of each of the statements contained within these particulars, (v) the vendor does not make or give either Towers Wills or any person in their employment any authority to make or give representation or warranty whatsoever in relation to this property.

Photographs / Floor Plans Photographs are reproduced for general information and it must not be inferred that any item is included for sale with this property. Please note floor plans are not to scale and are for identification purposes only. The photographs used in these particulars may have been taken with the use of a wide angle lens. If you have any queries as to the size of the accommodation or plot, please address these with the agent prior to making an appointment to view.

Towers Wills

The White House, 114 Hendford Hill, Yeovil BA20 2RF

Yeovil 01935 577032 / South Petherton 01460 298530

info@towerswills.co.uk | www.towerswills.co.uk