

# Towers Wills

Town & Country

📞 01935 577 032 | 01460 298 530 | ✉ info@towerswills.co.uk



12, Freedom Avenue, Yeovil, Somerset BA21 3JL

**£275,000**

Towers Wills welcome to the market this exceptionally spacious four bedroom family home and briefly comprises; hallway, living room with wood burning stove, dining room, kitchen, rear lobby/study, shower room, four bedrooms, bathroom, large driveway and enclosed rear garden.

## Hallway

A spacious reception area with double glazed door to the front and being open through to the dining room.

## Living Room

A spacious dual aspect family living area with woodburning stove, window to the front, patio doors to the rear and radiator.

## Dining Room

A perfect area for entertaining with family and friends; being open plan to the kitchen and the dining area offers ample space for table and chairs, window to the front and radiator.

## Kitchen

Comprising of a range of wall, base and drawer units, work surfacing with inset sink/drainage, space for Range cooker with cookerhood over, tiling to splash prone areas, plumbing for dishwasher and window to the rear.

## Rear Lobby/Study

A versatile room with window and patio doors through to the garden.

## Shower Room

Suite comprising of shower cubicle, wash hand basin, w.c, tiling and storage cupboard.

## First Floor Landing

With stairs from reception hallway, airing cupboard and loft access.

## Bedroom One

Window to the front and radiator.

## Bedroom Two

Window to the front and radiator.

## Bedroom Three

Window to the rear and radiator.

## Bedroom Four

Window to the rear and radiator.

## Shower Room

Suite comprising of shower cubicle, wash hand basin, w.c, tiling, heated towel rail and window to the rear.

## Outside

To the front of the property is a large driveway providing ample off road parking and garden path leading to the entrance.

## Rear Garden

To the rear of the property is an enclosed garden, being landscaped for low maintenance with patio area, stone chip area, sheltered seating area being perfect for the unpredictable British summertime, garden shed, wood store and workshop.

## Key Features

- Spacious Family Home
- Four Bedrooms
- Large Driveway
- Enclosed Rear Garden

## Contact Us

### Towers Wills Estate Agents - Yeovil

114, Hendford Hill

Yeovil

Somerset

BA202RF

T: 01935 577032

E: [info@towerswills.co.uk](mailto:info@towerswills.co.uk)

## **Workshop**

With door and window to the garden.



# Floor Plan

GROUND FLOOR

1ST FLOOR

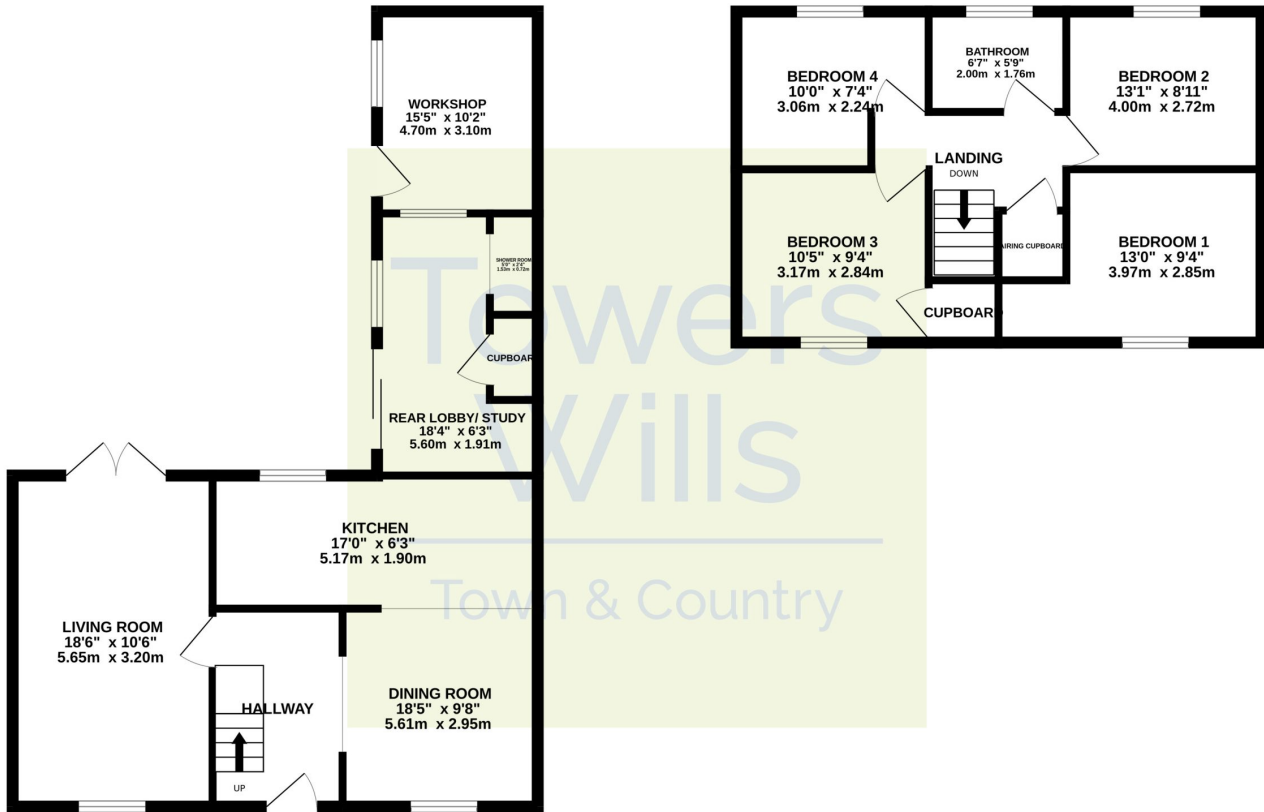

Whilst every attempt has been made to ensure the accuracy of the floorplan contained here, measurements of doors, windows, rooms and any other items are approximate and no responsibility is taken for any error, omission or mis-statement. This plan is for illustrative purposes only and should be used as such by any prospective purchaser. The services, systems and appliances shown have not been tested and no guarantee as to their operability or efficiency can be given.  
Made with Metropix ©2024

Please Note No tests have been undertaken of any of the services and any intending purchasers should satisfy themselves in this regard. Towers Wills Ltd for themselves and for the vendor of this property whose agents they are, give notice that, (i) these particulars do not constitute any part of an offer or contract, (ii) all statements contained within these particulars are made without responsibility on the part of Towers Wills or the vendor, (iii) whilst made in good faith, none of the statements contained within these particulars are to be relied upon as a statement of representation or fact, (iv) any intending purchaser must satisfy him/herself by inspection or otherwise as to the correctness of each of the statements contained within these particulars, (v) the vendor does not make or give either Towers Wills or any person in their employment any authority to make or give representation or warranty whatsoever in relation to this property.

Photographs / Floor Plans Photographs are reproduced for general information and it must not be inferred that any item is included for sale with this property. Please note floor plans are not to scale and are for identification purposes only. The photographs used in these particulars may have been taken with the use of a wide angle lens. If you have any queries as to the size of the accommodation or plot, please address these with the agent prior to making an appointment to view

**Towers Wills**

The White House, 114 Hendford Hill, Yeovil BA20 2RF

Yeovil 01935 577032 / South Petherton 01460 298530

[info@towerswills.co.uk](mailto:info@towerswills.co.uk) | [www.towerswills.co.uk](http://www.towerswills.co.uk)