

# Towers Wills

Town & Country

📞 01935 577 032 | 01460 298 530 | ✉ info@towerswills.co.uk



**37, Rowan Way, Yeovil, Somerset BA20 2NP**

**Guide Price £200,000**

Towers Wills are pleased to welcome to market this well presented two bedroom terraced house, set in this popular residential location and offering close convenience to local shops, schools and bus routes. The house benefits from two bedrooms, conservatory, gas central heating, UPVC double glazing, modern bathroom suite, enclosed rear garden and garage to the rear. Ideal for First Time Buyers or Investors.

**Entrance Porch** 1.53m x 1.08m

Double glazed door to the front, double glazed window to the front and single door leading to the living area.

**Living Area** 3.31m x 4.19m

Double glazed window to the front, radiator and small hallway with stairs leading to the first floor.

**Kitchen** 2.66m x 4.18m

Comprising of a range of wall, base and drawer units, work surfacing with sink/drainage, space for washing machine, space for fridge freezer, oven with cookerhood over, boiler, radiator, laminate flooring, window to conservatory and under stairs storage cupboard.

**Conservatory** 2.55m x 3.16m

Double glazed sliding patio doors to the rear and door to kitchen.

**First Floor Landing**

Doors to first floor accommodation and access to the loft space.

**Bedroom One** 4.20m x 3.28m

Double glazed window to the front, storage cupboard and radiator.

**Bedroom Two** 2.15m x 2.67m

Double glazed window to the rear and radiator.

**Family Bathroom** 1.86m x 1.96m

Suite comprising tiled bath with shower over, wash hand basin, low level w.c, double glazed window to the rear, spotlights and tiled flooring.

**Outside**

To the rear is a lawn area with a small patio seating area leading from the conservatory and path leading to the rear gate.

**Garage in a Block** 2.52m x 5.21m

With 'up and over' door, power and light.

## Key Features

- Popular Location
- Two Bedrooms
- Conservatory
- Rear Garden
- Garage in a Block
- Ideal First Time Buy/Investment Opportunity

## Contact Us

**Towers Wills Estate Agents - Yeovil**

114, Hendford Hill

Yeovil

Somerset

BA202RF

T: 01935 577032

E: [info@towerswills.co.uk](mailto:info@towerswills.co.uk)



# Floor Plan

GROUND FLOOR

1ST FLOOR

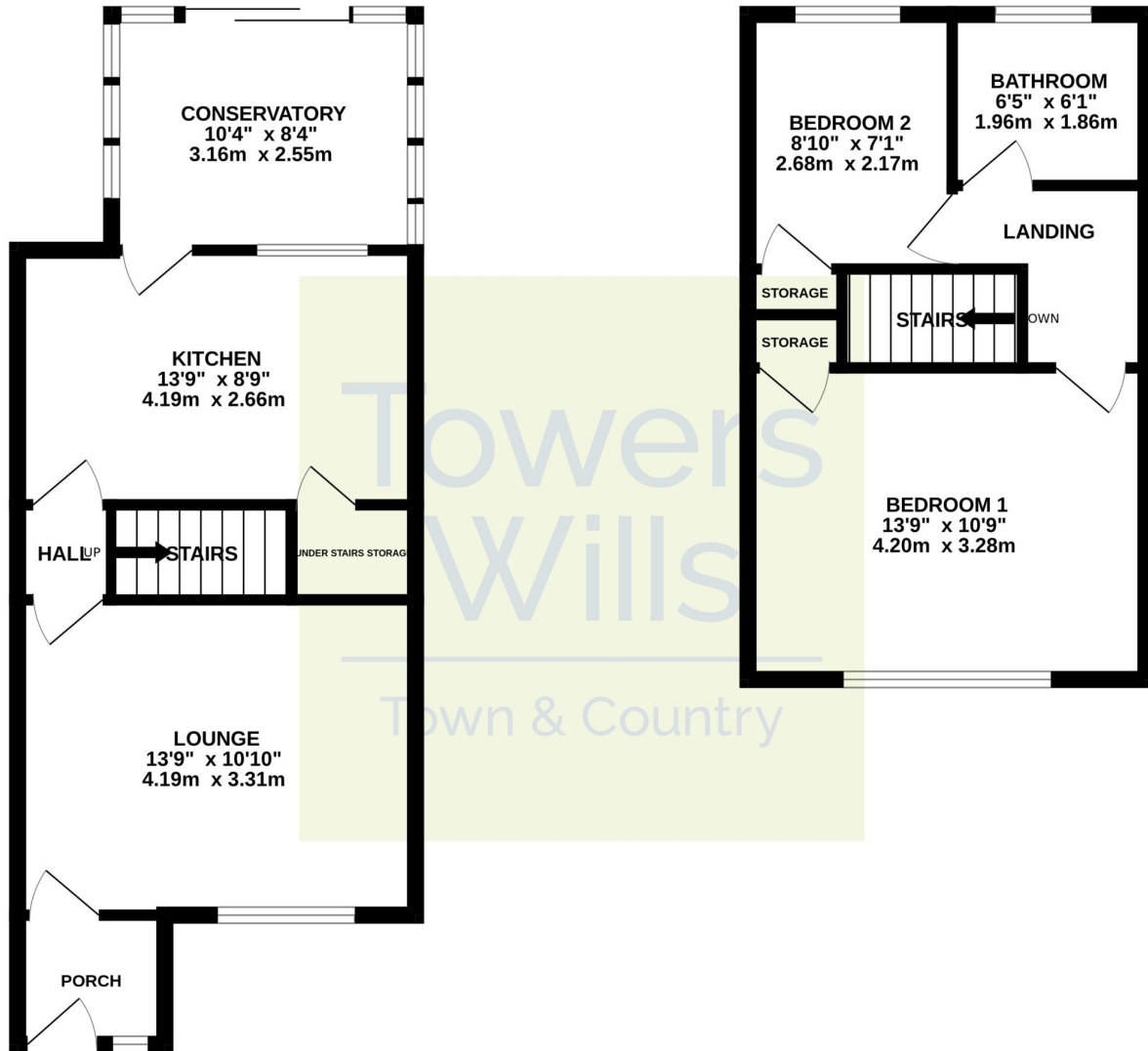

Whilst every attempt has been made to ensure the accuracy of the floorplan contained here, measurements of doors, windows, rooms and any other items are approximate and no responsibility is taken for any error, omission or mis-statement. This plan is for illustrative purposes only and should be used as such by any prospective purchaser. The services, systems and appliances shown have not been tested and no guarantee as to their operability or efficiency can be given.  
Made with Metropix ©2024

Please Note No tests have been undertaken of any of the services and any intending purchasers should satisfy themselves in this regard. Towers Wills Ltd for themselves and for the vendor of this property whose agents they are, give notice that, (i) these particulars do not constitute any part of an offer or contract, (ii) all statements contained within these particulars are made without responsibility on the part of Towers Wills or the vendor, (iii) whilst made in good faith, none of the statements contained within these particulars are to be relied upon as a statement of representation or fact, (iv) any intending purchaser must satisfy him/herself by inspection or otherwise as to the correctness of each of the statements contained within these particulars, (v) the vendor does not make or give either Towers Wills or any person in their employment any authority to make or give representation or warranty whatsoever in relation to this property.

Photographs / Floor Plans Photographs are reproduced for general information and it must not be inferred that any item is included for sale with this property. Please note floor plans are not to scale and are for identification purposes only. The photographs used in these particulars may have been taken with the use of a wide angle lens. If you have any queries as to the size of the accommodation or plot, please address these with the agent prior to making an appointment to view

**Towers Wills**

The White House, 114 Hendford Hill, Yeovil BA20 2RF

Yeovil 01935 577032 / South Petherton 01460 298530

info@towerswills.co.uk | [www.towerswills.co.uk](http://www.towerswills.co.uk)