

Towers Wills

Town & Country

☎ 01935 577 032 | 01460 298 530 | ✉ info@towerswills.co.uk



29, Cavalier Way, Yeovil, Somerset BA21 5UB

£180,000

Towers Wills are pleased to welcome to market this two double bedroom terraced home, situated on the eastern side of Yeovil, in a popular residential area and being close to many local amenities including, shops and schools. The property benefits from; entrance hall, kitchen, lounge/diner, two double bedrooms, family bathroom and rear garden.

Entrance Hall

Double glazed door to the front, storage cupboard, under stairs cupboard, radiator, door to lounge and entrance to kitchen.

Kitchen 4.38m x 2.65m

Comprising of a range of wall, base and drawer units, wooden work tops with stainless steel sink/drainers with mixer tap, integrated oven with grill, induction hob with cookerhood over, space for washing machine, space for dishwasher, space for tumble dryer, laminate floor, radiator and double glazed window to the front.

Lounge/Diner 4.47m x 3.90m

Double glazed patio doors to the garden, double glazed window to the rear, laminate flooring and radiator.

First Floor Landing

Loft access and over stairs cupboard.

Bedroom One 2.45m x 3.95m

Two double glazed windows to the front, storage cupboard and radiator.

Bedroom Two 4.48m x 3.57m

Two double glazed windows to the front and radiator.

Family Bathroom 1.47m x 2.58m

Suite comprising p-shape bath with shower over, wash hand basin, low level w.c, heated towel rail, laminate flooring, extractor fan and part tiled.

Rear Garden

To the rear the garden is mainly laid to artificial grass with patio seating area, space for a shed and there is gated rear access.

Key Features

- Terrace
- Two Double Bedrooms
- Rear Garden
- Popular Residential Location

Contact Us

Towers Wills Estate Agents - Yeovil

114, Hendford Hill

Yeovil

Somerset

BA202RF

T: 01935 577032

E: info@towerswills.co.uk

Energy Efficiency

Score	Energy rating	Current	Potential
92+	A		
81-91	B		86 B
69-80	C	69 C	
55-68	D		
39-54	E		
21-38	F		
1-20	G		



Floor Plan

GROUND FLOOR
342 sq.ft. (31.8 sq.m.) approx.

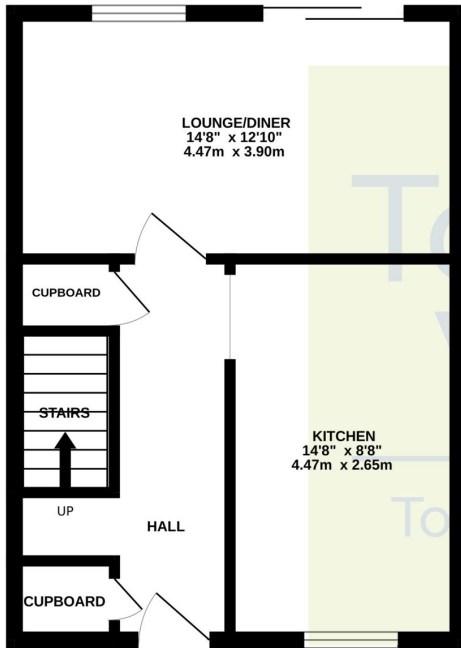

1ST FLOOR
342 sq.ft. (31.8 sq.m.) approx.

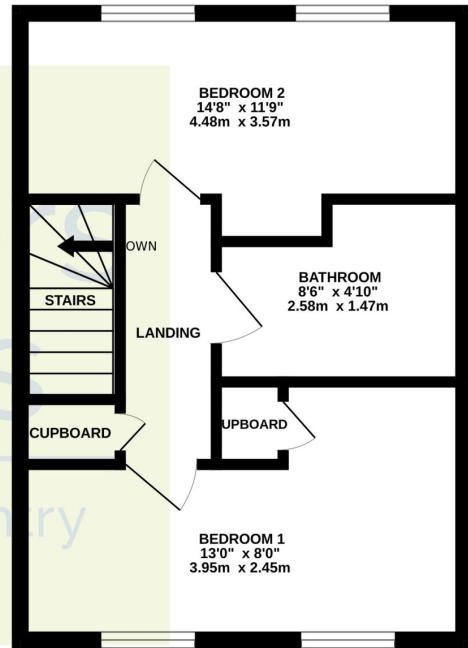

TOTAL FLOOR AREA : 684 sq.ft. (63.6 sq.m.) approx.

Whilst every attempt has been made to ensure the accuracy of the floorplan contained here, measurements of doors, windows, rooms and any other items are approximate and no responsibility is taken for any error, omission or mis-statement. This plan is for illustrative purposes only and should be used as such by any prospective purchaser. The services, systems and appliances shown have not been tested and no guarantee as to their operability or efficiency can be given.
Made with Metropix ©2024

Please Note No tests have been undertaken of any of the services and any intending purchasers should satisfy themselves in this regard. Towers Wills Ltd for themselves and for the vendor of this property whose agents they are, give notice that, (i) these particulars do not constitute any part of an offer or contract, (ii) all statements contained within these particulars are made without responsibility on the part of Towers Wills or the vendor, (iii) whilst made in good faith, none of the statements contained within these particulars are to be relied upon as a statement of representation or fact, (iv) any intending purchaser must satisfy him/herself by inspection or otherwise as to the correctness of each of the statements contained within these particulars, (v) the vendor does not make or give either Towers Wills or any person in their employment any authority to make or give representation or warranty whatsoever in relation to this property.

Photographs / Floor Plans Photographs are reproduced for general information and it must not be inferred that any item is included for sale with this property. Please note floor plans are not to scale and are for identification purposes only. The photographs used in these particulars may have been taken with the use of a wide angle lens. If you have any queries as to the size of the accommodation or plot, please address these with the agent prior to making an appointment to view

Towers Wills

The White House, 114 Hendford Hill, Yeovil BA20 2RF

Yeovil 01935 577032 / South Petherton 01460 298530

info@towerswills.co.uk | www.towerswills.co.uk