

# Towers Wills

Town & Country

📞 01935 577 032 | 01460 298 530 | ✉ info@towerswills.co.uk



**17, Larkspur Crescent, Yeovil, Somerset BA21 3HL**

**Guide Price £120,000**

Towers Wills are pleased to welcome to market this spacious one bedroom first floor apartment offering a superb opportunity for first time buyers or investors. Briefly comprising of entrance hall, kitchen, good size lounge / diner, large bedroom and bathroom. There is a parking area at the front and a communal area with cupboard. The property also benefits from NO FORWARD CHAIN.

## Entrance Hall

With intercom system, storage cupboard, cupboard housing with boiler and telephone point.

## Kitchen 2.99m x 2.38m

Comprising of a range of wall, base and draw unit, fitted with pattern worktops, stainless steel sink drainer unit with mixer tap. Induction hob with electric oven and cooker hood over. Space for washing machine, tumble dryer and fridge freezer. Double glazed window to front.

## Lounge/Diner 4.43m x 3.07m

Double glazed window to rear, radiator and TV point.

## Master Bedroom 4.43m x 2.90m

Double glazed window to rear, fitted wardrobes and radiator.

## Family Bathroom 1.92m x 2.30m

Fitted with a white bathroom suite comprising, W/C, pedestal wash hand basin, part tiled walls, wall mounted heated towel rail and double glazed window to front.

## Outside

The flat also benefits from a storage cupboard in the communal area

## Key Features

- First Floor Apartment
- One Double Bedroom
- Well Presented
- Gas Central Heated & Double Glazed
- Communal Parking
- No Forward Chain

## Contact Us

### Towers Wills Estate Agents - Yeovil

114, Hendford Hill

Yeovil

Somerset

BA202RF

T: 01935 577032

E: [info@towerswills.co.uk](mailto:info@towerswills.co.uk)

## Energy Efficiency

Score	Energy rating	Current	Potential
92+	A		
81-91	B		
69-80	C	72 C	79 C
55-68	D		
39-54	E		
21-38	F		
1-20	G		



# Floor Plan

## GROUND FLOOR

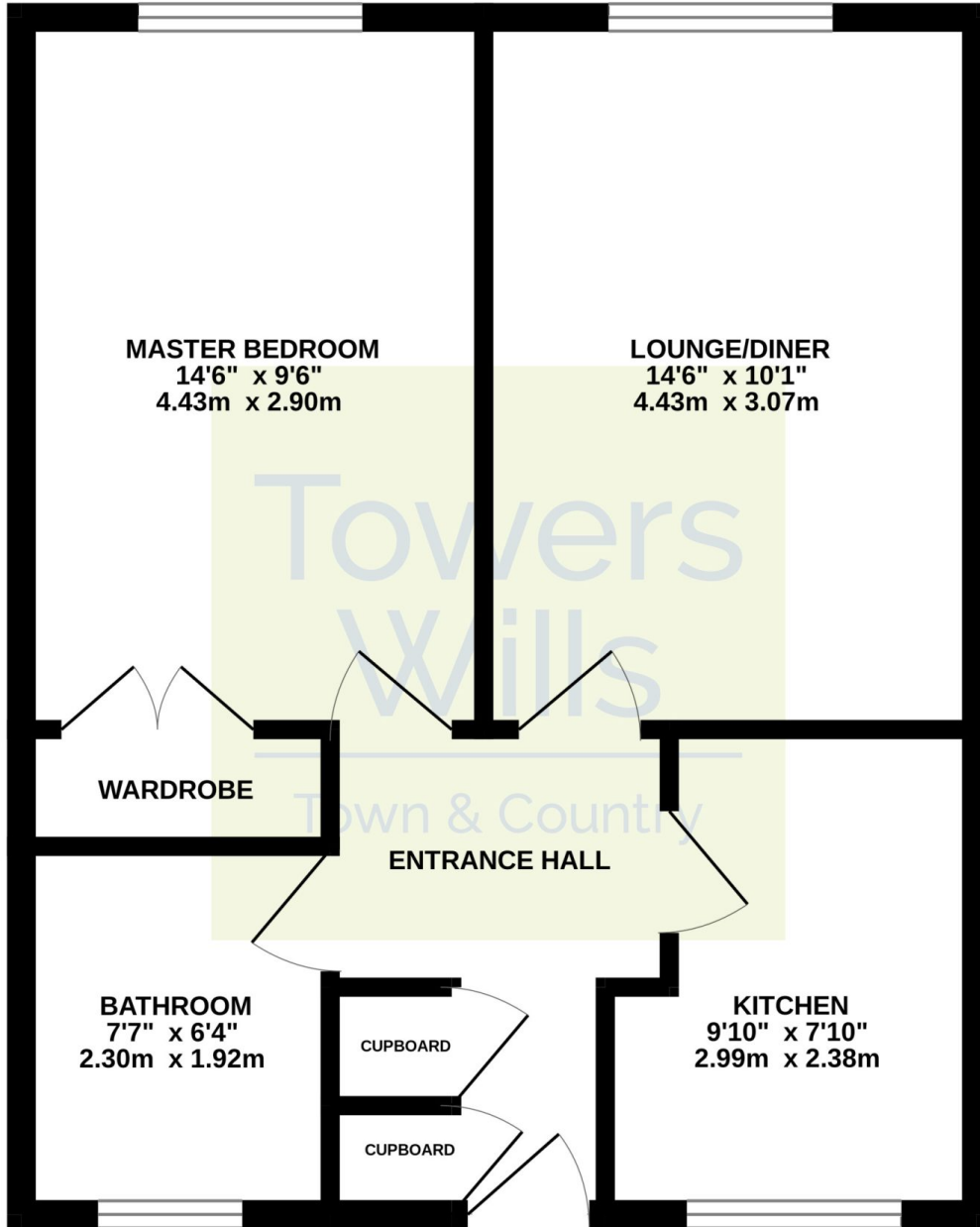

Whilst every attempt has been made to ensure the accuracy of the floorplan contained here, measurements of doors, windows, rooms and any other items are approximate and no responsibility is taken for any error, omission or mis-statement. This plan is for illustrative purposes only and should be used as such by any prospective purchaser. The services, systems and appliances shown have not been tested and no guarantee as to their operability or efficiency can be given.  
Made with Metropix ©2024

Please Note No tests have been undertaken of any of the services and any intending purchasers should satisfy themselves in this regard. Towers Wills Ltd for themselves and for the vendor of this property whose agents they are, give notice that, (i) these particulars do not constitute any part of an offer or contract, (ii) all

statements contained within these particulars are made without responsibility on the part of Towers Wills or the vendor , (iii) whilst made in good faith, none of the statements contained within these particulars are to be relied upon as a statement of representation or fact , (iv) any intending purchaser must satisfy him/herself by inspection or otherwise as to the correctness of each of the statements contained within these particulars, (v) the vendor does not make or give either Towers Wills or any person in their employment any authority to make or give representation or warranty whatsoever in relation to this property.

Photographs / Floor Plans Photographs are reproduced for general information and it must not be inferred that any item is included for sale with this property. Please note floor plans are not to scale and are for identification purposes only. The photographs used in these particulars may have been taken with the use of a wide angle lens. If you have any queries as to the size of the accommodation or plot, please address these with the agent prior to making an appointment to view

**Towers Wills**

The White House, 114 Hendford Hill, Yeovil BA20 2RF

Yeovil 01935 577032 / South Petherton 01460 298530

[info@towerswills.co.uk](mailto:info@towerswills.co.uk) | [www.towerswills.co.uk](http://www.towerswills.co.uk)