

Towers Wills

Town & Country

📞 01935 577 032 | 01460 298 530 | ✉ info@towerswills.co.uk



14, Crane Road, Yeovil, Somerset BA22 8FW

£199,995

Towers Wills are pleased to market this ideal first time buy or buy to let. Situated on the popular Agusta Park development and newly built in 2020, the property benefits from the remainder of its 10-year NHBC warranty. Property briefly comprises of; allocated parking, downstairs WC, two double bedrooms, lounge, kitchen/diner, bathroom and enclosed rear garden.

Entrance Hall

Door to the front and radiator.

Downstairs W.C

Double glazed window to the front, wash hand basin, w.c and radiator.

Lounge 4.61m x 2.84m – maximum measurements

Double glazed window to the front, radiator and under stairs cupboard.

Kitchen/Diner 2.70m x 3.83m – maximum measurements

Comprising of a range of wall, base and drawer units, work surfacing with stainless steel one and a half bowl sink drainer, double glazed French doors to the rear garden, double glazed window to the rear, radiator, integrated gas hob with extractor fan over, integrated electric oven, space for washing machine, space for fridge freezer and gas comic boiler.

First Floor Landing

Includes loft hatch.

Family Bathroom

Suite comprising bath with mixer tap shower, wash hand basin, w.c, radiator and extractor fan.

Bedroom One 2.61m x 3.89m – maximum measurements

Two double glazed windows to the front, built-in wardrobe and radiator.

Bedroom Two 2.49m x 3.90m – maximum measurements

Double glazed window to the rear and radiator.

Front Garden

To the front of the property is a grass area acting as a useful bin store.

Parking

There is allocated parking for one vehicle.

Rear Garden

The rear garden is largely laid to lawn with gated rear access.

Key Features

- Augusta Park Development
- Terrace Property
- Two Double Bedrooms
- Allocated Parking
- Rear Garden

Contact Us

Towers Wills Estate Agents - Yeovil

114, Hendford Hill
Yeovil

Somerset
BA202RF

T: 01935 577032

E: info@towerswills.co.uk

Energy Efficiency

Score	Energy rating	Current	Potential
92+	A		97 A
81-91	B	83 B	
69-80	C		
55-68	D		
39-54	E		
21-38	F		
1-20	G		



Floor Plan

GROUND FLOOR

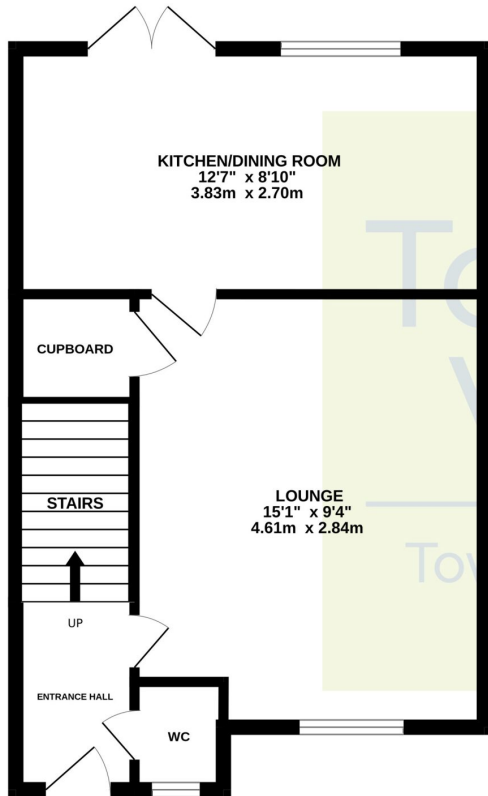

1ST FLOOR

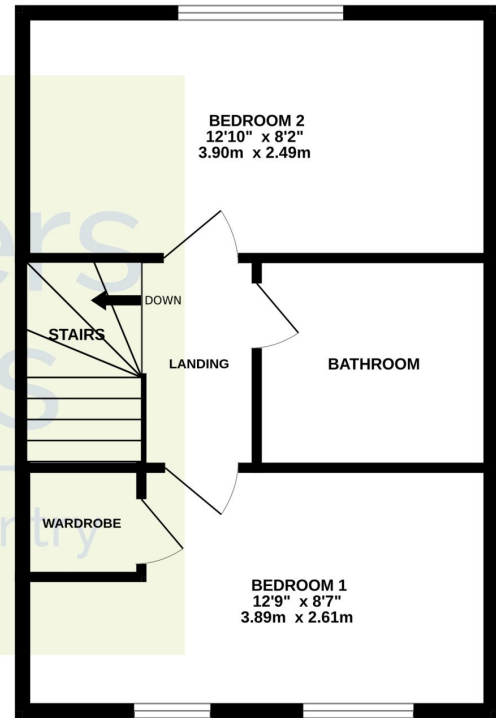

Whilst every attempt has been made to ensure the accuracy of the floorplan contained here, measurements of doors, windows, rooms and any other items are approximate and no responsibility is taken for any error, omission or mis-statement. This plan is for illustrative purposes only and should be used as such by any prospective purchaser. The services, systems and appliances shown have not been tested and no guarantee as to their operability or efficiency can be given.
Made with Metropix ©2024

Please Note No tests have been undertaken of any of the services and any intending purchasers should satisfy themselves in this regard. Towers Wills Ltd for themselves and for the vendor of this property whose agents they are, give notice that, (i) these particulars do not constitute any part of an offer or contract, (ii) all statements contained within these particulars are made without responsibility on the part of Towers Wills or the vendor, (iii) whilst made in good faith, none of the statements contained within these particulars are to be relied upon as a statement of representation or fact, (iv) any intending purchaser must satisfy him/herself by inspection or otherwise as to the correctness of each of the statements contained within these particulars, (v) the vendor does not make or give either Towers Wills or any person in their employment any authority to make or give representation or warranty whatsoever in relation to this property.

Photographs / Floor Plans Photographs are reproduced for general information and it must not be inferred that any item is included for sale with this property. Please note floor plans are not to scale and are for identification purposes only. The photographs used in these particulars may have been taken with the use of a wide angle lens. If you have any queries as to the size of the accommodation or plot, please address these with the agent prior to making an appointment to view

Towers Wills

The White House, 114 Hendford Hill, Yeovil BA20 2RF

Yeovil 01935 577032 / South Petherton 01460 298530

info@towerswills.co.uk | www.towerswills.co.uk