

# Towers Wills

Town & Country

📞 01935 577 032 | 01460 298 530 | ✉ info@towerswills.co.uk



**7, The Twines, Yeovil, Somerset BA20 2GF**

**£250,000**

Towers Wills are delighted to bring to market this well-presented semi-detached home situated in a sought-after area of Yeovil in the Bunford Heights development. Selling with no onward chain, the property was built in 2021 and benefits from circa 7 years remaining building warranty. An ideal first time buy, this modern home briefly comprises of; large rear garden, allocated parking for two cars to the front, kitchen, downstairs WC, lounge/diner, two double bedrooms and bathroom.

## Entrance Hall

Double glazed door to the front and radiator.

## Kitchen 3.68m x 2.37m

Comprising of a range of wall, base and drawer units, work surfacing with stainless steel one and a half bowl sink drainer, double glazed window to the front, low level electric heater, gas-combi boiler, space for washing machine, space for fridge freezer, integrated electric oven and integrated electric hob with extractor over.

## W.C

Double glazed window to the side, wash hand basin, w.c, radiator and extractor fan.

## Lounge/Diner 3.97m x 4.53m – maximum measurements

Double glazed French doors to the rear, double glazed window to the rear, radiator and under stairs cupboard.

## First Floor Landing

Includes loft hatch.

## Bathroom

Suite comprising bath with shower over, wash hand basin, w.c, double glazed window to the side, heated towel rail, extractor fan and shaver point.

## Bedroom One 3.17m x 4.52m – maximum measurements

Two double glazed windows to the rear and two radiators.

## Bedroom Two 3.21m x 4.53m – maximum measurements

Two double glazed windows to the front, two radiators and built-in cupboard.

## Front Garden

There is off road parking for two vehicles and side gated access to the rear garden.

## Rear Garden

The rear garden is largely laid to lawn with patio areas, outside tap and wooden shed.

## Agents Note

The vendor has advised us of a maintenance charge for Bunford Heights Estate at £25 per month.

## Key Features

- Semi-Detached House
- Well Presented Throughout
- Two Double Bedrooms
- Large Garden
- Two Allocated Parking Spaces

## Contact Us

### Towers Wills Estate Agents - Yeovil

114, Hendford Hill  
Yeovil

Somerset  
BA202RF

T: 01935 577032

E: [info@towerswills.co.uk](mailto:info@towerswills.co.uk)

## Energy Efficiency

Score	Energy rating	Current	Potential
92+	A		95 A
81-91	B	85 B	
69-80	C		
55-68	D		
39-54	E		
21-38	F		
1-20	G		





# Floor Plan

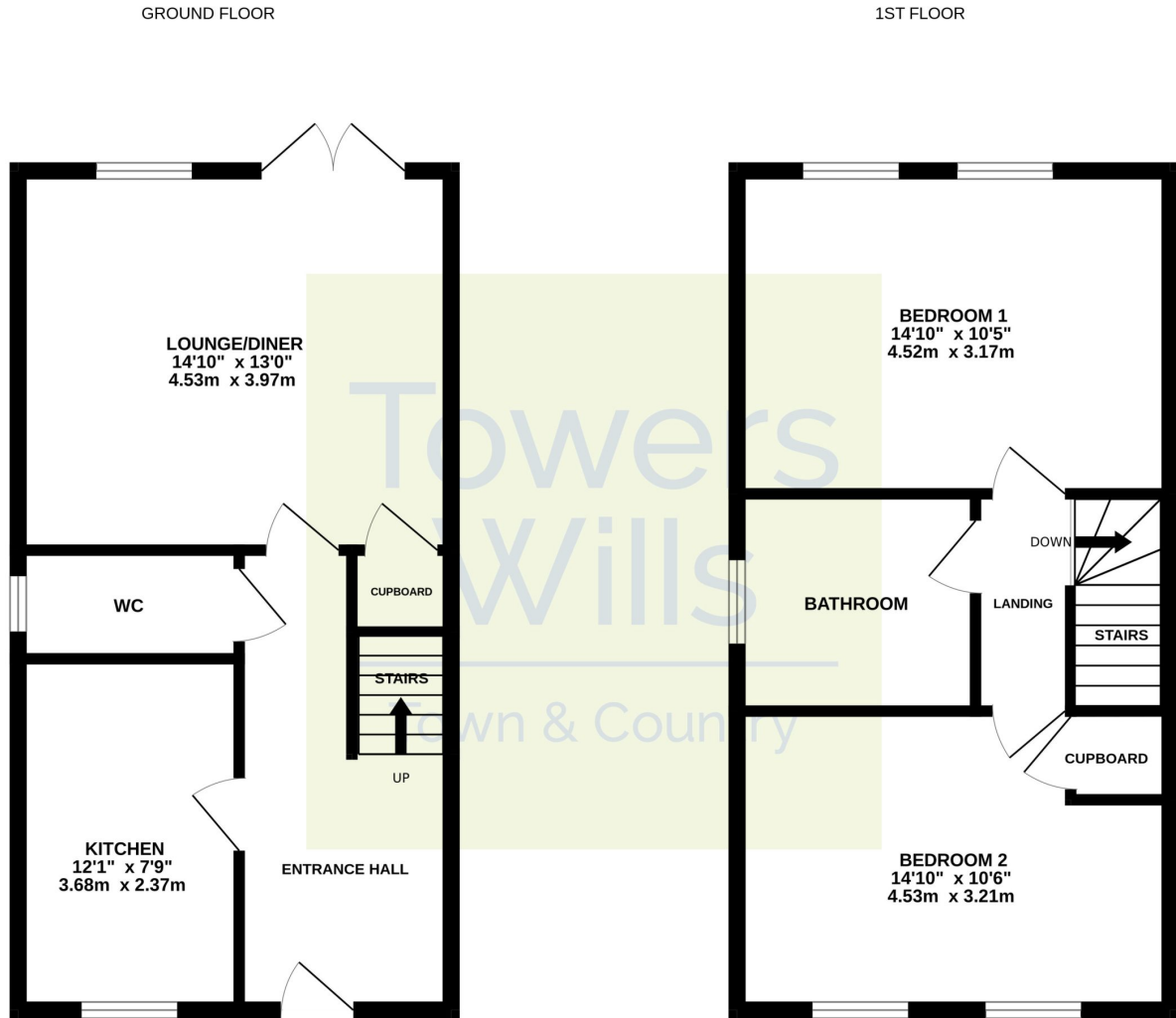

Whilst every attempt has been made to ensure the accuracy of the floorplan contained here, measurements of doors, windows, rooms and any other items are approximate and no responsibility is taken for any error, omission or mis-statement. This plan is for illustrative purposes only and should be used as such by any prospective purchaser. The services, systems and appliances shown have not been tested and no guarantee as to their operability or efficiency can be given.  
Made with Metropix ©2024

Please Note No tests have been undertaken of any of the services and any intending purchasers should satisfy themselves in this regard. Towers Wills Ltd for themselves and for the vendor of this property whose agents they are, give notice that, (i) these particulars do not constitute any part of an offer or contract, (ii) all statements contained within these particulars are made without responsibility on the part of Towers Wills or the vendor, (iii) whilst made in good faith, none of the statements contained within these particulars are to be relied upon as a statement of representation or fact, (iv) any intending purchaser must satisfy him/herself by inspection or otherwise as to the correctness of each of the statements contained within these particulars, (v) the vendor does not make or give either Towers Wills or any person in their employment any authority to make or give representation or warranty whatsoever in relation to this property.

Photographs / Floor Plans Photographs are reproduced for general information and it must not be inferred that any item is included for sale with this property. Please note floor plans are not to scale and are for identification purposes only. The photographs used in these particulars may have been taken with the use of a wide angle lens. If you have any queries as to the size of the accommodation or plot, please address these with the agent prior to making an appointment to view

**Towers Wills**

The White House, 114 Hendford Hill, Yeovil BA20 2RF

Yeovil 01935 577032 / South Petherton 01460 298530

[info@towerswills.co.uk](mailto:info@towerswills.co.uk) | [www.towerswills.co.uk](http://www.towerswills.co.uk)