

Towers Wills

Town & Country

📞 01935 577 032 | 01460 298 530 | ✉ info@towerswills.co.uk



2, Shoe Lane, Bridport, Dorset DT6 3EE

Offers Over **£170,000**

Towers Wills are pleased to bring to market this well-presented one double bedroom end of terrace house. The property briefly comprises; entrance porch, open planning kitchen/lounge, one double bedroom, modern bathroom, low maintenance rear garden and parking. Situated on the outskirts of Bridport, conveniently located within many local amenities including schools, countryside walks and supermarkets. The property would make an ideal first-time buy or buy-to-let investment. Offered with NO FORWARD CHAIN.

Entrance Porch

Double glazed composite door to front, double glazed window to side and storage cupboard.

Open Planned Living Space 13'7 x 12'8

Double glazed patio doors leading to garden, infrared electric panel heater, stairs to first floor, understairs cupboard

Kitchen 6'6 x 5'10

A modern fitted kitchen comprising; a mixture of wall, base and draw units, stainless steel sink with drainer, integrated electric oven with four ring gas hob, space for washing machine, tiled walls and double glazed window to front.

Master Bedroom 13'9 x 7'7

Double glazed window to side, infrared electric panel heater, fitted housing (Housing a gas combination boiler).

Bathroom 7'7 x 6'0

A white bathroom suite comprising; P shaped bath with shower over, wash hand basin, W/C, tiled floor and walls, wall unit and double glazed window to front.

Garden

Leading from the patio's doors, outside you will find a low maintenance landscaped garden which is mainly laid to gravel with an area of artificial grass and decking area.

Key Features

- End of Terrace House
- One Double Bedroom
- Recently renovated throughout
- Off Road Parking
- Low Maintenance Rear Garden
- No Forward Chain

Contact Us

Towers Wills Estate Agents - Yeovil

114, Hendford Hill

Yeovil

Somerset

BA202RF

T: 01935 577032

E: info@towerswills.co.uk

Energy Efficiency



Floor Plan

GROUND FLOOR

1ST FLOOR

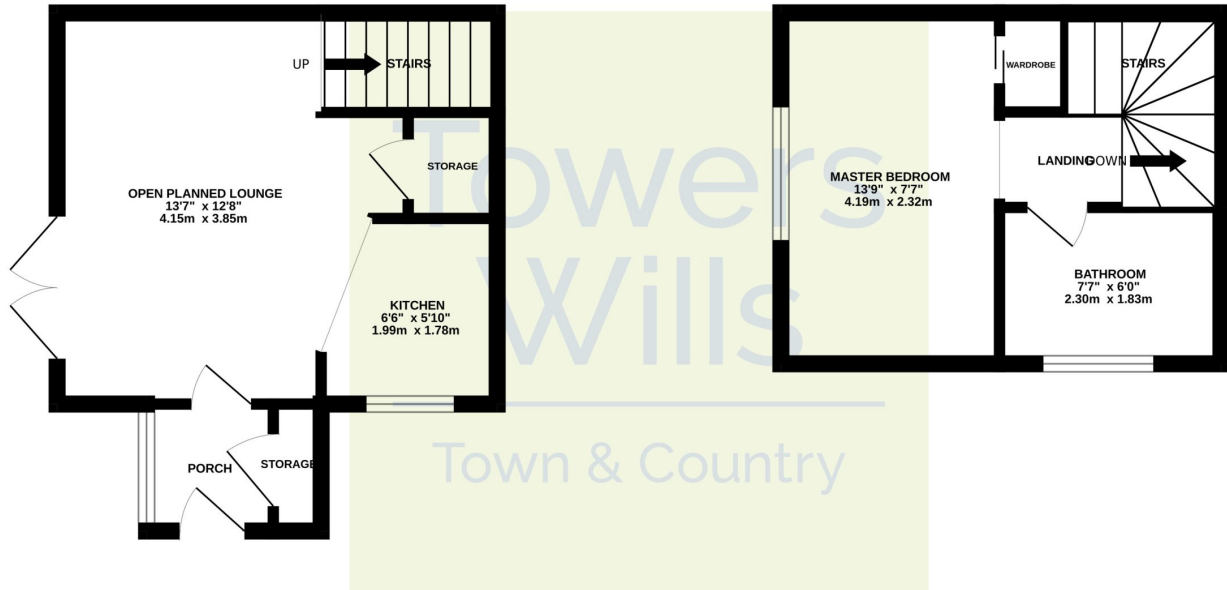

Whilst every attempt has been made to ensure the accuracy of the floorplan contained here, measurements of doors, windows, rooms and any other items are approximate and no responsibility is taken for any error, omission or mis-statement. This plan is for illustrative purposes only and should be used as such by any prospective purchaser. The services, systems and appliances shown have not been tested and no guarantee as to their operability or efficiency can be given.
Made with Metropix ©2024

Please Note No tests have been undertaken of any of the services and any intending purchasers should satisfy themselves in this regard. Towers Wills Ltd for themselves and for the vendor of this property whose agents they are, give notice that, (i) these particulars do not constitute any part of an offer or contract, (ii) all statements contained within these particulars are made without responsibility on the part of Towers Wills or the vendor, (iii) whilst made in good faith, none of the statements contained within these particulars are to be relied upon as a statement of representation or fact, (iv) any intending purchaser must satisfy him/herself by inspection or otherwise as to the correctness of each of the statements contained within these particulars, (v) the vendor does not make or give either Towers Wills or any person in their employment any authority to make or give representation or warranty whatsoever in relation to this property.

Photographs / Floor Plans Photographs are reproduced for general information and it must not be inferred that any item is included for sale with this property. Please note floor plans are not to scale and are for identification purposes only. The photographs used in these particulars may have been taken with the use of a wide angle lens. If you have any queries as to the size of the accommodation or plot, please address these with the agent prior to making an appointment to view

Towers Wills

The White House, 114 Hendford Hill, Yeovil BA20 2RF

Yeovil 01935 577032 / South Petherton 01460 298530

info@towerswills.co.uk | www.towerswills.co.uk