

# Towers Wills

Town & Country

📞 01935 577 032 | 01460 298 530 | ✉ info@towerswills.co.uk



24, Derwent Way, Yeovil, Somerset BA21 3SZ

**£220,000**

Towers Wills welcome to the market this two bedroom end of terrace property, occupying a generous corner position and situated in a quiet cul-de-sac position within Abbey Manor Park. The property briefly comprising; porch, reception hallway, lounge/diner, kitchen, two bedrooms, bathroom, driveway and front, side and rear gardens.

### **Porch**

Double glazed door and window to the front.

### **Reception Hallway**

With double glazed door to the front and radiator.

### **Lounge/Diner**

With double glazed window to the side, double glazed patio doors opening to the rear garden and radiator.

### **Kitchen**

Comprising of a range of wall, base and drawer units, work surfacing with inset sink/drainers, integrated electric oven, integrated electric hob with cookerhood over, space for under counter fridge and freezer, space and plumbing for washing machine, central heating boiler and double glazed window to the front.

### **First Floor Landing**

#### **Bedroom One**

Double glazed window to the rear and radiator.

#### **Bedroom Two**

Double glazed window to the front, radiator and over stairs storage cupboard.

#### **Bathroom**

Suite comprising of bath with mixer shower over, wash hand basin, w.c, tiling, radiator and window to the side.

#### **Rear Garden**

The property benefits from a particularly generous corner position. The rear garden being majority laid to lawn with planted borders, patio area with sheltered lean-to/ pergola over and gated side access.

#### **Front Garden**

To the front of the property is a driveway providing off road parking and an area laid to lawn.

## **Key Features**

- Popular Abbey Manor Park
- End of Terrace
- Generous Corner Plot
- Two Bedrooms
- Driveway
- Gardens

## **Contact Us**

### **Towers Wills Estate Agents - Yeovil**

114, Hendford Hill

Yeovil

Somerset

BA202RF

T: 01935 577032

E: [info@towerswills.co.uk](mailto:info@towerswills.co.uk)



# Floor Plan

GROUND FLOOR

1ST FLOOR

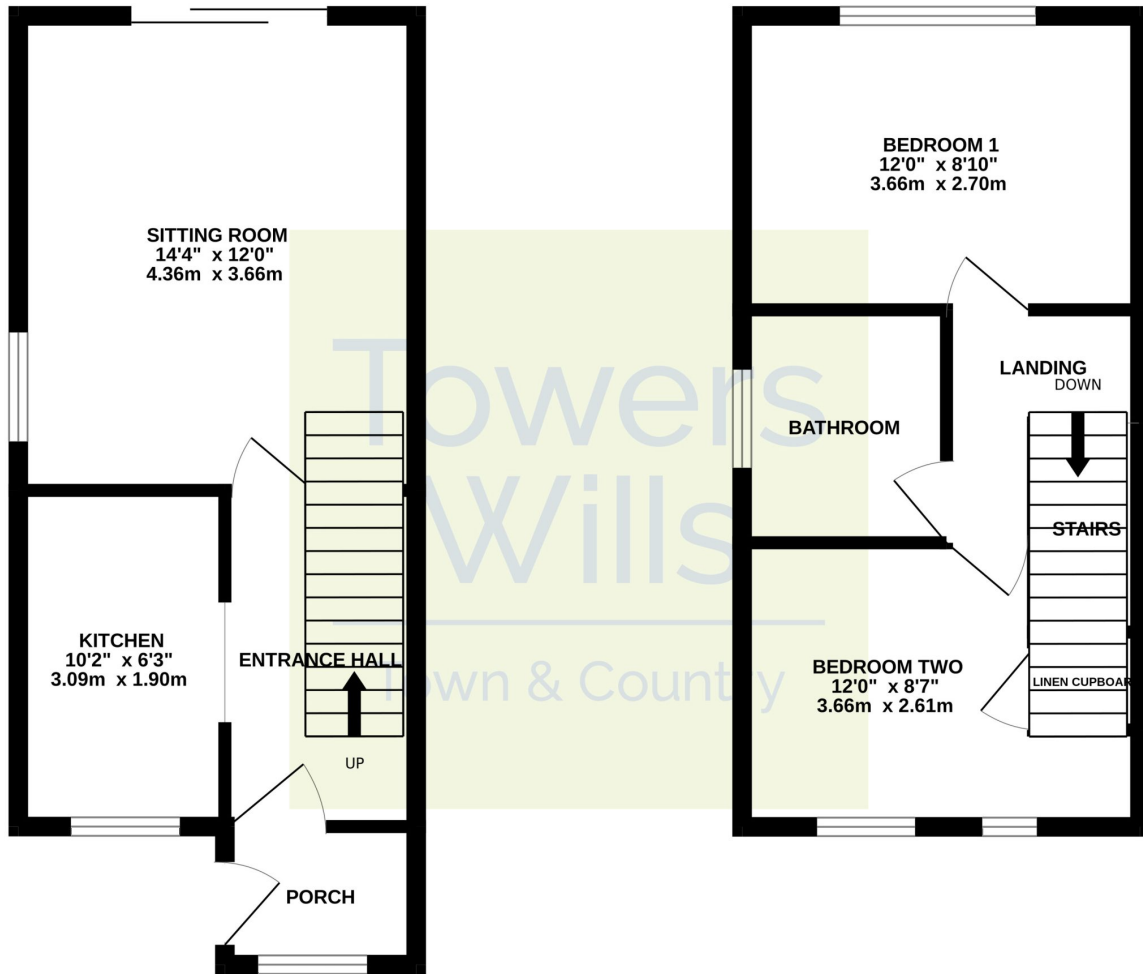

Whilst every attempt has been made to ensure the accuracy of the floorplan contained here, measurements of doors, windows, rooms and any other items are approximate and no responsibility is taken for any error, omission or mis-statement. This plan is for illustrative purposes only and should be used as such by any prospective purchaser. The services, systems and appliances shown have not been tested and no guarantee as to their operability or efficiency can be given.  
Made with Metropix ©2024

Please Note No tests have been undertaken of any of the services and any intending purchasers should satisfy themselves in this regard. Towers Wills Ltd for themselves and for the vendor of this property whose agents they are, give notice that, (i) these particulars do not constitute any part of an offer or contract, (ii) all statements contained within these particulars are made without responsibility on the part of Towers Wills or the vendor, (iii) whilst made in good faith, none of the statements contained within these particulars are to be relied upon as a statement of representation or fact, (iv) any intending purchaser must satisfy him/herself by inspection or otherwise as to the correctness of each of the statements contained within these particulars, (v) the vendor does not make or give either Towers Wills or any person in their employment any authority to make or give representation or warranty whatsoever in relation to this property.

Photographs / Floor Plans Photographs are reproduced for general information and it must not be inferred that any item is included for sale with this property. Please note floor plans are not to scale and are for identification purposes only. The photographs used in these particulars may have been taken with the use of a wide angle lens. If you have any queries as to the size of the accommodation or plot, please address these with the agent prior to making an appointment to view

**Towers Wills**

The White House, 114 Hendford Hill, Yeovil BA20 2RF

Yeovil 01935 577032 / South Petherton 01460 298530

[info@towerswills.co.uk](mailto:info@towerswills.co.uk) | [www.towerswills.co.uk](http://www.towerswills.co.uk)