



78, Nelson Way, Yeovil, Somerset BA21 5DT

Offers Over **£137,000**

Towers Wills are pleased to offer to market this well-presented first floor apartment situated in the popular Wyndham Park Development benefitting from a new carpets, new bathroom and allocated parking. The property comprises; entrance hall, two double bedrooms with master en-suite, newly fitted bathroom and open plan kitchen/lounge area with balcony access and far-reaching countryside views. Ideal for a First Time Buyer or Investor.

Description

Towers Wills are pleased to offer to market this well-presented first floor apartment situated in the popular Wyndham Park Development benefitting from a new carpets, new bathroom and allocated parking. The property comprises; entrance hall, two double bedrooms with master en-suite, newly fitted bathroom and open plan kitchen/lounge area with balcony access and far-reaching countryside views. Ideal for a First Time Buyer or Investor.

Ground floor Communal Entrance

With stairs leading to the first floor.

Entrance Hall

Double glazed window to the rear, door to communal hallway, radiator, intercom and two storage cupboards.

Open Plan Kitchen/Lounge 4.49m x 5.86m

Double glazed patio doors leading to the balcony at the front of the property, radiator and double-glazed window to the rear.

Kitchen Area

Comprising of a range of wall, base and drawer units, work surfacing with stainless steel one bowl sink drainer, integrated gas hob with cooker hood over, integrated electric oven, radiator, extractor fan, integrated dishwasher, integrated fridge, integrated freezer, integrated washer/dryer and gas central heating boiler.

Bedroom One 3.03 x 4.54m

Double glazed window to the front and radiator.

En-suite

Suite comprising shower cubicle, wash hand basin, W/C, heated towel rail, extractor fan and shaver point.

Bedroom Two 3.53m x 2.63m

Double glazed window to the front and radiator.

Bathroom

Suite comprising bath with shower over, W/C, wash hand basin with vanity unit, double glazed window to side, heated towel rail, extractor fan and shaver point.

Outside

The property has one allocated car parking space.

Agents Notes

The vendor has advised that the most recent fees for the property were:
Ground rent: Approx £400 per annum
Service Charge: Approx £1600 per annum
The property is selling with c. 112 years remaining on the lease.

Key Features

- Well Presented Throughout
- First Floor Flat
- Popular Wyndham Park Development
- Allocated Parking
- Two Double Bedrooms

Contact Us

Towers Wills Estate Agents - Yeovil
114, Hendford Hill
Yeovil
Somerset
BA202RF
T: 01935 577032
E: info@towerswills.co.uk

Energy Efficiency

Score	Energy rating	Current	Potential
92+	A		
81-91	B		
69-80	C	80 C	80 C
55-68	D		
39-54	E		
21-38	F		
1-20	G		



Floor Plan

FIRST FLOOR

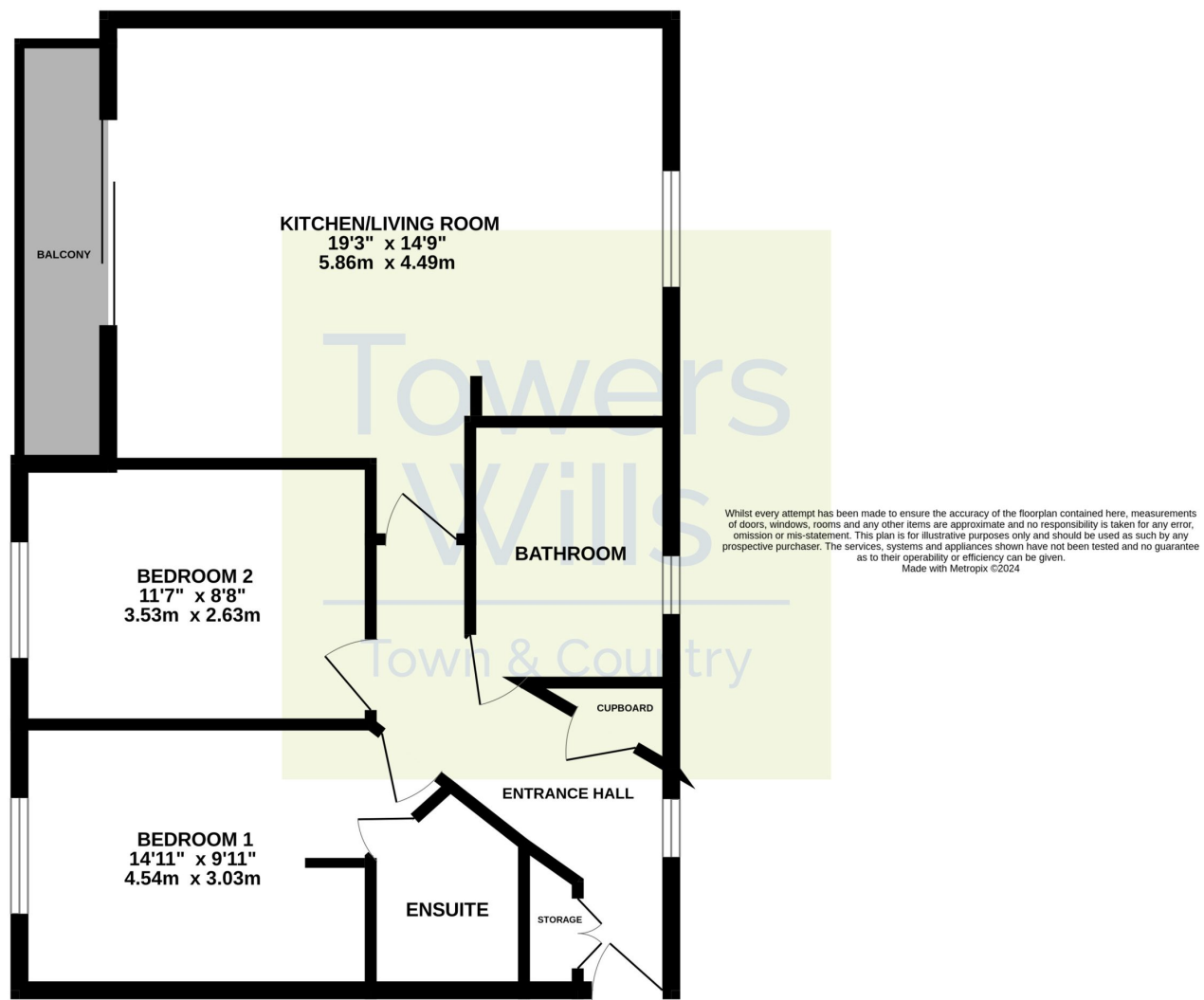

Please Note No tests have been undertaken of any of the services and any intending purchasers should satisfy themselves in this regard. Towers Wills Ltd for themselves and for the vendor of this property whose agents they are, give notice that, (i) these particulars do not constitute any part of an offer or contract, (ii) all statements contained within these particulars are made without responsibility on the part of Towers Wills or the vendor , (iii) whilst made in good faith, none of the statements contained within these particulars are to be relied upon as a statement of representation or fact , (iv) any intending purchaser must satisfy him/herself by inspection or otherwise as to the correctness of each of the statements contained within these particulars, (v) the vendor does not make or give either Towers Wills or any person in their employment any authority to make or give representation or warranty whatsoever in relation to this property.

Photographs / Floor Plans Photographs are reproduced for general information and it must not be inferred that any item is included for sale with this property. Please note floor plans are not to scale and are for identification purposes only. The photographs used in these particulars may have been taken with the use of a wide angle lens. If you have any queries as to the size of the accommodation or plot, please address these with the agent prior to making an appointment to view

Towers Wills

The White House, 114 Hendford Hill, Yeovil BA20 2RF

Yeovil 01935 577032 / South Petherton 01460 298530

info@towerswills.co.uk | www.towerswills.co.uk