

Towers Wills

Town & Country

📞 01935 577 032 | 01460 298 530 | ✉ info@towerswills.co.uk



108, Thatcham Park, Yeovil, Somerset BA21 3BP

£220,000

Towers Wills are pleased to present this three-bed terraced home situated within a cul-de-sac and benefiting from off-road parking, garage, kitchen with breakfast bar opening to lounge/diner, three bedrooms and bathroom. Selling with no onward chain, please contact Towers Wills to arrange a viewing.

Entrance Hall

Double glazed door and window to the front, radiator and cupboard.

Kitchen 2.97m x 3.08m

Comprising of a range of wall, base and drawer units, work surfacing with stainless steel one bowl sink drainer, double glazed window to the front, radiator, space for washing machine, space for fridge freezer, integrated gas hob with extractor over, integrated electric oven and breakfast bar leading to the lounge/diner.

Lounge/Diner 4.81m plus door recess x 4.86m – maximum measurements

Double glazed windows and door to the rear garden, radiator, gas fireplace, gas back-boiler and breakfast bar opening to the kitchen area.

First Floor Landing

Airing cupboard including tank and loft hatch.

Bathroom 2.31m x 1.86m

Suite comprising bath with mixer tap shower, wash hand basin, w.c, double glazed window to the front and radiator.

Bedroom One 3.24m x 2.95m

Double glazed window to the front, radiator and built-in wardrobe.

Bedroom Two 3.57m x 2.74m

Double glazed window to the rear, radiator and built-in wardrobe.

Bedroom Three 2.63m x 2.06m

Double glazed window to the rear and radiator.

Front Garden

The front garden is largely laid to lawn with path to the front door.

Rear Garden

To rear garden is largely laid to lawn with patio area and gated rear access.

Garage in a Block 4.71m x 2.28m

With 'up and over' door.

Key Features

- Terrace Property
- Three Bedrooms
- Cul-de-sac Position
- Off Road Parking
- Garage
- Rear Garden
- NO ONWARD CHAIN

Contact Us

Towers Wills Estate Agents - Yeovil

114, Hendford Hill

Yeovil

Somerset

BA202RF

T: 01935 577032

E: info@towerswills.co.uk



Floor Plan

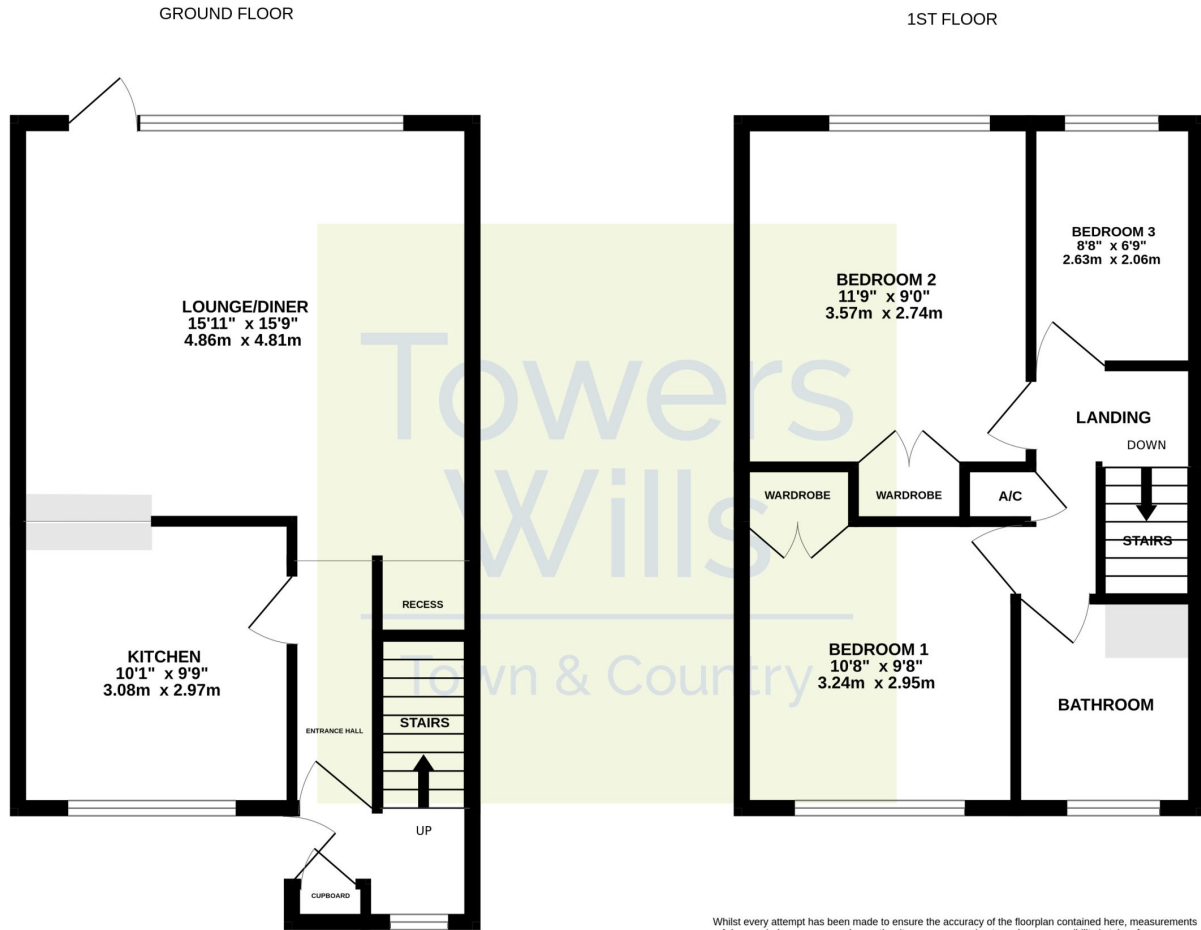

Whilst every attempt has been made to ensure the accuracy of the floorplan contained here, measurements of doors, windows, rooms and any other items are approximate and no responsibility is taken for any error, omission or mis-statement. This plan is for illustrative purposes only and should be used as such by any prospective purchaser. The services, systems and appliances shown have not been tested and no guarantee as to their operability or efficiency can be given.
Made with Metropix ©2025

Please Note No tests have been undertaken of any of the services and any intending purchasers should satisfy themselves in this regard. Towers Wills Ltd for themselves and for the vendor of this property whose agents they are, give notice that, (i) these particulars do not constitute any part of an offer or contract, (ii) all statements contained within these particulars are made without responsibility on the part of Towers Wills or the vendor, (iii) whilst made in good faith, none of the statements contained within these particulars are to be relied upon as a statement of representation or fact, (iv) any intending purchaser must satisfy him/herself by inspection or otherwise as to the correctness of each of the statements contained within these particulars, (v) the vendor does not make or give either Towers Wills or any person in their employment any authority to make or give representation or warranty whatsoever in relation to this property.

Photographs / Floor Plans Photographs are reproduced for general information and it must not be inferred that any item is included for sale with this property. Please note floor plans are not to scale and are for identification purposes only. The photographs used in these particulars may have been taken with the use of a wide angle lens. If you have any queries as to the size of the accommodation or plot, please address these with the agent prior to making an appointment to view

Towers Wills

The White House, 114 Hendford Hill, Yeovil BA20 2RF

Yeovil 01935 577032 / South Petherton 01460 298530

info@towerswills.co.uk | www.towerswills.co.uk