

Towers Wills

Town & Country

📞 01935 577 032 | 01460 298 530 | ✉ info@towerswills.co.uk



17, Watling Street, Yeovil, Somerset BA21 3UF

£125,000

Towers Wills welcome to market this well-presented ground floor apartment. Selling with no onward chain, the property benefits from carport/off-road parking, two double bedrooms with master ensuite, main bathroom, kitchen and lounge/diner.

Entrance door leading into the hall.

Hall

With airing cupboard housing the hot water cylinder, and night storage heater.

Lounge/Diner 3.71m x 5.45m

A light dual aspect room with outlook to the front and rear, feature electric fire with surround and night storage heater.

Kitchen 1.94m x 3.19m

Fitted with a pattern effect worktop and timber effect doors. A sink drainer unit with mixer tap, a four ring electric hob with oven under and extractor over, plumbing for washing machine, space for fridge freezer and window with outlook to the side.

Bedroom One 2.91m x 3.95m

A dual aspect room with outlook to the front and side, built in wardrobe and electric panel heater.

En-suite 1.51m x 2.06m

With shower, wash hand basin, WC, extractor fan, electric heated towel rail and window with outlook to the side.

Bedroom Two 2.47m x 3.97m

With window outlook to the front and electric panel heater.

Bathroom 2.01m x 2.45m

A white suite fitted with panel bath, shower over and part tiled walls, wash hand basin, WC, electric towel rail and window with outlook to the side.

Parking

A car port provides off road parking.

Agents Note:

Our vendor has advised Towers Wills of the following charges:

Ground Rent: £60 pa.

Service Charge: £2459 pa.

Approx. 951 Years remain on the lease.

Key Features

- Well Presented
- Ground Floor Flat
- Two Bedrooms
- Master En-suite
- NO ONWARD CHAIN

Contact Us

Towers Wills Estate Agents - Yeovil
114, Hendford Hill
Yeovil
Somerset
BA202RF
T: 01935 577032
E: info@towerswills.co.uk

Energy Efficiency

| Score | Energy rating | Current | Potential |
|-------|---------------|---------|-----------|
| 92+ | A | | |
| 81-91 | B | | |
| 69-80 | C | | 73 C |
| 55-68 | D | 68 D | |
| 39-54 | E | | |
| 21-38 | F | | |
| 1-20 | G | | |



Floor Plan

GROUND FLOOR

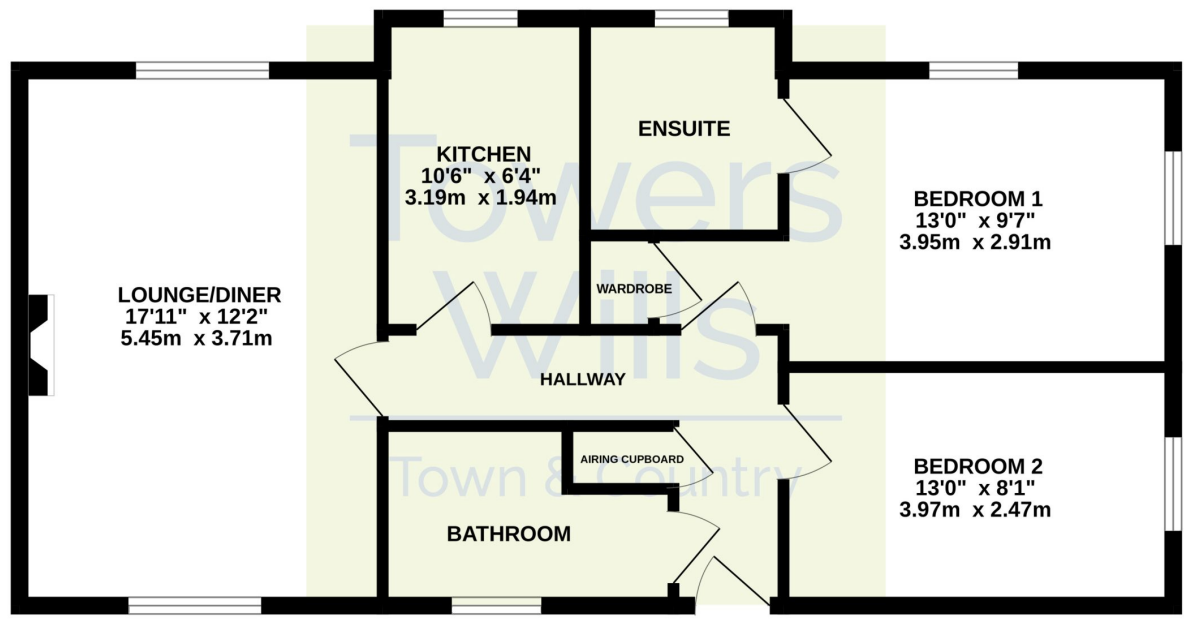

Whilst every attempt has been made to ensure the accuracy of the floorplan contained here, measurements of doors, windows, rooms and any other items are approximate and no responsibility is taken for any error, omission or mis-statement. This plan is for illustrative purposes only and should be used as such by any prospective purchaser. The services, systems and appliances shown have not been tested and no guarantee as to their operability or efficiency can be given.
Made with Metropix ©2025

Please Note No tests have been undertaken of any of the services and any intending purchasers should satisfy themselves in this regard. Towers Wills Ltd for themselves and for the vendor of this property whose agents they are, give notice that, (i) these particulars do not constitute any part of an offer or contract, (ii) all statements contained within these particulars are made without responsibility on the part of Towers Wills or the vendor , (iii) whilst made in good faith, none of the statements contained within these particulars are to be relied upon as a statement of representation or fact , (iv) any intending purchaser must satisfy him/herself by inspection or otherwise as to the correctness of each of the statements contained within these particulars, (v) the vendor does not make or give either Towers Wills or any person in their employment any authority to make or give representation or warranty whatsoever in relation to this property.

Photographs / Floor Plans Photographs are reproduced for general information and it must not be inferred that any item is included for sale with this property. Please note floor plans are not to scale and are for identification purposes only. The photographs used in these particulars may have been taken with the use of a wide angle lens. If you have any queries as to the size of the accommodation or plot, please address these with the agent prior to making an appointment to view

Towers Wills

The White House, 114 Hendford Hill, Yeovil BA20 2RF

Yeovil 01935 577032 / South Petherton 01460 298530

info@towerswills.co.uk | www.towerswills.co.uk