

Towers Wills

Town & Country

📞 01935 577 032 | 01460 298 530 | ✉ info@towerswills.co.uk



40, Nelson Way, Yeovil, Somerset BA21 5DT

£235,000

Towers Wills are delighted to present this immaculate end of terrace home, situated on the popular Wyndham Park Estate, and briefly comprises of; parking for two vehicles, downstairs w.c, large open plan kitchen/diner, good size lounge with bay fronted window, three bedrooms with master en-suite and dressing area, family bathroom and delightful south facing rear garden, offering uninterrupted views of nearby countryside. Please contact Towers Wills for further information and to arrange a viewing.

Entrance Hall

Double glazed door to the front and radiator.

Lounge 5.30m x 3.69m

Double glazed window to the front and radiator.

W.C 1.67m x 0.91m

Includes wash hand basin, w.c, radiator and extractor fan.

Kitchen/Diner 4.44m x 4.73m – maximum measurements

Comprising of a range of wall, base and drawer units, work surfacing with sink/drain, two radiators, double glazed window to the rear, double glazed French doors to the rear garden, space for fridge freezer, integrated gas hob with extractor over, integrated electric oven, space for dishwasher, space for washing machine and gas combi boiler.

First Floor Landing

Includes loft hatch and built-in cupboard.

Bathroom

Suite comprising bath, wash hand basin, w.c, shaver point, extractor fan, double glazed window to the side and radiator.

Bedroom One 3.33m x 2.87m – maximum measurements

Double glazed window to the rear, radiator and archway to the dressing area.

Dressing Area 1.64m x 1.78m

Double glazed window to the rear and radiator.

En-suite

Suite comprising shower cubicle, wash hand basin, w.c, radiator, shaver point and extractor fan.

Bedroom Two 3.73m x 2.47m – maximum measurements

Double glazed window to the front and radiator.

Bedroom Three 2.38m x 2.19m – maximum measurements

Double glazed window to the front and radiator.

Parking

To the front is allocated parking for two vehicles.

Rear Garden

To the rear the garden is largely laid to lawn with wooden shed, outside tap and gated side access.

Agents Note

The vendor has advised us of a maintenance charge for the Wyndham Park Estate, at approximately £56 per 6 months.

Key Features

- Immaculately Presented
- Popular Wyndham Park Estate
- Three Bedrooms
- Master En-suite & Dressing Area
- South Facing Garden
- Off Road Parking

Contact Us

Towers Wills Estate Agents - Yeovil

114, Hendford Hill
Yeovil

Somerset
BA202RF

T: 01935 577032

E: info@towerswills.co.uk



Floor Plan

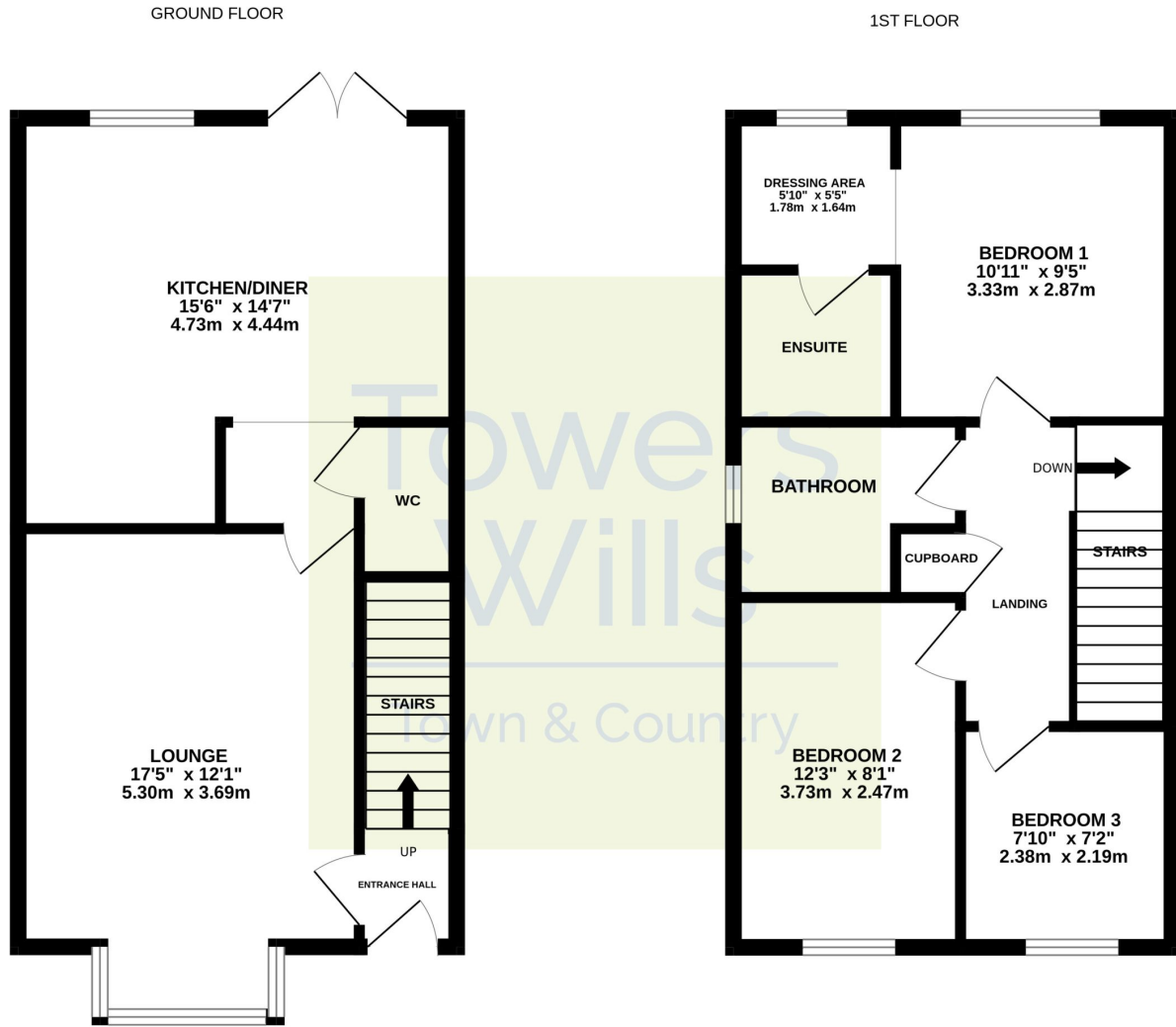

Whilst every attempt has been made to ensure the accuracy of the floorplan contained here, measurements of doors, windows, rooms and any other items are approximate and no responsibility is taken for any error, omission or mis-statement. This plan is for illustrative purposes only and should be used as such by any prospective purchaser. The services, systems and appliances shown have not been tested and no guarantee as to their operability or efficiency can be given.
Made with Metropix ©2025

Please Note No tests have been undertaken of any of the services and any intending purchasers should satisfy themselves in this regard. Towers Wills Ltd for themselves and for the vendor of this property whose agents they are, give notice that, (i) these particulars do not constitute any part of an offer or contract, (ii) all statements contained within these particulars are made without responsibility on the part of Towers Wills or the vendor, (iii) whilst made in good faith, none of the statements contained within these particulars are to be relied upon as a statement of representation or fact, (iv) any intending purchaser must satisfy him/herself by inspection or otherwise as to the correctness of each of the statements contained within these particulars, (v) the vendor does not make or give either Towers Wills or any person in their employment any authority to make or give representation or warranty whatsoever in relation to this property.

Photographs / Floor Plans Photographs are reproduced for general information and it must not be inferred that any item is included for sale with this property. Please note floor plans are not to scale and are for identification purposes only. The photographs used in these particulars may have been taken with the use of a wide angle lens. If you have any queries as to the size of the accommodation or plot, please address these with the agent prior to making an appointment to view

Towers Wills

The White House, 114 Hendford Hill, Yeovil BA20 2RF

Yeovil 01935 577032 / South Petherton 01460 298530

info@towerswills.co.uk | www.towerswills.co.uk