



84c, West Coker Road, Yeovil, Somerset BA20 2JG

£325,000

Towers Wills are pleased to welcome to market, this spacious two bedroom semi-detached bungalow, situated in a popular area of Yeovil and close to many local amenities. The property briefly comprises; entrance porch, entrance hall including door to garage, lounge/diner, kitchen, conservatory, two double bedrooms, wet room with walk-in shower, enclosed rear garden and garage.

Entrance Porch

Double glazed door to the front, double glazed window to the front and door leading to the hallway.

Entrance Hall

With internal door to garage, storage cupboard, radiator and loft hatch.

Lounge/Diner 5.64m x 4.10m

Double glazed patio doors leading to conservatory, feature electric fireplace, radiator, coved ceiling and space for dining table and chair set.

Conservatory 6.02m x 3.55m

Double glazed patio doors from the lounge, double glazed patio doors to the garden, wall mounted electric radiator and radiator.

Kitchen 2.94m x 4.48m

Comprising of a range of wall, base and drawer units, work surfacing with stainless steel single drainer, space for freestanding oven, space for washing machine, space for fridge freezer, laminate flooring, coved ceiling, double glazed window to the rear, part tiled and radiator.

Bedroom One 4.27m x 3.38m

Double glazed window to the front, coved ceiling and radiator.

Bedroom Two 5.49m x 2.77m

Double glazed windows to the rear and side, coved ceiling and radiator.

Wet Room 1.99m x 1.76m

Comprising walk-in double shower, wash hand basin, w.c, coved ceiling, extractor fan, radiator and double glazed frosted window to the front.

Garden

There is an enclosed rear garden, being mainly laid to lawn with a patio seating area and side access leading to the front of the property.

Garage 5.29m x 3.00m

With 'up and over' door, wall mounted boiler, power, light and double glazed window to the side.

Key Features

- Popular Location
- Semi-Detached Bungalow
- Two Bedrooms
- Garage
- Rear Garden
- NO ONWARD CHAIN

Contact Us

Towers Wills Estate Agents - Yeovil

114, Hendford Hill

Yeovil

Somerset

BA202RF

T: 01935 577032

E: info@towerswills.co.uk



Floor Plan

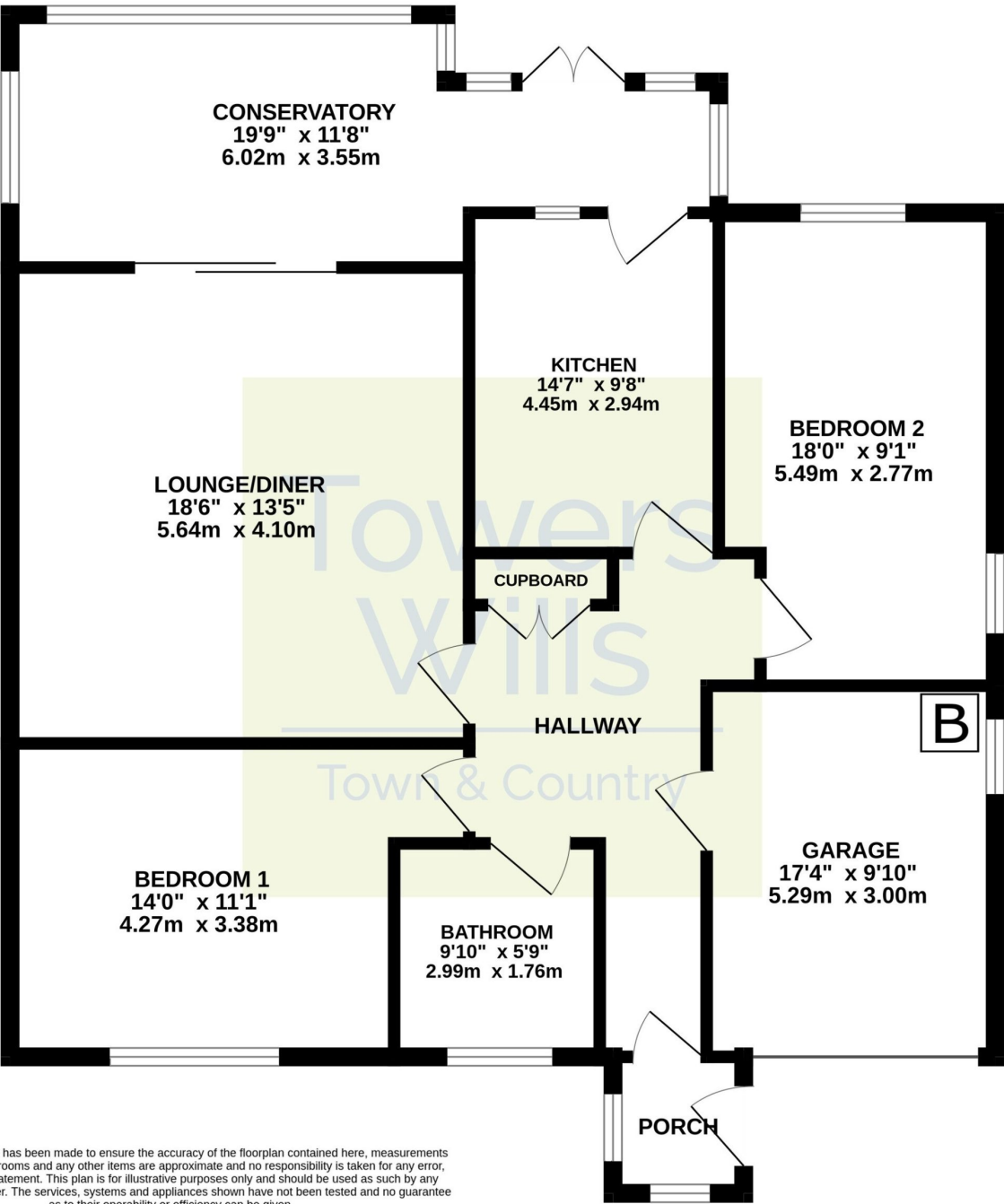

Whilst every attempt has been made to ensure the accuracy of the floorplan contained here, measurements of doors, windows, rooms and any other items are approximate and no responsibility is taken for any error, omission or mis-statement. This plan is for illustrative purposes only and should be used as such by any prospective purchaser. The services, systems and appliances shown have not been tested and no guarantee as to their operability or efficiency can be given.
Made with Metropix ©2025

Please Note No tests have been undertaken of any of the services and any intending purchasers should satisfy themselves in this regard. Towers Wills Ltd for themselves and for the vendor of this property whose agents they are, give notice that, (i) these particulars do not constitute any part of an offer or contract, (ii) all statements contained within these particulars are made without responsibility on the part of Towers Wills or the vendor , (iii) whilst made in good faith, none of the statements contained within these particulars are to be relied upon as a statement of representation or fact , (iv) any intending purchaser must satisfy him/herself by inspection or otherwise as to the correctness of each of the statements contained within these particulars, (v) the vendor does not make or give either Towers Wills or any person in their employment any authority to make or give representation or warranty whatsoever in relation to this property.

Photographs / Floor Plans Photographs are reproduced for general information and it must not be inferred that any item is included for sale with this property. Please note floor plans are not to scale and are for identification purposes only. The photographs used in these particulars may have been taken with the use of a wide angle lens. If you have any queries as to the size of the accommodation or plot, please address these with the agent prior to making an appointment to view