

Towers Wills

Town & Country

📞 01935 577 032 | 01460 298 530 | ✉ info@towerswills.co.uk



6, Hendford Grove, Yeovil, Somerset BA20 1UT

£230,000

Towers Wills are pleased to welcome to the market this three bedroom semi-detached home, situated a stones throw away from the popular high street of Yeovil and Ninesprings Country Park. The property is well presented throughout and would be perfect for first time buyers or investment. The accommodation briefly comprises; entrance hall, lounge, dining room, kitchen, family bathroom, three bedrooms and landscaped rear garden.

Entrance Porch

Hallway

Double glazed door to front, stairs rise to the first floor with door to the living room, door to dining room and a radiator.

Living Room 3.50m x 3.12m

Double glazed bay window to the front, luxury vinyl flooring by Karndean, coving and radiator.

Dining Room 3.69m x 3.50m

Double glazed window to rear, under stairs cupboard, access through to kitchen, coving and radiator.

Kitchen 4.30m x 2.90m

A modern fitted kitchen comprising of a range of wall, base and drawer units, work surfacing with inset sink drainer, breakfast bar, Zanussi electric oven, four ring gas hob and cookerhood over, space for freestanding fridge/freezer, space and plumbing for washing machine/dishwasher, double glazed door to side leading to rear and double glazed door to rear leading to garden.

First Floor Landing

Access to first floor accommodation and loft hatch leading to good sized insulated and part floored loft.

Bedroom One 3.14m x 4.59m

Two double glazed windows to the front, carpet and radiator.

Bedroom Two 3.48m x 2.78m

Double glazed window to the rear, carpet and radiator.

Bedroom Three 2.77m x 2.71m

Double glazed window to rear, carpet and radiator.

Family Bathroom 1.77m x 2.05m

A recently refurbished and installed suite comprising of bath with shower over, wash hand basin, W.C, radiator and fully tiled surround.

Front Garden

To the front there is a pedestrian gate leading to concrete area in front of the house.

Rear Garden

Abutting the rear is a patio area, perfect for entertaining and enjoying the summer rays. The remaining garden is laid to lawn with fence borders.

Agents Note

You have a right across the neighbouring property for side access.

Key Features

- Semi Detached
- Three Bedrooms
- Walking Distance to Town Centre & Hospital
- Landscaped Garden

Contact Us

Towers Wills Estate Agents - Yeovil
114, Hendford Hill
Yeovil
Somerset
BA202RF
T: 01935 577032
E: info@towerswills.co.uk

Energy Efficiency

Score	Energy rating	Current	Potential
92+	A		
81-91	B		82 B
69-80	C		
55-68	D	56 D	
39-54	E		
21-38	F		
1-20	G		



Floor Plan

GROUND FLOOR

1ST FLOOR

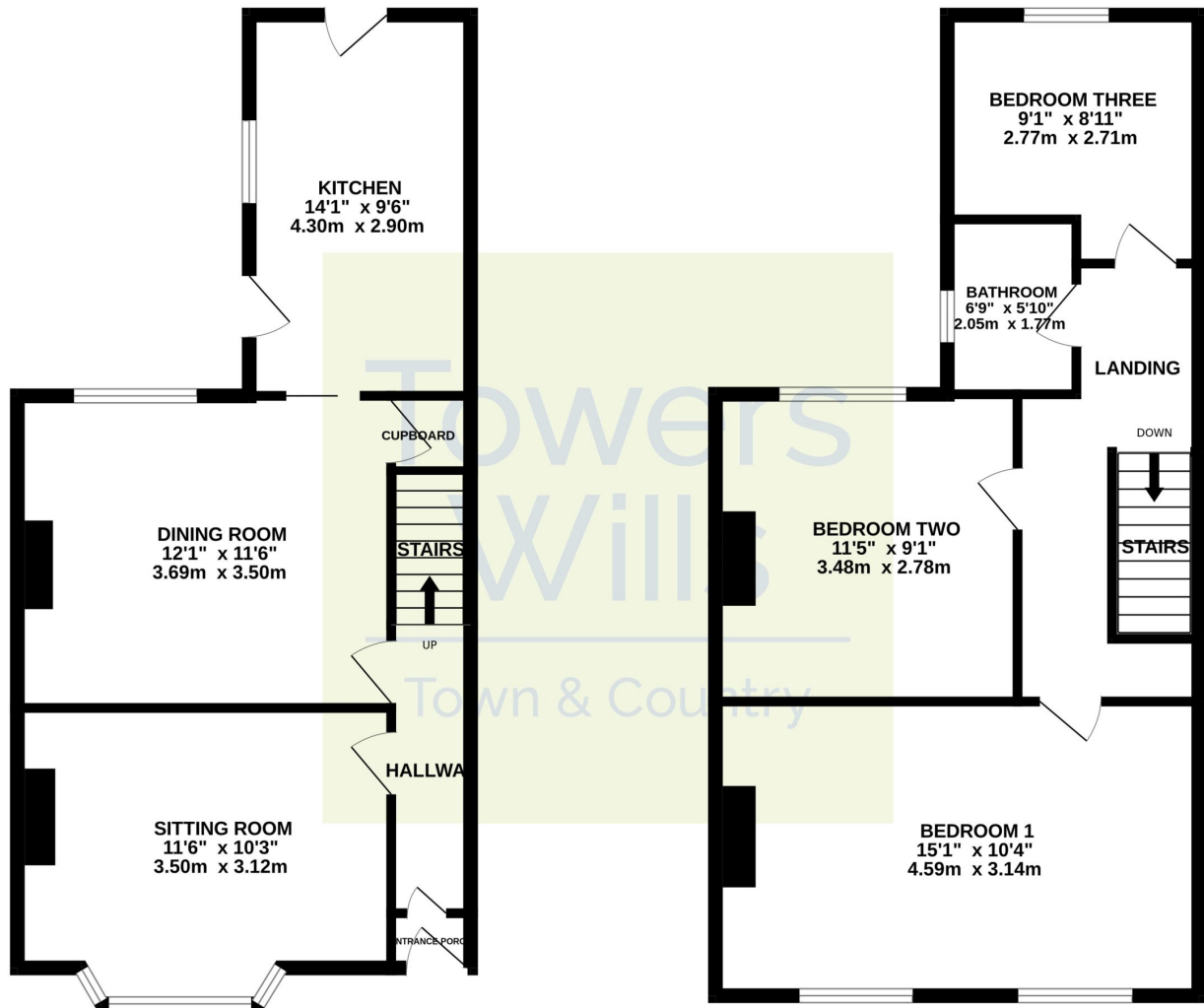

Whilst every attempt has been made to ensure the accuracy of the floorplan contained here, measurements of doors, windows, rooms and any other items are approximate and no responsibility is taken for any error, omission or mis-statement. This plan is for illustrative purposes only and should be used as such by any prospective purchaser. The services, systems and appliances shown have not been tested and no guarantee as to their operability or efficiency can be given.

Made with Metropix ©2025

Please Note No tests have been undertaken of any of the services and any intending purchasers should satisfy themselves in this regard. Towers Wills Ltd for themselves and for the vendor of this property whose agents they are, give notice that, (i) these particulars do not constitute any part of an offer or contract, (ii) all statements contained within these particulars are made without responsibility on the part of Towers Wills or the vendor , (iii) whilst made in good faith, none of the statements contained within these particulars are to be relied upon as a statement of representation or fact , (iv) any intending purchaser must satisfy him/herself by inspection or otherwise as to the correctness of each of the statements contained within these particulars, (v) the vendor does not make or give either Towers Wills or any person in their employment any authority to make or give representation or warranty whatsoever in relation to this property.

Photographs / Floor Plans Photographs are reproduced for general information and it must not be inferred that any item is included for sale with this property. Please note floor plans are not to scale and are for identification purposes only. The photographs used in these particulars may have been taken with the use of a wide angle lens. If you have any queries as to the size of the accommodation or plot, please address these with the agent prior to making an appointment to view