

Towers Wills

Town & Country

📞 01935 577 032 | 01460 298 530 | ✉ info@towerswills.co.uk



10, Stratford Road, Yeovil, Somerset BA21 3AJ

£375,000

Towers Wills are pleased to welcome to market this spacious four double bedroom, semi-detached property, situated within a cul-de-sac position and conveniently located to many local amenities including: schools, shops and bus routes. The property briefly comprises; entrance hall, large lounge/diner, large kitchen, utility, four double bedrooms, master bedroom with en-suite, corner plot garden, garage and off road parking for multiple cars. Viewing highly advised.

Entrance Hall

Double glazed door to the front, sliding door leading to the w.c, stairs leading to the first floor, door to lounge and radiator.

Downstairs W.C 1.81m x 0.80m

Comprising wash hand basin with vanity unit. w.c, extractor fan and double glazed window to the side.

Lounge/Diner 7.56m x 3.93m

Double glazed window to the front, feature fireplace, double glazed sliding doors leading to the garden, coved ceiling and two radiators.

Kitchen 7.55m x 3.73m

Comprising of a range of wall, base and drawer units, work surfacing with Belfast sink with mixer tap, space for freestanding oven with cookerhood over, tiled walls, laminate flooring, double glazed windows to the front and rear, double glazed patio doors leading to the garden, door leading through to the utility, wall mounted radiator, coved ceiling and spotlights.

Utility 2.86m x 3.00m

Comprising base units with work tops over, Belfast sink with mixer tap, space for washing machine, space for tumble dryer, space for fridge freezer, wall mounted boiler, tiled floor, double glazed windows to the rear and side, double glazed door leading to the garden, coved ceiling, radiator and door through to the garage.

First Floor Landing

Loft hatch.

Bedroom One 5.45m x 2.99m

Double glazed windows to the front and side, fitted wardrobes, door to en-suite and radiator.

En-suite 1.10m x 2.95m

Comprising shower cubicle, wash hand basin with vanity unit, w.c, wall mounted heated towel rail, coved ceiling, spotlights and double glazed window to the rear.

Bedroom Two 3.31m x 3.92m

Double glazed window to the front, eaves storage space, fitted wardrobes, coved ceiling and radiator.

Bedroom Three 3.24m x 3.92m

Double glazed window to the rear, fitted wardrobes, coved ceiling and radiator.

Bedroom Four 3.27m x 3.67m

Double glazed window to the front, eaves storage space, coved ceiling and radiator.

Bathroom 3.71m x 2.30m

Suite comprising freestanding bath, separate shower cubicle, wash hand

Key Features

- Semi-Detached
- Generous Corner Plot
- Cul-de-sac Position
- Four Double Bedrooms
- Master En-suite
- Driveway & Garage

Contact Us

Towers Wills Estate Agents - Yeovil

114, Hendford Hill

Yeovil

Somerset

BA202RF

T: 01935 577032

E: info@towerswills.co.uk

basin, w.c, tiled walls, tiled floor, wall mounted towel rail, radiator, spotlights and two double glazed windows to the rear.

Rear Garden

The property occupies a generous corner plot which is mainly laid to lawn with decking area providing ample seating and space for large shed.

Driveway

There is a driveway providing off road parking for a couple of vehicles, in turn leading to the garage.

Garage

With 'up and over' door.



Floor Plan

GROUND FLOOR

1ST FLOOR

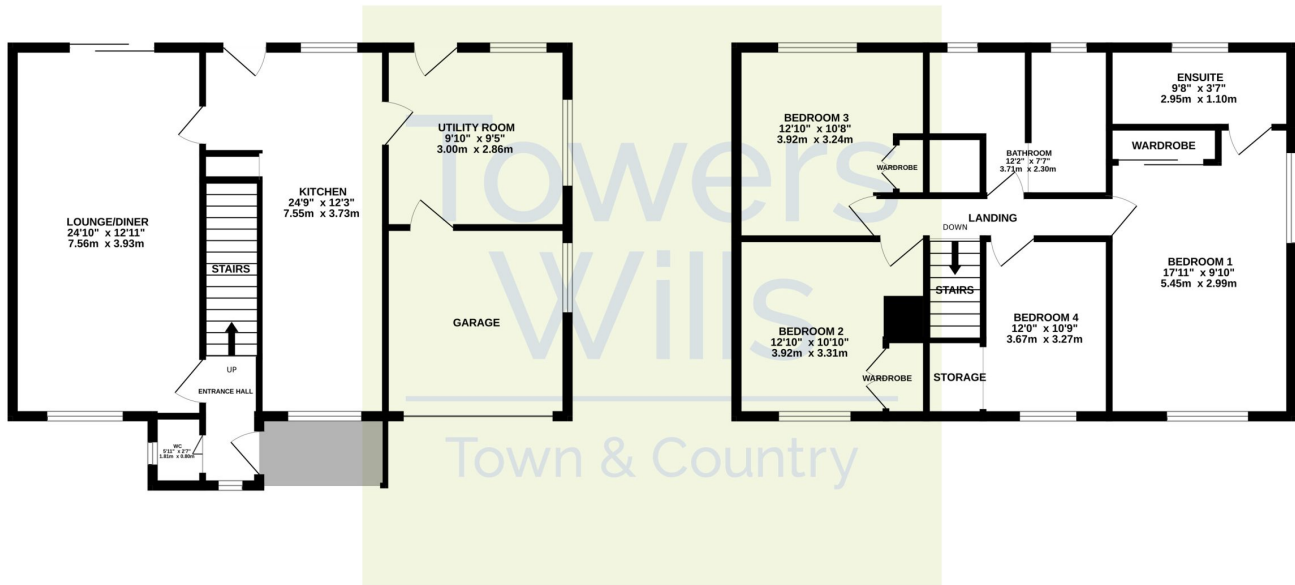

Whilst every attempt has been made to ensure the accuracy of the floorplan contained here, measurements of doors, windows, rooms and any other items are approximate and no responsibility is taken for any error, omission or mis-statement. This plan is for illustrative purposes only and should be used as such by any prospective purchaser. The services, systems and appliances shown have not been tested and no guarantee as to their operability or efficiency can be given.
Made with Metropix ©2025

Please Note No tests have been undertaken of any of the services and any intending purchasers should satisfy themselves in this regard. Towers Wills Ltd for themselves and for the vendor of this property whose agents they are, give notice that, (i) these particulars do not constitute any part of an offer or contract, (ii) all statements contained within these particulars are made without responsibility on the part of Towers Wills or the vendor, (iii) whilst made in good faith, none of the statements contained within these particulars are to be relied upon as a statement of representation or fact, (iv) any intending purchaser must satisfy him/herself by inspection or otherwise as to the correctness of each of the statements contained within these particulars, (v) the vendor does not make or give either Towers Wills or any person in their employment any authority to make or give representation or warranty whatsoever in relation to this property.

Photographs / Floor Plans Photographs are reproduced for general information and it must not be inferred that any item is included for sale with this property. Please note floor plans are not to scale and are for identification purposes only. The photographs used in these particulars may have been taken with the use of a wide angle lens. If you have any queries as to the size of the accommodation or plot, please address these with the agent prior to making an appointment to view

Towers Wills

The White House, 114 Hendford Hill, Yeovil BA20 2RF

Yeovil 01935 577032 / South Petherton 01460 298530

info@towerswills.co.uk | www.towerswills.co.uk