

Towers Wills

Town & Country

📞 01935 577 032 | 01460 298 530 | ✉ info@towerswills.co.uk



31, Long Mead, Yeovil, Somerset BA21 3RH

Offers Over £190,000

Towers Wills are pleased to welcome to market this well presented, two double bedroom terraced property, situated in the popular Abbey Manor Park development and conveniently located to local amenities including: schools, shops and retail park. The accommodation briefly comprises; entrance hall, kitchen, lounge/diner, two double bedrooms, modern fitted bathroom, garden and allocated parking.

Entrance Hall

Double glazed door to the front, stairs leading to the first floor, under stairs cupboard and radiator.

Kitchen 2.98m x 1.99m

Comprising of a range of wall, base and drawer units, work surfacing with stainless steel one bowl sink drainer, integrated oven with electric hob and cookerhood over, space for washing machine, space for fridge freezer, tiled floor, wall mounted gas boiler and double glazed window to the front.

Lounge/Diner 4.48m x 3.94m

Double glazed window to the rear, double glazed doors leading out onto the rear garden, feature electric fireplace and radiator.

First Floor Landing

Loft hatch.

Bedroom One 3.59m x 3.95m

Two double glazed windows to the front, over stairs cupboard and radiator.

Bedroom Two 2.32m x 2.89m

Double glazed window to the rear and radiator.

Family Bathroom 2.41m x 1.53m

A modern fitted bathroom suite comprising bath with shower over, wash hand basin, w.c, part tiled walls, laminate flooring, wall mounted heated towel rail and double glazed window to the rear.

Rear Garden

There is an enclosed garden being mainly laid to lawn with patio area abutting the house, mixture of mature flower beds and space for shed.

Parking

There is allocated parking to the front.

Key Features

- Popular Abbey Manor Park
- Terraced Property
- Two Double Bedrooms
- Enclosed Rear Garden
- Allocated Parking

Contact Us

Towers Wills Estate Agents - Yeovil

114, Hendford Hill
Yeovil

Somerset

BA202RF

T: 01935 577032

E: info@towerswills.co.uk



Floor Plan

GROUND FLOOR

1ST FLOOR

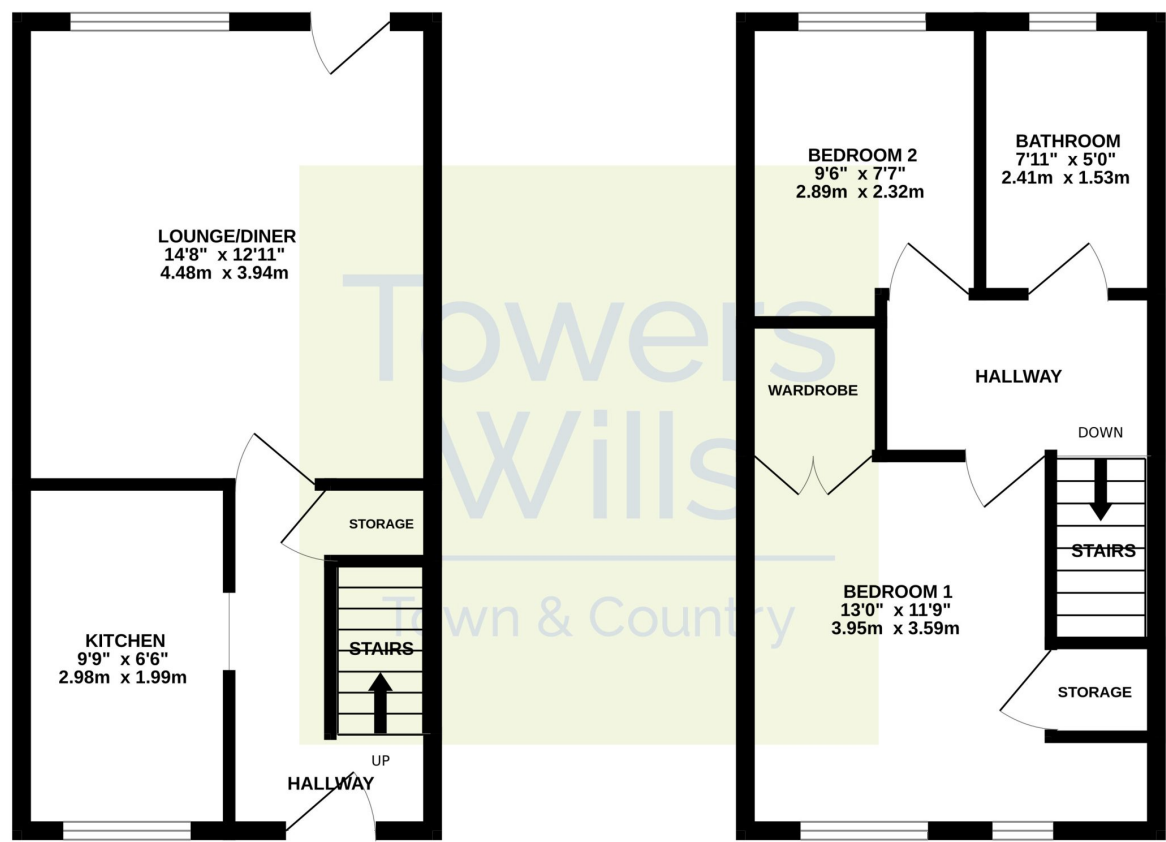

Whilst every attempt has been made to ensure the accuracy of the floorplan contained here, measurements of doors, windows, rooms and any other items are approximate and no responsibility is taken for any error, omission or mis-statement. This plan is for illustrative purposes only and should be used as such by any prospective purchaser. The services, systems and appliances shown have not been tested and no guarantee as to their operability or efficiency can be given.
Made with Metropix ©2025

Please Note No tests have been undertaken of any of the services and any intending purchasers should satisfy themselves in this regard. Towers Wills Ltd for themselves and for the vendor of this property whose agents they are, give notice that, (i) these particulars do not constitute any part of an offer or contract, (ii) all statements contained within these particulars are made without responsibility on the part of Towers Wills or the vendor , (iii) whilst made in good faith, none of the statements contained within these particulars are to be relied upon as a statement of representation or fact , (iv) any intending purchaser must satisfy him/herself by inspection or otherwise as to the correctness of each of the statements contained within these particulars, (v) the vendor does not make or give either Towers Wills or any person in their employment any authority to make or give representation or warranty whatsoever in relation to this property.

Photographs / Floor Plans Photographs are reproduced for general information and it must not be inferred that any item is included for sale with this property. Please note floor plans are not to scale and are for identification purposes only. The photographs used in these particulars may have been taken with the use of a wide angle lens. If you have any queries as to the size of the accommodation or plot, please address these with the agent prior to making an appointment to view

Towers Wills

The White House, 114 Hendford Hill, Yeovil BA20 2RF

Yeovil 01935 577032 / South Petherton 01460 298530

info@towerswills.co.uk | www.towerswills.co.uk