



**7, Greenhill Road, Yeovil, Somerset BA21 5NA**

**£240,000**

Recently Refurbished Two-Bedroom Bungalow with Landscaped Garden and No Onward Chain. A superb opportunity to acquire this beautifully refurbished two-bedroom bungalow, ideally positioned and offered with the benefit of no onward chain. This stunning home has undergone a complete transformation, making it the perfect turnkey property.

Description

Internally, the accommodation has been freshly repainted throughout, with new flooring, adding a fresh and modern finish. The heart of the home is a brand-new kitchen, fitted with a comprehensive range of wall, base, and drawer units, along with an integrated electric oven, gas hob, and space for a fridge/freezer. The kitchen flows seamlessly into a useful utility area, providing additional storage and practicality.

There are two well-proportioned bedrooms and a stylish, newly fitted shower room comprising a modern shower cubicle, vanity wash hand basin, and WC.

Outside, the rear garden has been landscaped for ease of maintenance and includes a generous decked area, ideal for entertaining, as well as gated rear access.

With its contemporary finish, thoughtful layout, and chain-free status, this home is sure to appeal to a range of buyers — early viewing is highly recommended.

Agents Note

- The current owner has advised us of the following:
- \* brand-new central heating system including a new boiler
  - \* The whole bungalow has been rewired and certificated along with new plumbing throughout

Key Features

- Recently Refurbished
- Two Bedroom Bungalow
- NO ONWARD CHAIN
- Landscaped Rear Garden
- Early Viewing Advised

Contact Us

**Towers Wills Estate Agents - Yeovil**  
114, Hendford Hill  
Yeovil  
Somerset  
BA202RF  
T: 01935 577032  
E: [info@towerswills.co.uk](mailto:info@towerswills.co.uk)

Energy Efficiency

Score	Energy rating	Current	Potential
92+	A		
81-91	B		85 B
69-80	C		
55-68	D	55 D	
39-54	E		
21-38	F		
1-20	G		





# Floor Plan

## GROUND FLOOR

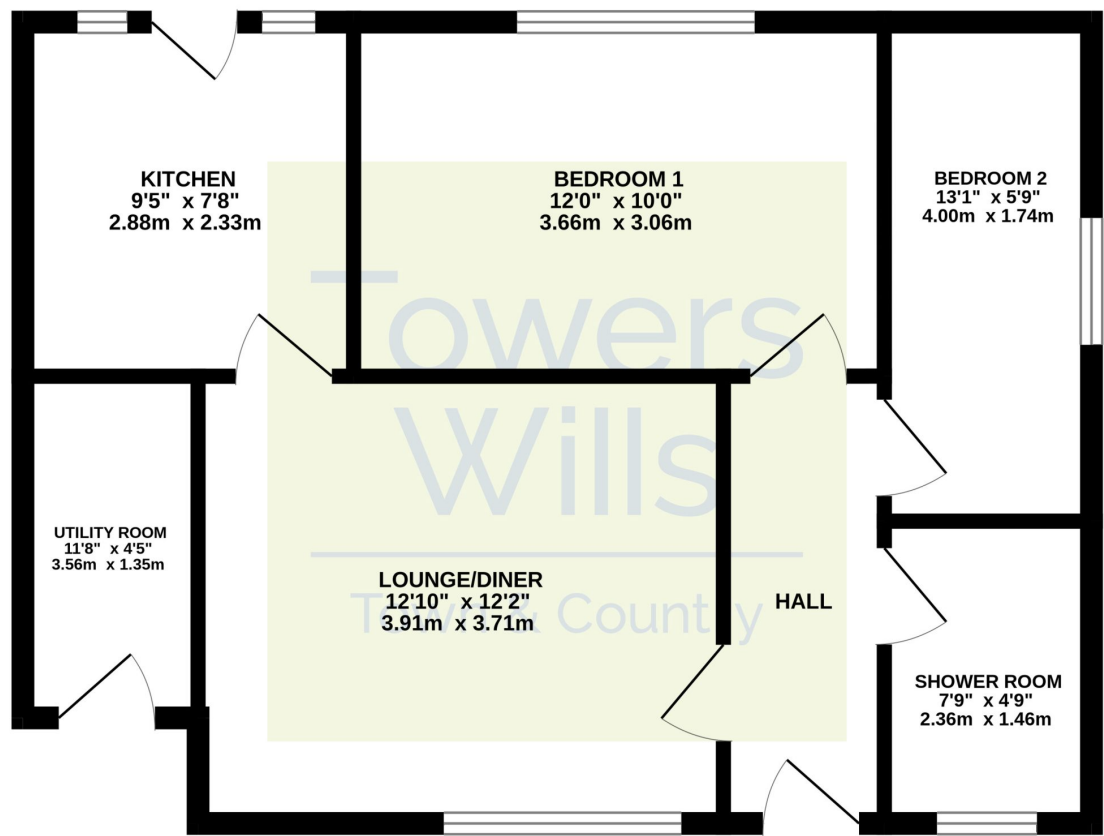

Whilst every attempt has been made to ensure the accuracy of the floorplan contained here, measurements of doors, windows, rooms and any other items are approximate and no responsibility is taken for any error, omission or mis-statement. This plan is for illustrative purposes only and should be used as such by any prospective purchaser. The services, systems and appliances shown have not been tested and no guarantee as to their operability or efficiency can be given.  
Made with Metropix ©2025

Please Note No tests have been undertaken of any of the services and any intending purchasers should satisfy themselves in this regard. Towers Wills Ltd for themselves and for the vendor of this property whose agents they are, give notice that, (i) these particulars do not constitute any part of an offer or contract, (ii) all statements contained within these particulars are made without responsibility on the part of Towers Wills or the vendor , (iii) whilst made in good faith, none of the statements contained within these particulars are to be relied upon as a statement of representation or fact , (iv) any intending purchaser must satisfy him/herself by inspection or otherwise as to the correctness of each of the statements contained within these particulars, (v) the vendor does not make or give either Towers Wills or any person in their employment any authority to make or give representation or warranty whatsoever in relation to this property.

Photographs / Floor Plans Photographs are reproduced for general information and it must not be inferred that any item is included for sale with this property. Please note floor plans are not to scale and are for identification purposes only. The photographs used in these particulars may have been taken with the use of a wide angle lens. If you have any queries as to the size of the accommodation or plot, please address these with the agent prior to making an appointment to view

**Towers Wills**

The White House, 114 Hendford Hill, Yeovil BA20 2RF

Yeovil 01935 577032 / South Petherton 01460 298530

[info@towerswills.co.uk](mailto:info@towerswills.co.uk) | [www.towerswills.co.uk](http://www.towerswills.co.uk)