

Towers Wills

Town & Country

📞 01935 577 032 | 01460 298 530 | ✉ info@towerswills.co.uk



152, Huish, Yeovil, Somerset BA20 1BN

£150,000

Towers Wills are pleased to present this spacious three-bedroom mid-terrace property, offering an ideal project for first-time buyers or investors. In need of modernisation throughout, the accommodation includes a separate lounge, separate dining room, kitchen, three bedrooms and family bathroom. Outside, the home benefits from an enclosed rear garden and off-road parking.

Conveniently located close to local schools, shops and amenities. A great opportunity to add value – early viewing advised.

Towers Wills are delighted to bring to market this spacious three-bedroom mid-terrace home, offering an exciting opportunity for those looking to put their own stamp on a property. Situated in a convenient location close to local schools, shops and amenities, this home is ideal as a first project or investment.

In need of updating throughout, the property offers generous accommodation including a separate lounge, separate dining room, kitchen and bathroom to the ground floor, while the first floor boasts three bedrooms.

Outside, there is an enclosed rear garden, perfect for families or entertaining, along with the added benefit of off-road parking—a rare find in this location.

With scope to modernise and add value, this property presents a fantastic opportunity for first-time buyers, investors or anyone looking to create their ideal home.

Early viewing is highly recommended to appreciate the potential on offer. Contact Towers Wills today to arrange your appointment.

Key Features

- Three Bedrooms
- Mid Terrace
- Enclosed Rear Garden
- Off Road Parking
- Close to the Town Centre and Hospital

Contact Us

Towers Wills Estate Agents - Yeovil

114, Hendford Hill

Yeovil

Somerset

BA202RF

T: 01935 577032

E: info@towerswills.co.uk



Floor Plan

GROUND FLOOR

1ST FLOOR

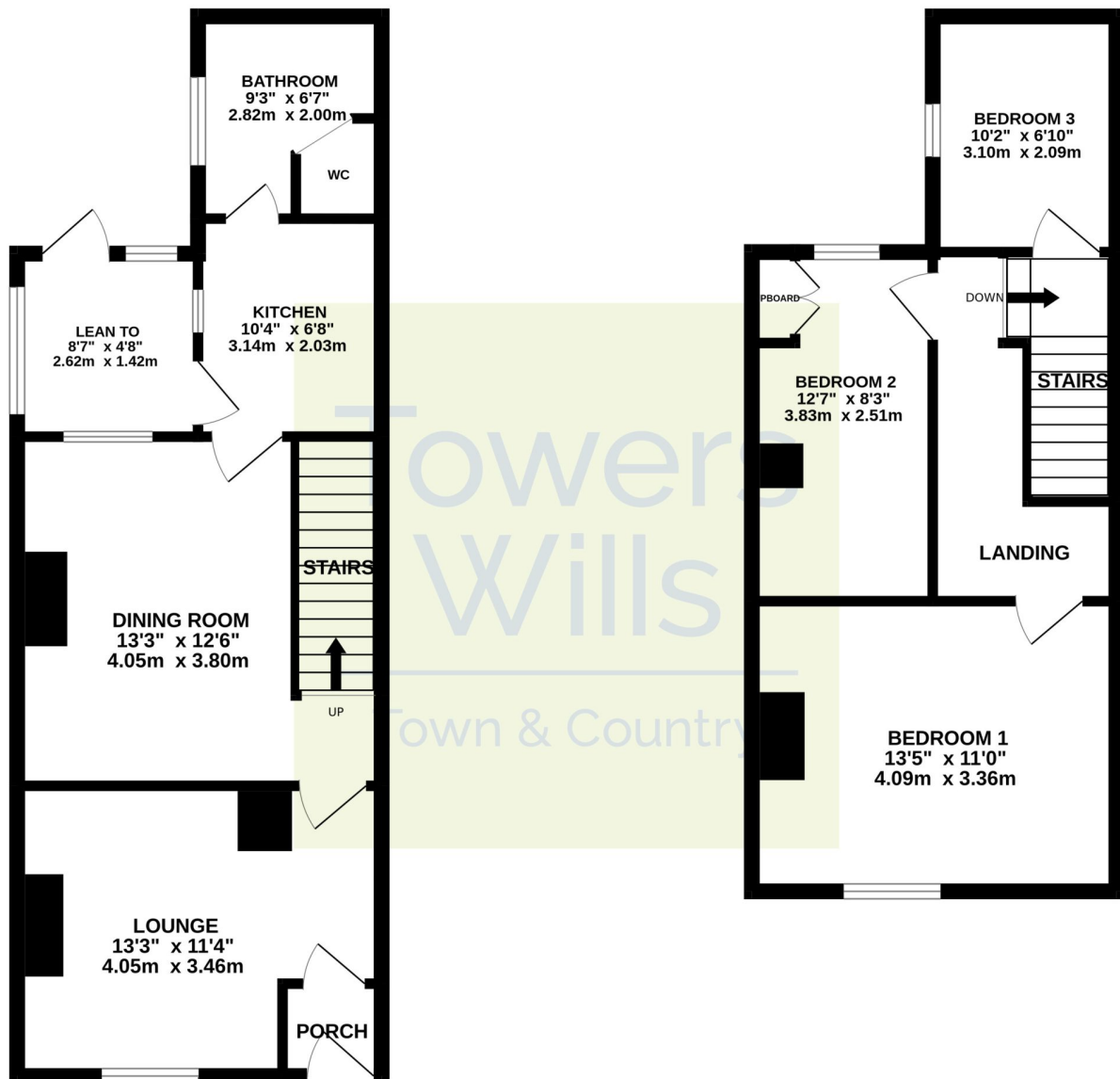

Whilst every attempt has been made to ensure the accuracy of the floorplan contained here, measurements of doors, windows, rooms and any other items are approximate and no responsibility is taken for any error, omission or mis-statement. This plan is for illustrative purposes only and should be used as such by any prospective purchaser. The services, systems and appliances shown have not been tested and no guarantee as to their operability or efficiency can be given.

Made with Metropix ©2025

Please Note No tests have been undertaken of any of the services and any intending purchasers should satisfy themselves in this regard. Towers Wills Ltd for themselves and for the vendor of this property whose agents they are, give notice that, (i) these particulars do not constitute any part of an offer or contract, (ii) all statements contained within these particulars are made without responsibility on the part of Towers Wills or the vendor , (iii) whilst made in good faith, none of the statements contained within these particulars are to be relied upon as a statement of representation or fact , (iv) any intending purchaser must satisfy him/herself by inspection or otherwise as to the correctness of each of the statements contained within these particulars, (v) the vendor does not make or give either Towers Wills or any person in their employment any authority to make or give representation or warranty whatsoever in relation to this property.

Photographs / Floor Plans Photographs are reproduced for general information and it must not be inferred that any item is included for sale with this property. Please note

Towers Wills

The White House, 114 Hendford Hill, Yeovil BA20 2RF

Yeovil 01935 577032 / South Petherton 01460 298530

info@towerswills.co.uk | www.towerswills.co.uk