

# Towers Wills

Town & Country

📞 01935 577 032 | 01460 298 530 | ✉ info@towerswills.co.uk



**3, Holywell, East Coker, Yeovil, Somerset BA22 9NF**  
**OIEO £150,000**

Towers Wills welcome to the market this mid terrace property in a desirable village location. The property is in need of internal updating throughout and is priced for immediate interest. Briefly comprising lounge, dining room, kitchen, three bedrooms, shower room and rear garden.

**Lounge** 3.50m x 3.90m  
With feature fireplace and window outlook to the front.

**Dining Room** 3.40m x 3.49m  
With tiled floor and stairs leading to first floor landing.

**Kitchen** 3.04m x 3.12m  
Fitted with patterned effect worktops and timber effect doors with a range of wall and base units. A stainless steel sink drainer unit with mixer tap, a for ring electric hob with oven under extractor hood over, plumbing for washing machine, plumbing for slimline dishwasher, tiled floor, part tiled wall and door leading out to the rear.

**Bedroom One** 2.40m x 4.13m  
With window outlook the front.

**Bedroom Two** 2.63m x 2.78m  
With window outlook to the rear and fitted wardrobes.

**Bedroom Three** 2.30m x 3.22m  
With window outlook to the front.

**Shower Room** 1.63m x 2.26m  
A modern shower room with walk-in shower pedestal hand basin with mixer tap and WC.

**Garden**  
To the rear of the property the garden is overgrown and offers great potential.

## Key Features

- Mid Terrace
- Desirable village location
- Three bedrooms
- In need of updating throughout
- Priced for immediate interest

## Contact Us

**Towers Wills Estate Agents - Yeovil**  
114, Hendford Hill  
Yeovil  
Somerset  
BA202RF  
T: 01935 577032  
E: [info@towerswills.co.uk](mailto:info@towerswills.co.uk)

## Energy Efficiency

Score	Energy rating	Current	Potential
92+	A		
81-91	B		
69-80	C		72 C
55-68	D		
39-54	E		
21-38	F	35 F	
1-20	G		



# Floor Plan

GROUND FLOOR  
519 sq.ft. (48.2 sq.m.) approx.

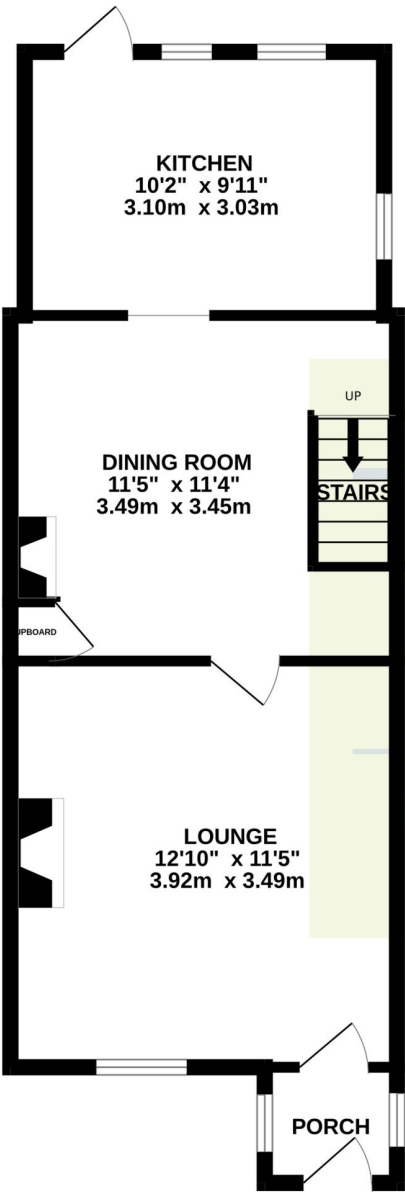

1ST FLOOR  
408 sq.ft. (37.9 sq.m.) approx.

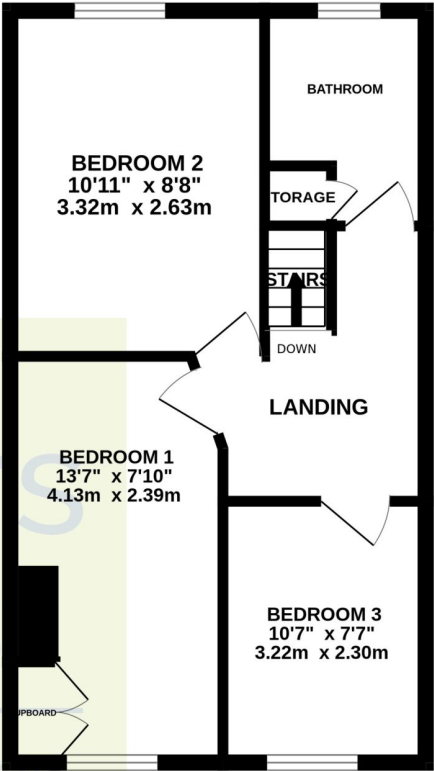

TOTAL FLOOR AREA : 926 sq.ft. (86.1 sq.m.) approx.

Whilst every attempt has been made to ensure the accuracy of the floorplan contained here, measurements of doors, windows, rooms and any other items are approximate and no responsibility is taken for any error, omission or mis-statement. This plan is for illustrative purposes only and should be used as such by any prospective purchaser. The services, systems and appliances shown have not been tested and no guarantee as to their operability or efficiency can be given.  
Made with Metropix ©2025

Please Note No tests have been undertaken of any of the services and any intending purchasers should satisfy themselves in this regard. Towers Wills Ltd for themselves and for the vendor of this property whose agents they are, give notice that, (i) these particulars do not constitute any part of an offer or contract, (ii) all statements contained within these particulars are made without responsibility on the part of Towers Wills or the vendor , (iii) whilst made in good faith, none of the statements contained within these particulars are to be relied upon as a statement of representation or fact , (iv) any intending purchaser must satisfy him/herself by inspection or otherwise as to the correctness of each of the statements contained within these particulars, (v) the vendor does not make or give either Towers Wills or any person in their employment any authority to make or give representation or warranty whatsoever in relation to this property.

Photographs / Floor Plans Photographs are reproduced for general information and it must not be inferred that any item is included for sale with this property. Please note