

# Towers Wills

Town & Country

📞 01935 577 032 | 01460 298 530 | ✉ info@towerswills.co.uk



**7, Redwood Road, Yeovil, Somerset BA21 5XB**

**£280,000**

Towers Wills welcome to the market this link-detached bungalow, situated in a popular location on the eastern side of Yeovil. Selling with no onward chain and briefly comprises; large driveway leading to the garage, three bedrooms, shower room, large lounge/diner, kitchen, conservatory to the rear and delightful private rear garden. Please contact Towers Wills for more information and to arrange a viewing.

### Entrance Hall

Double glazed door to the side, radiator and single glazed door to internal hallway.

### Shower Room 1.53m x 2.00m

Suite comprising shower cubicle, wash hand basin, w.c, double glazed window to the side, heated towel rail and extractor fan.

### Internal Hallway

Includes loft hatch, radiator, built-in double cupboard and built-in single cupboard.

### Bedroom One 3.12m x 3.19m

Double glazed window to the front, radiator and freestanding wardrobe.

### Bedroom Two 3.93m x 2.59m

Double glazed window to the rear, radiator, wash hand basin and fitted wardrobes.

### Bedroom Three/Study 2.59m x 1.95m

Single glazed window to conservatory, radiator and fitted cupboard.

### Lounge/Diner 6.65m x 3.64m – maximum measurements

Double glazed window to the front, two radiators and electric fireplace.

### Kitchen 3.59m x 2.22m

Comprising of a range of wall, base and drawer units, work surfacing with one bowl stainless steel sink drainer, fridge freezer, gas cooker, gas combi boiler, space for washing machine and single glazed window and door to conservatory.

### Conservatory 1.91m x 3.28m

Double glazed windows to the rear and sides, wall mounted electric heater, lighting and double glazed door to the rear garden.

### Rear Garden

The rear garden is largely laid to lawn with patio area, planted beds with mature shrubs, outside tap and side gate.

### Agents Note

The vendor has advised Towers Wills that there is a Tree Preservation Order on the oak tree within the boundary.

### Front Garden

The front garden is largely laid to lawn with a large driveway leading to the garage.

### Garage 4.90m x 2.40m

With 'up and over' door, power, light and wooden personal door to the rear garden.

## Key Features

- Link-Detached Bungalow
- Popular Location
- Three Bedrooms
- Conservatory
- Front and Rear Gardens
- Driveway and Garage

## Contact Us

### Towers Wills Estate Agents - Yeovil

114, Hendford Hill  
Yeovil

Somerset

BA202RF

T: 01935 577032

E: [info@towerswills.co.uk](mailto:info@towerswills.co.uk)







# Floor Plan

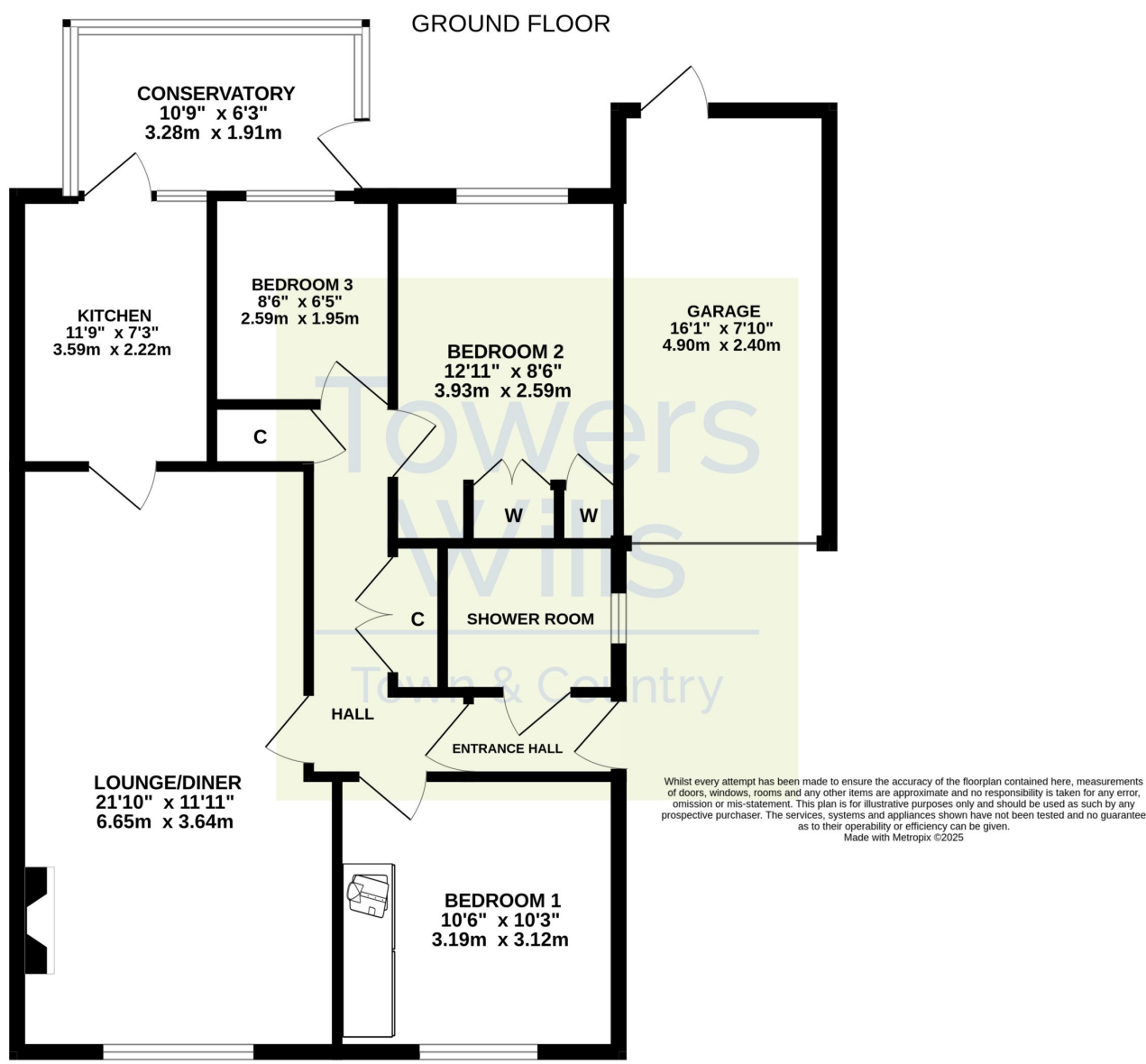

Please Note No tests have been undertaken of any of the services and any intending purchasers should satisfy themselves in this regard. Towers Wills Ltd for themselves and for the vendor of this property whose agents they are, give notice that, (i) these particulars do not constitute any part of an offer or contract, (ii) all statements contained within these particulars are made without responsibility on the part of Towers Wills or the vendor , (iii) whilst made in good faith, none of the statements contained within these particulars are to be relied upon as a statement of representation or fact , (iv) any intending purchaser must satisfy him/herself by inspection or otherwise as to the correctness of each of the statements contained within these particulars, (v) the vendor does not make or give either Towers Wills or any person in their employment any authority to make or give representation or warranty whatsoever in relation to this property.

Photographs / Floor Plans Photographs are reproduced for general information and it must not be inferred that any item is included for sale with this property. Please note floor plans are not to scale and are for identification purposes only. The photographs used in these particulars may have been taken with the use of a wide angle lens. If you have any queries as to the size of the accommodation or plot, please address these with the agent prior to making an appointment to view