

Towers Wills

Town & Country

📞 01935 577 032 | 01460 298 530 | ✉ info@towerswills.co.uk



1, Blacksmiths Row, Mudford, Yeovil, Somerset BA21 5TR

£350,000

Towers Wills welcome to the market this spacious modern four bedroom detached family home, available with no onward chain. The property is well presented throughout and comprises: Hallway, cloak W.C, living room, dining room, kitchen, utility room, four bedrooms, en-suite, bathroom, parking and double garage.

Accommodation:

Nestled in the charming village of Mudford, Somerset, this modern and spacious four-bedroom detached family home, constructed in 2005, offers versatile living accommodation and a desirable layout ideal for contemporary family life. The property is offered to the market with no onward chain.

Upon entering the property, a welcoming reception hallway gives access to the principal ground floor rooms and a convenient cloakroom/WC. The generously proportioned, double aspect living room enjoys an abundance of natural light and features a bay window to the front, creating a warm and inviting family space. A separate dining room opens through a wide archway into the fitted kitchen, allowing for effortless flow when entertaining. The kitchen comprises a range of wall, base, and drawer units with ample work surfacing, inset stainless steel sink-drainer, integrated double electric oven, electric hob with cooker hood over, tiling, and space for an under-counter fridge and freezer. A utility room offers further storage and practicality, with continuation of the base units, work surfaces, plumbing for a washing machine, extractor fan, and door to the rear garden.

To the first floor are four double bedrooms, providing ample space for family and guests. The master bedroom benefits from built-in wardrobes and a private en-suite shower room. A family bathroom completes the first floor, fitted with a bath with shower over, wash-hand basin, WC, tiling, extractor fan, and window to the side.

Externally, the property boasts a detached double garage with twin up-and-over doors and a personal door to the rear garden. The enclosed rear garden is mainly laid to lawn, with a patio seating area and gated side access, perfect for family enjoyment and outdoor entertaining.

Situation:

The property is situated in the desirable village of Mudford, just on the northern fringes of Yeovil, offering a peaceful countryside setting while remaining close to excellent local amenities. The village itself enjoys a strong sense of community and is home to the well-regarded Half Moon Inn, a traditional country pub offering food, drinks, and a welcoming atmosphere.

Nearby Yeovil provides a wide array of facilities including supermarkets, primary and secondary schools, leisure centres, retail parks, cafes, and restaurants, as well as a mainline train station offering direct services to Exeter, Bristol, and London. For families, professionals, or those seeking a semi-rural retreat with easy town access, this location combines the best of both worlds.

Key Features

- Modern four-bedroom detached home
- Built in 2005
- Double-aspect living room with bay window
- Kitchen open to dining room
- Utility room & ground floor WC
- En-suite to master bedroom
- Detached double garage & generous rear garden
- Gated side access
- Quiet village setting with excellent nearby amenities
- No onward chain

Contact Us

Towers Wills Estate Agents - Yeovil

114, Hendford Hill
Yeovil

Somerset

BA202RF

T: 01935 577032

E: info@towerswills.co.uk



Floor Plan

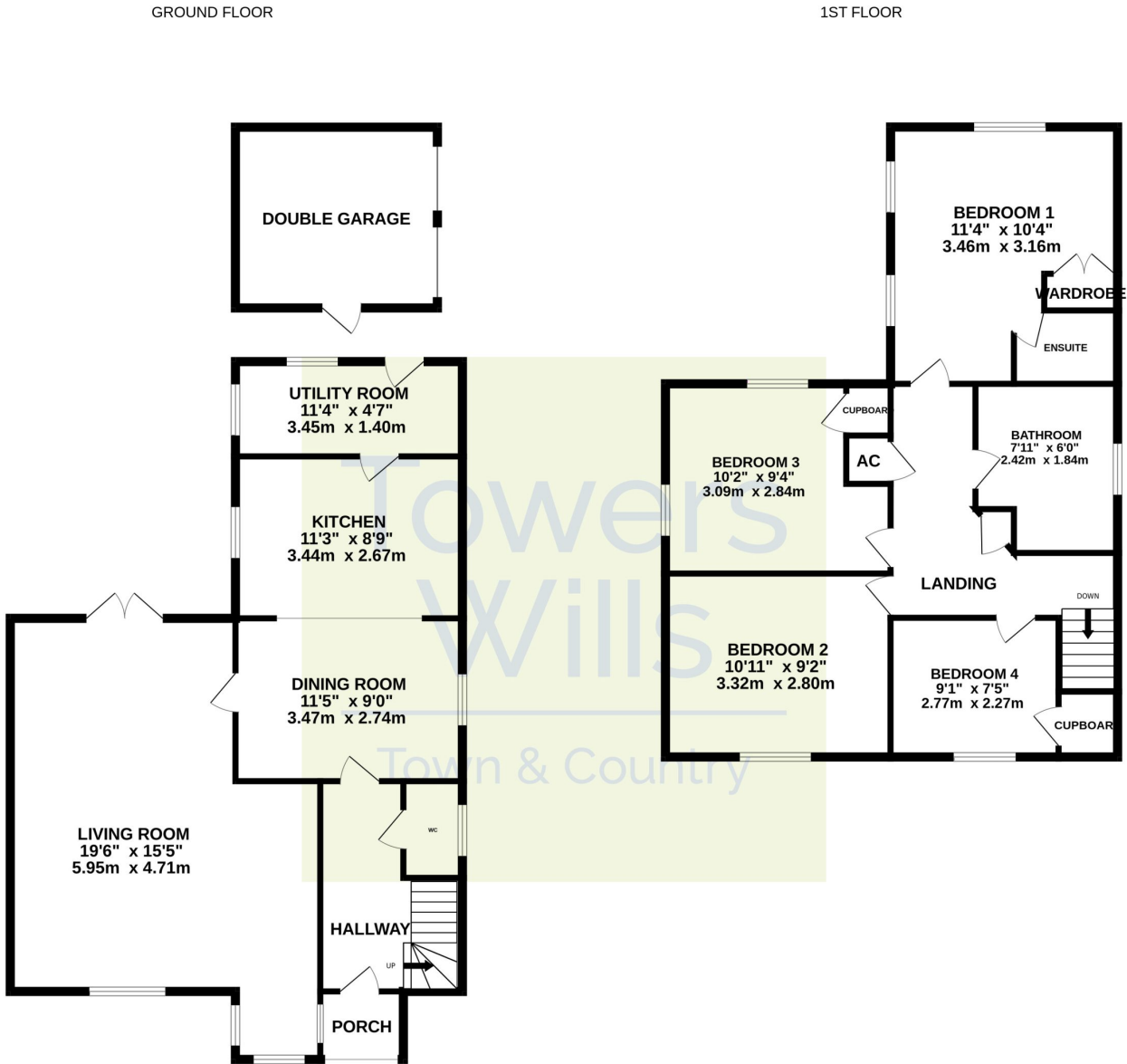

Whilst every attempt has been made to ensure the accuracy of the floorplan contained here, measurements of doors, windows, rooms and any other items are approximate and no responsibility is taken for any error, omission or mis-statement. This plan is for illustrative purposes only and should be used as such by any prospective purchaser. The services, systems and appliances shown have not been tested and no guarantee as to their operability or efficiency can be given.
Made with Metropix ©2025

Please Note No tests have been undertaken of any of the services and any intending purchasers should satisfy themselves in this regard. Towers Wills Ltd for themselves and for the vendor of this property whose agents they are, give notice that, (i) these particulars do not constitute any part of an offer or contract, (ii) all statements contained within these particulars are made without responsibility on the part of Towers Wills or the vendor, (iii) whilst made in good faith, none of the statements contained within these particulars are to be relied upon as a statement of representation or fact, (iv) any intending purchaser must satisfy him/herself by inspection or otherwise as to the correctness of each of the statements contained within these particulars, (v) the vendor does not make or give either Towers Wills or any person in their employment any authority to make or give representation or warranty whatsoever in relation to this property.

Photographs / Floor Plans Photographs are reproduced for general information and it must not be inferred that any item is included for sale with this property. Please note floor plans are not to scale and are for identification purposes only. The photographs used in these particulars may have been taken with the use of a wide angle lens. If you have any queries as to the size of the accommodation or plot, please address these with the agent prior to making an appointment to view