

# Towers Wills

Town & Country

📞 01935 577 032 | 01460 298 530 | ✉ info@towerswills.co.uk



**19, Font Villas, West Coker, Yeovil, Somerset BA22 9BY**

**£150,000**

A spacious two double bedroom terraced home offering excellent potential throughout. Features include a kitchen to the front, separate dining room with garden access, generous lounge, downstairs W/C, and an updated bathroom with walk-in shower. Outside boasts a large rear garden. Ideal for buyers looking to modernise and make it their own. Early viewing recommended.

Accommodation:

Offered with No Onward Chain – A Two Bedroom Terrace Home with Generous Garden and Scope for Modernisation

Situated in a popular location of West Coker, this two-bedroom terraced property presents an exciting opportunity for those looking to put their own stamp on a home. In need of modernisation throughout, the property offers spacious accommodation and fantastic potential, both as a first-time purchase or an investment.

Upon entering, you are welcomed into an entrance hall leading to a convenient downstairs W/C. The kitchen, located at the front of the house, benefits from a window overlooking the street and offers ample natural light. To the rear, a separate dining room provides direct access to the large rear garden, while the spacious lounge offers a comfortable area for relaxing and entertaining.

Upstairs, the property boasts two well-proportioned double bedrooms, along with a recently updated bathroom featuring a modern walk-in shower cubicle.

Externally, the property enjoys a generous rear garden, offering plenty of outdoor space with scope for landscaping.

This is an ideal project for buyers seeking a home to renovate to their own taste. Early viewing is highly recommended.

Key Features

- Terraced Property
- Two Double Bedrooms
- In Need of Modernisation
- NO ONWARD CHAIN
- Large Rear Garden
- Early Viewing Advised

Contact Us

**Towers Wills Estate Agents - Yeovil**  
114, Hendford Hill  
Yeovil  
Somerset  
BA202RF  
T: 01935 577032  
E: info@towerswills.co.uk

Energy Efficiency

Score	Energy rating	Current	Potential
92+	A		
81-91	B		90 B
69-80	C		
55-68	D		
39-54	E	50 E	
21-38	F		
1-20	G		



# Floor Plan

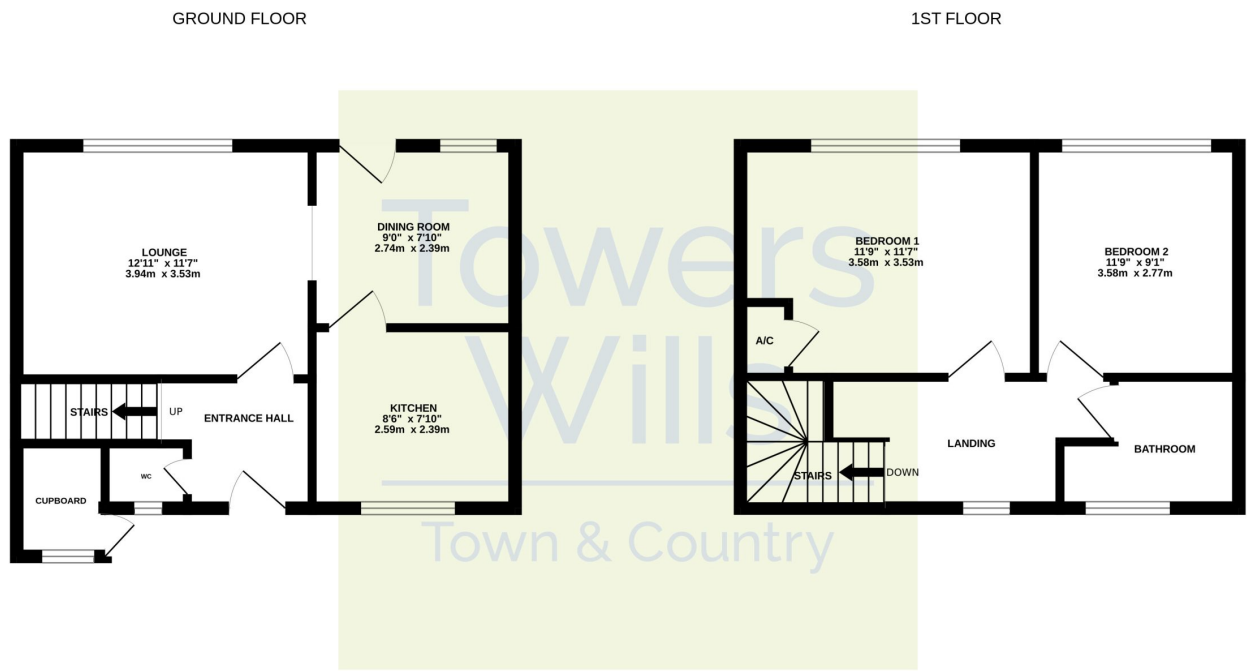

Whilst every attempt has been made to ensure the accuracy of the floorplan contained here, measurements of doors, windows, rooms and any other items are approximate and no responsibility is taken for any error, omission or mis-statement. This plan is for illustrative purposes only and should be used as such by any prospective purchaser. The services, systems and appliances shown have not been tested and no guarantee as to their operability or efficiency can be given.  
Made with Metropix ©2025

Please Note No tests have been undertaken of any of the services and any intending purchasers should satisfy themselves in this regard. Towers Wills Ltd for themselves and for the vendor of this property whose agents they are, give notice that, (i) these particulars do not constitute any part of an offer or contract, (ii) all statements contained within these particulars are made without responsibility on the part of Towers Wills or the vendor , (iii) whilst made in good faith, none of the statements contained within these particulars are to be relied upon as a statement of representation or fact , (iv) any intending purchaser must satisfy him/herself by inspection or otherwise as to the correctness of each of the statements contained within these particulars, (v) the vendor does not make or give either Towers Wills or any person in their employment any authority to make or give representation or warranty whatsoever in relation to this property.

Photographs / Floor Plans Photographs are reproduced for general information and it must not be inferred that any item is included for sale with this property. Please note floor plans are not to scale and are for identification purposes only. The photographs used in these particulars may have been taken with the use of a wide angle lens. If you have any queries as to the size of the accommodation or plot, please address these with the agent prior to making an appointment to view

**Towers Wills**

The White House, 114 Hendford Hill, Yeovil BA20 2RF

Yeovil 01935 577032 / South Petherton 01460 298530

[info@towerswills.co.uk](mailto:info@towerswills.co.uk) | [www.towerswills.co.uk](http://www.towerswills.co.uk)