

# Towers Wills

Town & Country

📞 01935 577 032 | 01460 298 530 | ✉ info@towerswills.co.uk



Silverthorne, Higher Burton Road, East Coker, Yeovil,  
Somerset BA22 9LZ

**£375,000**

Towers Wills welcome this spacious detached bungalow occupying a generous corner plot in this sought after village to the market. Comprising: Hallway, living room, kitchen, conservatory, two double bedrooms, bathroom, loft room, driveway, garage and garden.

Accommodation

Situated on a generous corner plot in an elevated position on the edge of the highly sought-after village of East Coker, this beautifully presented two-bedroom detached bungalow offers versatile and spacious accommodation with delightful gardens and excellent access to countryside walks and local amenities.

Upon entering, you are welcomed into a bright and spacious reception hallway. The triple-aspect living room is a light-filled space with windows to the front and side, and French doors opening out to the rear garden.

The well-appointed kitchen features a comprehensive range of wall, base, and drawer units, complemented by attractive timber work surfaces. Additional features include an integrated double electric oven with electric hob and cooker hood over, plinth heater, plumbing for washing machine, and space for a fridge/freezer. A door from the kitchen leads to the rear conservatory, which enjoys a pleasant outlook over the private garden, making it an ideal spot for morning coffee or afternoon reading.

There are two generous double bedrooms, both tastefully decorated, and a modern shower room comprising a walk-in shower, vanity unit with wash hand basin, WC, and a window to the side.

To the first floor is a versatile loft room, which could be used as a home office, hobby room etc, with a window to the side.

Externally, the bungalow is set within a well-maintained corner garden, with the front mainly laid to lawn with mature borders featuring a variety of plants and shrubs. A private driveway provides off-road parking for two vehicles, leading to a single garage with up-and-over door, power, water and lighting.

The enclosed rear garden offers a good degree of privacy and is thoughtfully landscaped with a lawn, patio seating area, a decked terrace ideal for outdoor entertaining, and a dedicated vegetable plot. There is an oil storage tank for the central heating system.

A wonderful opportunity to acquire a detached home in a tranquil village setting, perfect for those seeking peace, space, and character.

Location

Nestled in the beautiful Somerset countryside, East Coker is a picturesque and historic village renowned for its charming thatched cottages, peaceful lanes, and strong community spirit. The village enjoys a rich heritage and tranquil rural setting while remaining conveniently close to the market town of Yeovil, with its comprehensive range of shopping, transport, and leisure facilities.

The village itself boasts a popular village hall, local pub, primary school,

Key Features

- Detached Bungalow
- Generous Corner Plot
- Two Bedrooms
- Loft Room
- Conservatory
- Driveway & Garage

Contact Us

**Towers Wills Estate Agents - Yeovil**  
114, Hendford Hill  
Yeovil  
Somerset  
BA202RF  
T: 01935 577032  
E: [info@towerswills.co.uk](mailto:info@towerswills.co.uk)

Energy Efficiency

| Score | Energy rating | Current | Potential |
|-------|---------------|---------|-----------|
| 92+   | A             |         |           |
| 81-91 | B             |         |           |
| 69-80 | C             |         | 79 C      |
| 55-68 | D             |         |           |
| 39-54 | E             | 44 E    |           |
| 21-38 | F             |         |           |
| 1-20  | G             |         |           |

church, and numerous footpaths through surrounding countryside, offering idyllic walks and outdoor pursuits. The combination of rural charm and accessibility makes East Coker an especially desirable location for both retirees and families alike.





# Floor Plan

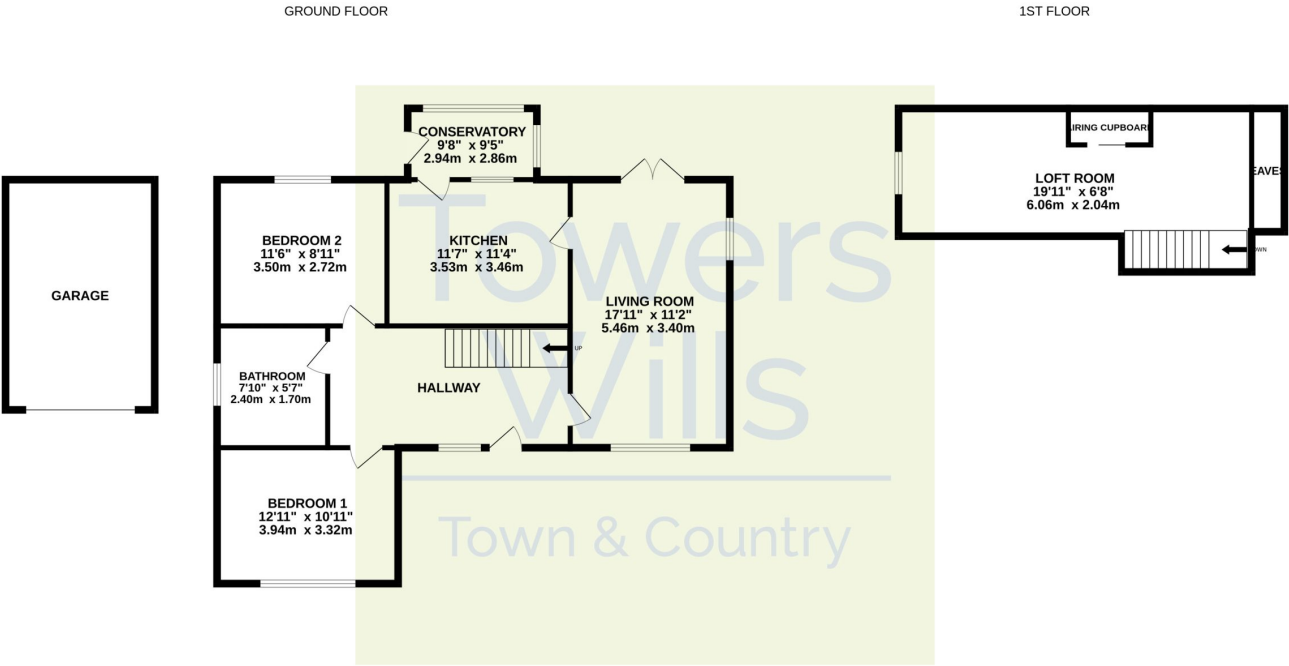

Whilst every attempt has been made to ensure the accuracy of the floorplan contained here, measurements of doors, windows, rooms and any other items are approximate and no responsibility is taken for any error, omission or mis-statement. This plan is for illustrative purposes only and should be used as such by any prospective purchaser. The services, systems and appliances shown have not been tested and no guarantee as to their operability or efficiency can be given.  
Made with Metropix ©2025

Please Note No tests have been undertaken of any of the services and any intending purchasers should satisfy themselves in this regard. Towers Wills Ltd for themselves and for the vendor of this property whose agents they are, give notice that, (i) these particulars do not constitute any part of an offer or contract, (ii) all statements contained within these particulars are made without responsibility on the part of Towers Wills or the vendor, (iii) whilst made in good faith, none of the statements contained within these particulars are to be relied upon as a statement of representation or fact, (iv) any intending purchaser must satisfy him/herself by inspection or otherwise as to the correctness of each of the statements contained within these particulars, (v) the vendor does not make or give either Towers Wills or any person in their employment any authority to make or give representation or warranty whatsoever in relation to this property.

Photographs / Floor Plans Photographs are reproduced for general information and it must not be inferred that any item is included for sale with this property. Please note floor plans are not to scale and are for identification purposes only. The photographs used in these particulars may have been taken with the use of a wide angle lens. If you have any queries as to the size of the accommodation or plot, please address these with the agent prior to making an appointment to view

**Towers Wills**

The White House, 114 Hendford Hill, Yeovil BA20 2RF

Yeovil 01935 577032 / South Petherton 01460 298530

[info@towerswills.co.uk](mailto:info@towerswills.co.uk) | [www.towerswills.co.uk](http://www.towerswills.co.uk)