

Towers Wills

Town & Country

📞 01935 577 032 | 01460 298 530 | ✉ info@towerswills.co.uk



166, Rosebery Avenue, Yeovil, Somerset BA21 5LE

£90,000

Towers Wills are pleased to present to the market this first-floor, one-bedroom apartment, conveniently located within easy reach of local amenities and Yeovil town centre, and offered to the market with no onward chain.

Description:

Towers Wills are pleased to present to the market this first-floor, one-bedroom apartment, conveniently located within easy reach of local amenities and Yeovil town centre, and offered to the market with no onward chain.

Accommodation:

The property is presented in good order throughout and offers well-proportioned accommodation comprising an entrance hall with useful storage cupboards, a generous double bedroom, a bathroom, and a well-appointed kitchen with space for white goods. The spacious lounge enjoys a pleasant outlook over the communal gardens, providing a bright and comfortable living area. The flat also benefits from a further store room which is located off the communal landing, next to the flat.

Whilst the apartment is maintained to a good standard, some updating is now required to better suit modern living requirements, offering an excellent opportunity for a purchaser to add their own stamp. The property is considered ideal for both first-time buyers and investors alike, benefiting from its convenient location.

Further advantages include a nearby garage, providing useful storage or parking for a vehicle.

Agents Note:

The vendor has made us aware of the following lease details:

Lease length: 900 years remaining

Service charge: £108.15 per month

Key Features

- NO OWNARD CHAIN
- First Floor Apartment
- One Bedroom
- Garage
- Ideal First Time Buy/Buy to Let

Contact Us

Towers Wills Estate Agents - Yeovil

114, Hendford Hill

Yeovil

Somerset

BA202RF

T: 01935 577032

E: info@towerswills.co.uk

Energy Efficiency

| Score | Energy rating | Current | Potential |
|-------|---------------|---------|-----------|
| 92+ | A | | |
| 81-91 | B | | |
| 69-80 | C | | |
| 55-68 | D | | 68 D |
| 39-54 | E | 41 E | |
| 21-38 | F | | |
| 1-20 | G | | |



Floor Plan

GROUND FLOOR

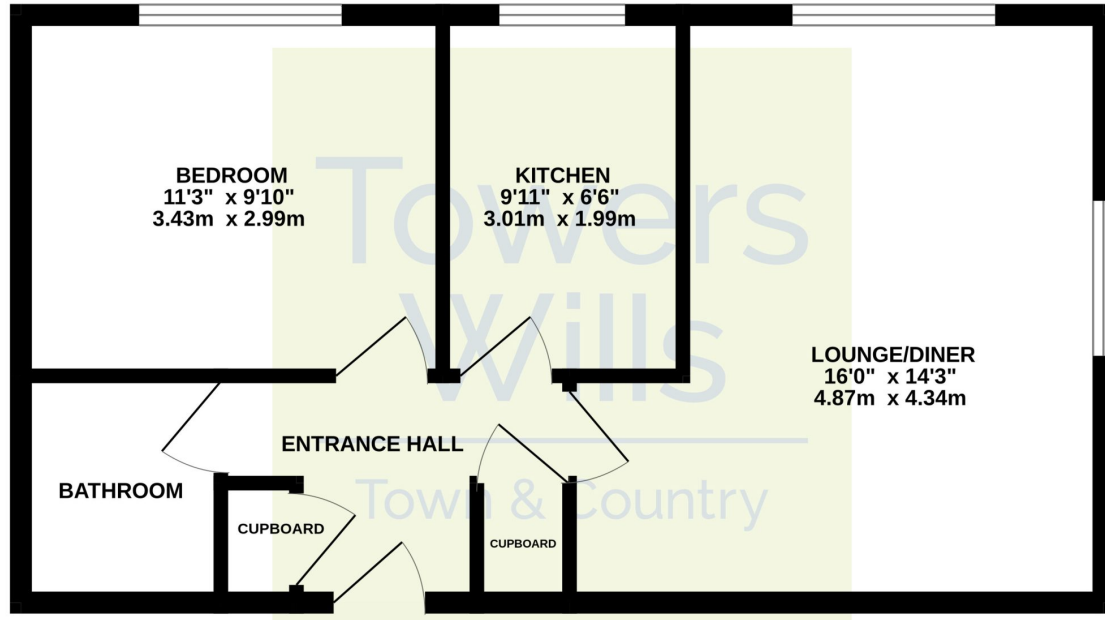

Whilst every attempt has been made to ensure the accuracy of the floorplan contained here, measurements of doors, windows, rooms and any other items are approximate and no responsibility is taken for any error, omission or mis-statement. This plan is for illustrative purposes only and should be used as such by any prospective purchaser. The services, systems and appliances shown have not been tested and no guarantee as to their operability or efficiency can be given.
Made with Metropix ©2026

Please Note No tests have been undertaken of any of the services and any intending purchasers should satisfy themselves in this regard. Towers Wills Ltd for themselves and for the vendor of this property whose agents they are, give notice that, (i) these particulars do not constitute any part of an offer or contract, (ii) all statements contained within these particulars are made without responsibility on the part of Towers Wills or the vendor, (iii) whilst made in good faith, none of the statements contained within these particulars are to be relied upon as a statement of representation or fact, (iv) any intending purchaser must satisfy him/herself by inspection or otherwise as to the correctness of each of the statements contained within these particulars, (v) the vendor does not make or give either Towers Wills or any person in their employment any authority to make or give representation or warranty whatsoever in relation to this property.

Photographs / Floor Plans Photographs are reproduced for general information and it must not be inferred that any item is included for sale with this property. Please note floor plans are not to scale and are for identification purposes only. The photographs used in these particulars may have been taken with the use of a wide angle lens. If you have any queries as to the size of the accommodation or plot, please address these with the agent prior to making an appointment to view

Towers Wills

The White House, 114 Hendford Hill, Yeovil BA20 2RF

Yeovil 01935 577032 / South Petherton 01460 298530

info@towerswills.co.uk | www.towerswills.co.uk