

Towers Wills

Town & Country

☎ 01935 577 032 | 01460 298 530 | ✉ info@towerswills.co.uk



1, Barrington Court, Yeovil, Somerset BA21 3FU

Offers Over £210,000

Towers Wills are delighted to bring to the market this deceptively spacious ground floor apartment, situated within the highly sought-after Brimsmore development, constructed by Wyatt Homes and positioned on the edge of Yeovil. Offering modern and well-presented accommodation throughout, this superb apartment combines contemporary living with the rare advantage of a private garden and two allocated parking spaces.

Accommodation:

The property benefits from its own private entrance door, opening into a generous hallway providing access to all of the principal rooms. At the heart of the home is a spacious open-plan living/kitchen area, flooded with natural light from large windows and creating a wonderful entertaining and social space. The stylish kitchen is fitted with a range of modern units and integrated appliances, including a washer-dryer, dishwasher and integral fridge freezer.

To the opposite side of the hallway is a contemporary family bathroom fitted with a bath and shower over. Both bedrooms are generous doubles, with the principal bedroom enjoying the added benefit of an en-suite shower room and direct access onto a very private, low-maintenance garden — a rare and desirable feature for an apartment of this style and standard.

Externally, the garden provides gated access to the parking area, where Flat 1 benefits from two allocated parking spaces. There is also a particularly useful communal store, ideal for everyday equipment and additional storage, together with a communal bin store.

Viewing is highly recommended to fully appreciate the space, presentation and excellent position of this impressive ground floor apartment within one of Yeovil's most popular developments.

Agents Note:

The current owners have made us aware of the following:

Lease: 991 years remaining

Service charge: £2006 per annum

Key Features

- Ground Floor Apartment
- Two Bedrooms
- Master En-suite
- Sought-After Location
- Off Road Parking
- Well Presented Throughout
- Private Garden

Contact Us

Towers Wills Estate

Agents - Yeovil

114, Hendford Hill

Yeovil

Somerset

BA202RF

T: 01935 577032

E: info@towerswills.co.uk

Energy Efficiency

Score	Energy rating	Current	Potential
92+	A		
81-91	B	83 B	83 B
69-80	C		
55-68	D		
39-54	E		
21-38	F		
1-20	G		



Floor Plan

GROUND FLOOR

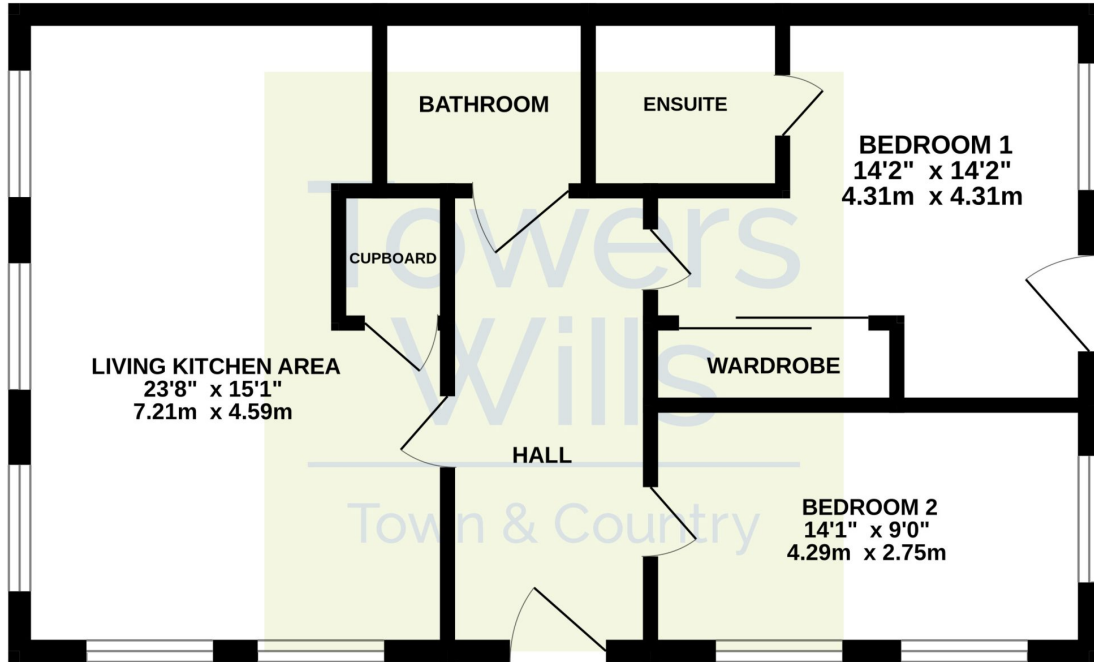

Whilst every attempt has been made to ensure the accuracy of the floorplan contained here, measurements of doors, windows, rooms and any other items are approximate and no responsibility is taken for any error, omission or mis-statement. This plan is for illustrative purposes only and should be used as such by any prospective purchaser. The services, systems and appliances shown have not been tested and no guarantee as to their operability or efficiency can be given.
Made with Metropix ©2026

Please Note No tests have been undertaken of any of the services and any intending purchasers should satisfy themselves in this regard. Towers Wills Ltd for themselves and for the vendor of this property whose agents they are, give notice that, (i) these particulars do not constitute any part of an offer or contract, (ii) all statements contained within these particulars are made without responsibility on the part of Towers Wills or the vendor, (iii) whilst made in good faith, none of the statements contained within these particulars are to be relied upon as a statement of representation or fact, (iv) any intending purchaser must satisfy him/herself by inspection or otherwise as to the correctness of each of the statements contained within these particulars, (v) the vendor does not make or give either Towers Wills or any person in their employment any authority to make or give representation or warranty whatsoever in relation to this property.

Photographs / Floor Plans Photographs are reproduced for general information and it must not be inferred that any item is included for sale with this property. Please note floor plans are not to scale and are for identification purposes only. The photographs used in these particulars may have been taken with the use of a wide angle lens. If you have any queries as to the size of the accommodation or plot, please address these with the agent prior to making an appointment to view

Towers Wills

The White House, 114 Hendford Hill, Yeovil BA20 2RF

Yeovil 01935 577032 / South Petherton 01460 298530

info@towerswills.co.uk | www.towerswills.co.uk