

Towers Wills

Town & Country

📞 01935 577 032 | 01460 298 530 | ✉ info@towerswills.co.uk



14, Cavalier Close, Yeovil, Somerset BA21 5UP

£250,000

Towers Wills are delighted to bring to market this beautifully presented three-bedroom end of terrace home, situated within a popular residential position close to Yeovil town centre, local amenities and offering excellent access to nearby commuter links. Having been comprehensively renovated by the current owners, this exceptional property has been thoughtfully reconfigured and finished to an extremely high standard throughout, offering stylish and contemporary accommodation ideal for modern family living.

Accommodation:

The accommodation briefly comprises an inviting entrance hall leading through to a stunning open-plan living/kitchen space, fitted with modern units and finished to an excellent specification. Double doors open directly onto the rear garden, creating a wonderful flow between indoor and outdoor living and providing an ideal space for both everyday family life and entertaining.

To the first floor are three well-proportioned bedrooms, all served by a beautifully appointed contemporary family bathroom finished with modern fittings.

Outside:

Externally, the property occupies an enviable corner plot with the rear garden being a particular feature. Immediately adjoining the property is a patio seating area, with the remainder predominantly laid to lawn. The garden extends to the side of the property, where additional seating areas provide perfect spots for enjoying the summer sunshine. The garden is fully enclosed by a combination of attractive brick walling and timber fencing, offering both privacy and security, with gated side access to the front.

Further benefits include driveway parking leading to a single garage, with additional pedestrian access directly from the rear garden.

A truly impressive home, finished with exceptional attention to detail throughout. Early viewing is highly recommended to fully appreciate the quality of accommodation on offer.

Key Features

- End of Terrace
- Immaculately Presented Throughout
- Three Bedrooms
- Driveway & Garage
- Gardens

Contact Us

Towers Wills Estate Agents - Yeovil

114, Hendford Hill
Yeovil

Somerset
BA202RF

T: 01935 577032

E: info@towerswills.co.uk

Energy Efficiency

Score	Energy rating	Current	Potential
92+	A		
81-91	B		85 B
69-80	C		
55-68	D	68 D	
39-54	E		
21-38	F		
1-20	G		



Floor Plan

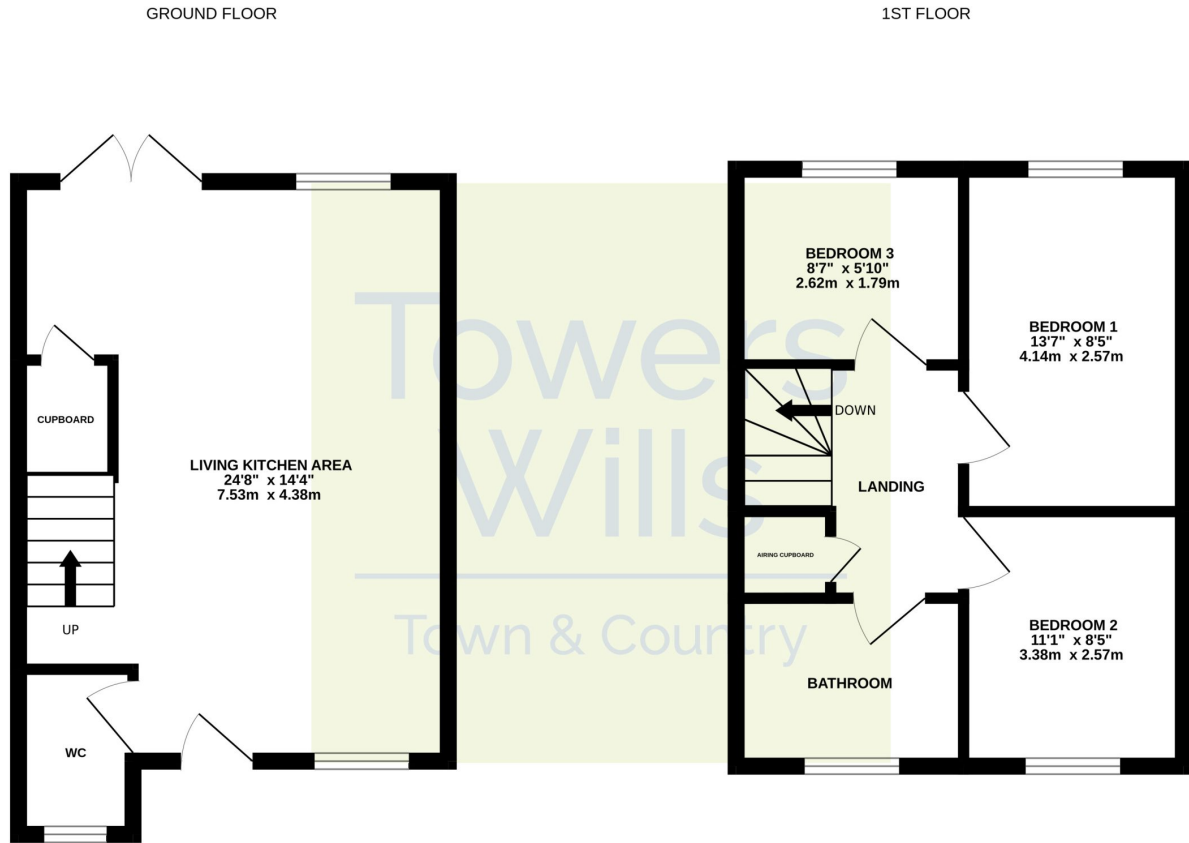

Whilst every attempt has been made to ensure the accuracy of the floorplan contained here, measurements of doors, windows, rooms and any other items are approximate and no responsibility is taken for any error, omission or mis-statement. This plan is for illustrative purposes only and should be used as such by any prospective purchaser. The services, systems and appliances shown have not been tested and no guarantee as to their operability or efficiency can be given.
Made with Metropix ©2026

Please Note No tests have been undertaken of any of the services and any intending purchasers should satisfy themselves in this regard. Towers Wills Ltd for themselves and for the vendor of this property whose agents they are, give notice that, (i) these particulars do not constitute any part of an offer or contract, (ii) all statements contained within these particulars are made without responsibility on the part of Towers Wills or the vendor, (iii) whilst made in good faith, none of the statements contained within these particulars are to be relied upon as a statement of representation or fact, (iv) any intending purchaser must satisfy him/herself by inspection or otherwise as to the correctness of each of the statements contained within these particulars, (v) the vendor does not make or give either Towers Wills or any person in their employment any authority to make or give representation or warranty whatsoever in relation to this property.

Photographs / Floor Plans Photographs are reproduced for general information and it must not be inferred that any item is included for sale with this property. Please note floor plans are not to scale and are for identification purposes only. The photographs used in these particulars may have been taken with the use of a wide angle lens. If you have any queries as to the size of the accommodation or plot, please address these with the agent prior to making an appointment to view

Towers Wills

The White House, 114 Hendford Hill, Yeovil BA20 2RF

Yeovil 01935 577032 / South Petherton 01460 298530

info@towerswills.co.uk | www.towerswills.co.uk