

Towers Wills

Town & Country

📞 01935 577 032 | 01460 298 530 | ✉ info@towerswills.co.uk



3, Meadow Road, Yeovil, Somerset BA21 5PA

£240,000

Towers Wills are delighted to present to the market this deceptively spacious three-bedroom mid-terraced home, situated within a popular residential location on the edge of Yeovil and conveniently positioned for local amenities and the town centre.

Accommodation:

The property has been exceptionally well maintained and improved by the current owners, benefiting from updated electrics, boiler and plumbing, creating a home ready for immediate occupation.

The accommodation briefly comprises; an inviting and generous entrance hallway providing access to the spacious lounge/dining room and fitted kitchen. The kitchen is equipped with a range of fitted wall and base units together with integrated appliances, whilst a useful utility area provides additional practicality with access to the rear garden and downstairs cloakroom/W.C.

To the first floor are three well-proportioned bedrooms, two of which are comfortable doubles, all served by a modern family bathroom suite

Outside:

A particular feature of the property is the beautifully landscaped rear garden, lovingly cared for to create a wonderful outdoor space ideal for relaxing and entertaining alike. To the front, there is off-road parking for one to two vehicles.

Agent's Note:

The property is subject to an element of flying freehold. Interested parties are advised to seek guidance from their legal representative.

An internal viewing is highly recommended to fully appreciate the size, condition and superb position of this attractive family home.

Key Features

- Three Bedrooms
- Terraced Property
- Off Road Parking
- Landscaped Rear Garden

Contact Us

**Towers Wills Estate
Agents - Yeovil**

114, Hendford Hill

Yeovil

Somerset

BA202RF

T: 01935 577032

E: info@towerswills.co.uk



Floor Plan

GROUND FLOOR

1ST FLOOR

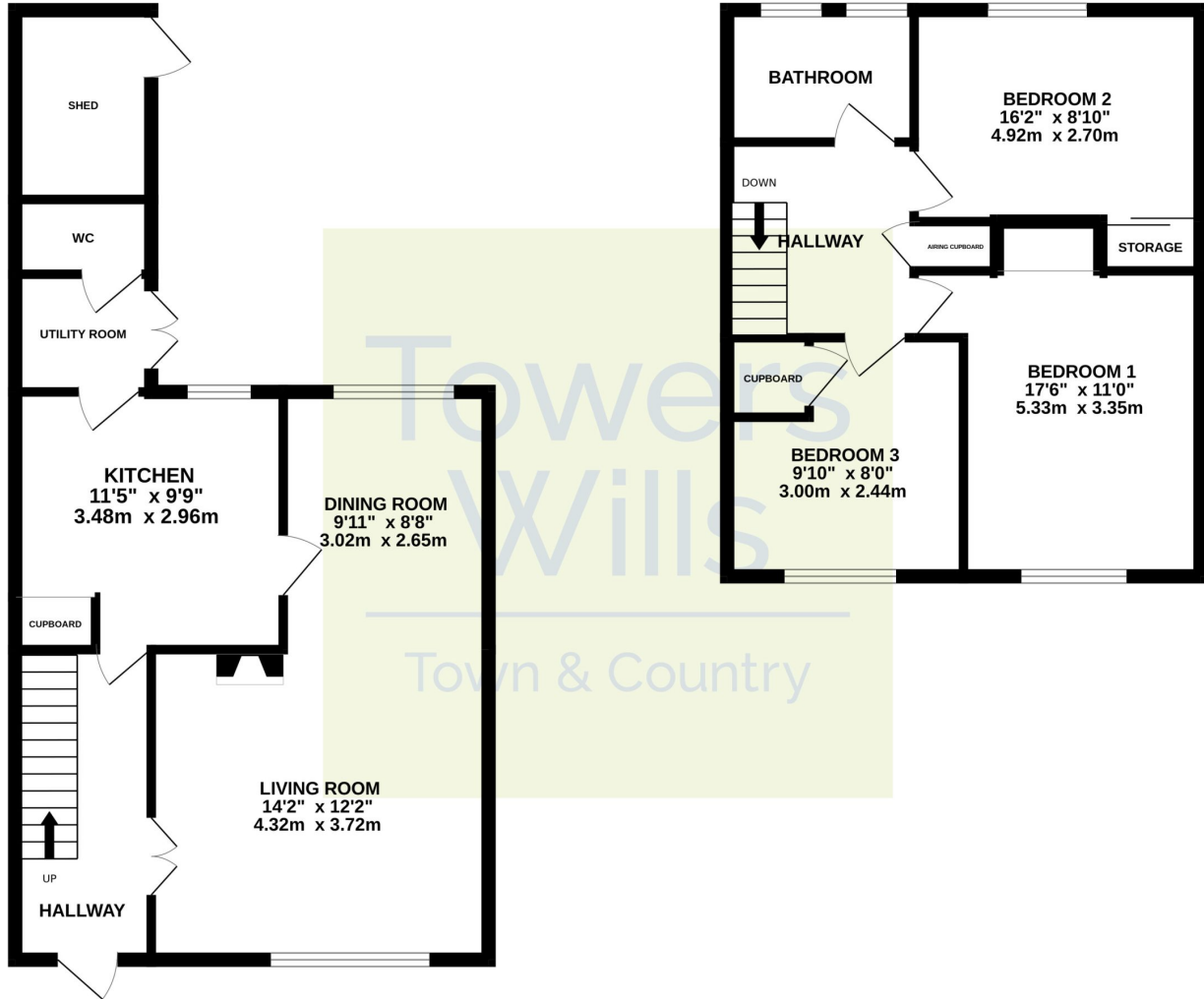

Whilst every attempt has been made to ensure the accuracy of the floorplan contained here, measurements of doors, windows, rooms and any other items are approximate and no responsibility is taken for any error, omission or mis-statement. This plan is for illustrative purposes only and should be used as such by any prospective purchaser. The services, systems and appliances shown have not been tested and no guarantee as to their operability or efficiency can be given.
Made with Metropix ©2026

Please Note No tests have been undertaken of any of the services and any intending purchasers should satisfy themselves in this regard. Towers Wills Ltd for themselves and for the vendor of this property whose agents they are, give notice that, (i) these particulars do not constitute any part of an offer or contract, (ii) all statements contained within these particulars are made without responsibility on the part of Towers Wills or the vendor, (iii) whilst made in good faith, none of the statements contained within these particulars are to be relied upon as a statement of representation or fact, (iv) any intending purchaser must satisfy him/herself by inspection or otherwise as to the correctness of each of the statements contained within these particulars, (v) the vendor does not make or give either Towers Wills or any person in their employment any authority to make or give representation or warranty whatsoever in relation to this property.

Photographs / Floor Plans Photographs are reproduced for general information and it must not be inferred that any item is included for sale with this property. Please note floor plans are not to scale and are for identification purposes only. The photographs used in these particulars may have been taken with the use of a wide angle lens. If you have any queries as to the size of the accommodation or plot, please address these with the agent prior to making an appointment to view

Towers Wills

The White House, 114 Hendford Hill, Yeovil BA20 2RF

Yeovil 01935 577032 / South Petherton 01460 298530

info@towerswills.co.uk | www.towerswills.co.uk