



## 9, Burrow Hill View, Martock, Somerset TA12 6FS

Offers Over **£270,000**

Towers Wills are delighted to bring to the market this generously proportioned and beautifully presented three-bedroom semi-detached home, situated within a popular residential development on the edge of the sought-after village of Martock. Conveniently positioned for easy access to the village amenities, commuter routes and nearby transport links, this attractive home has been well maintained by the current owners and would suit a range of purchasers including first-time buyers, young families and those looking to move to this desirable village location.

### Accommodation:

The accommodation briefly comprises an entrance hall with access to a downstairs cloakroom, as well as the spacious and welcoming lounge. A further door provides access to the modern kitchen/diner, which is fitted with a range of units and benefits from built-in integral appliances. French doors open directly onto the rear garden, creating an ideal space for both everyday living and entertaining.

To the first floor are three well-proportioned bedrooms, with the principal bedroom enjoying the advantage of an ensuite shower room, whilst a family bathroom serves the remaining bedrooms.

### Outside:

Externally, the property benefits from driveway parking to the front for up to three vehicles. To the rear is a particularly spacious and attractive garden, comprising a small patio seating area with the remainder laid mainly to lawn, bordered by shrubs and enclosed by timber fencing. A side gate provides convenient access to and from the property.

An early viewing is highly recommended to fully appreciate the space, presentation and excellent location this lovely home has to offer.

## Key Features

- Semi Detached
- Three Bedrooms
- Popular Village of Martock
- Driveway Parking
- Rear Garden

## Contact Us

### Towers Wills Estate Agents - Yeovil

114, Hendford Hill

Yeovil

Somerset

BA202RF

T: 01935 577032

E: [info@towerswills.co.uk](mailto:info@towerswills.co.uk)

## Energy Efficiency

Score	Energy rating	Current	Potential
92+	A		96 A
81-91	B	84 B	
69-80	C		
55-68	D		
39-54	E		
21-38	F		
1-20	G		



# Floor Plan

GROUND FLOOR

1ST FLOOR

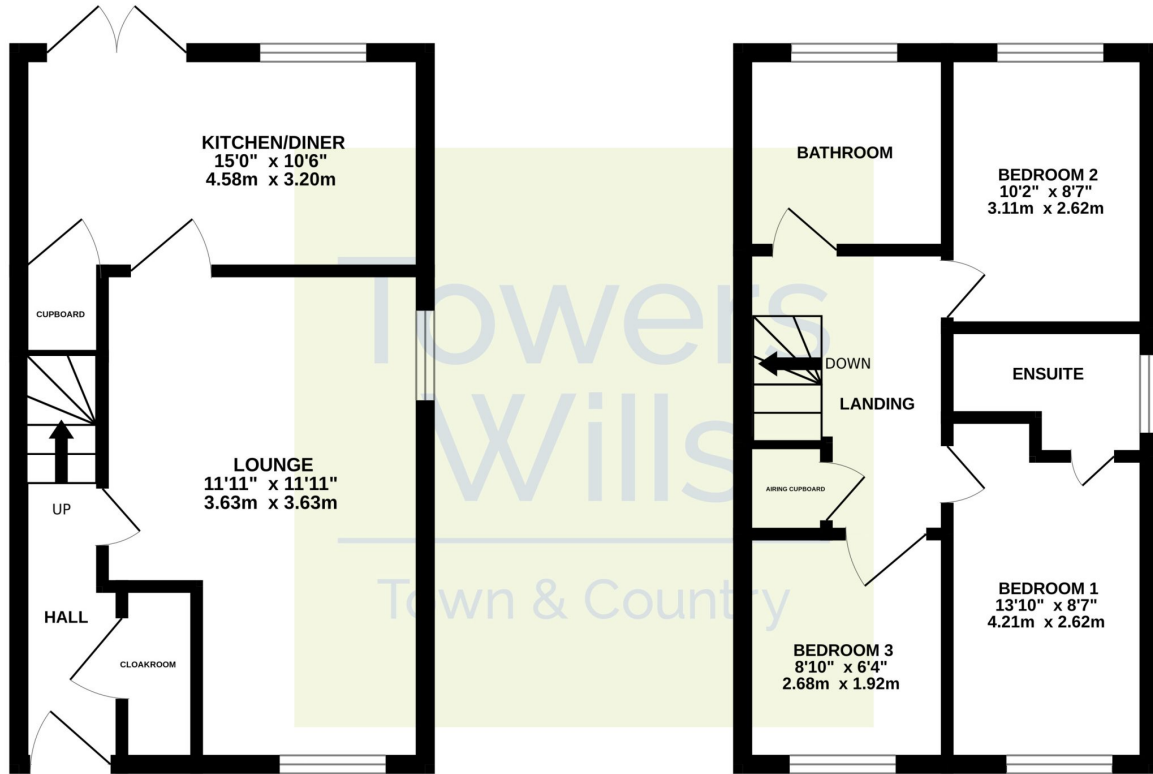

Whilst every attempt has been made to ensure the accuracy of the floorplan contained here, measurements of doors, windows, rooms and any other items are approximate and no responsibility is taken for any error, omission or mis-statement. This plan is for illustrative purposes only and should be used as such by any prospective purchaser. The services, systems and appliances shown have not been tested and no guarantee as to their operability or efficiency can be given.  
Made with Metropix ©2026

Please Note No tests have been undertaken of any of the services and any intending purchasers should satisfy themselves in this regard. Towers Wills Ltd for themselves and for the vendor of this property whose agents they are, give notice that, (i) these particulars do not constitute any part of an offer or contract, (ii) all statements contained within these particulars are made without responsibility on the part of Towers Wills or the vendor, (iii) whilst made in good faith, none of the statements contained within these particulars are to be relied upon as a statement of representation or fact, (iv) any intending purchaser must satisfy him/herself by inspection or otherwise as to the correctness of each of the statements contained within these particulars, (v) the vendor does not make or give either Towers Wills or any person in their employment any authority to make or give representation or warranty whatsoever in relation to this property.

Photographs / Floor Plans Photographs are reproduced for general information and it must not be inferred that any item is included for sale with this property. Please note floor plans are not to scale and are for identification purposes only. The photographs used in these particulars may have been taken with the use of a wide angle lens. If you have any queries as to the size of the accommodation or plot, please address these with the agent prior to making an appointment to view

**Towers Wills**

The White House, 114 Hendford Hill, Yeovil BA20 2RF

Yeovil 01935 577032 / South Petherton 01460 298530

[info@towerswills.co.uk](mailto:info@towerswills.co.uk) | [www.towerswills.co.uk](http://www.towerswills.co.uk)