

Towers Wills

Town & Country

📞 01935 577 032 | 01460 298 530 | ✉ info@towerswills.co.uk



23, Quarry Piece Drive, South Petherton, Somerset
TA13 5EL

£67,500

Towers Wills are delighted to bring to the market this generously proportioned two-bedroom end of terrace home, available on a 30% shared ownership basis, situated within a popular residential development in the highly sought-after village of South Petherton. Presented in very good decorative order throughout, this attractive home offers an excellent opportunity for first-time buyers, individuals or young couples looking to take their first step onto the property ladder.

Accommodation:

The well-planned accommodation begins with a welcoming entrance hallway, providing access to a spacious kitchen/dining room, fitted with a comprehensive range of worktops and storage units, together with space for a fridge freezer and additional white goods. To the rear of the hallway is a useful downstairs cloakroom, whilst the comfortable lounge enjoys a pleasant outlook over the rear garden and benefits from a door opening directly onto the outside space.

To the first floor are two well-proportioned double bedrooms. The second bedroom has been thoughtfully reconfigured to create two separate areas, offering excellent flexibility for use as a nursery, home office or dressing room, whilst still being easily adaptable to its original layout if desired. These rooms are served by a modern family bathroom fitted with a contemporary white suite.

Outside:

Outside, the enclosed rear garden has been attractively landscaped over two levels, with an upper patio seating area ideal for outdoor entertaining, steps leading down to an area of artificial lawn and a pedestrian gate providing rear access. A useful timber storage shed is positioned within the garden, offering practical external storage.

To the front of the property are two allocated parking spaces.

An internal viewing is highly recommended to fully appreciate the generous accommodation, excellent presentation and desirable village location this superb shared ownership home has to offer.

Agents Note:

Remaining lease term is 113 years. If a buyer purchases the 100%, this lease term will fall away on completion.

Monthly rent - £441.50

Monthly service charge - £35.26

Key Features

- 30% SHARE
- Sought-after Village Location
- End of Terrace
- In Good Condition Throughout
- Two Bedrooms
- Off Road Parking
- Rear Garden

Contact Us

**Towers Wills Estate
Agents - Yeovil**

114, Hendford Hill
Yeovil

Somerset

BA202RF

T: 01935 577032

E: info@towerswills.co.uk



Floor Plan

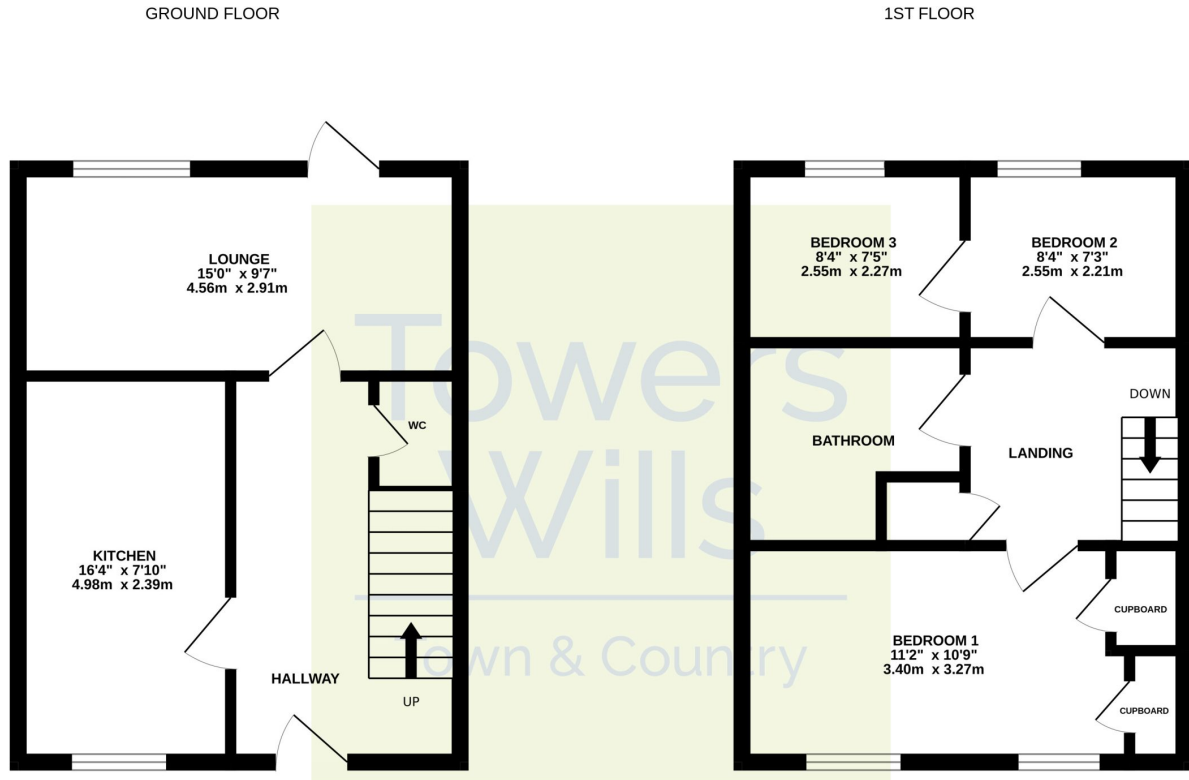

Whilst every attempt has been made to ensure the accuracy of the floorplan contained here, measurements of doors, windows, rooms and any other items are approximate and no responsibility is taken for any error, omission or mis-statement. This plan is for illustrative purposes only and should be used as such by any prospective purchaser. The services, systems and appliances shown have not been tested and no guarantee as to their operability or efficiency can be given.
Made with Metropix ©2026

Please Note No tests have been undertaken of any of the services and any intending purchasers should satisfy themselves in this regard. Towers Wills Ltd for themselves and for the vendor of this property whose agents they are, give notice that, (i) these particulars do not constitute any part of an offer or contract, (ii) all statements contained within these particulars are made without responsibility on the part of Towers Wills or the vendor, (iii) whilst made in good faith, none of the statements contained within these particulars are to be relied upon as a statement of representation or fact, (iv) any intending purchaser must satisfy him/herself by inspection or otherwise as to the correctness of each of the statements contained within these particulars, (v) the vendor does not make or give either Towers Wills or any person in their employment any authority to make or give representation or warranty whatsoever in relation to this property.

Photographs / Floor Plans Photographs are reproduced for general information and it must not be inferred that any item is included for sale with this property. Please note floor plans are not to scale and are for identification purposes only. The photographs used in these particulars may have been taken with the use of a wide angle lens. If you have any queries as to the size of the accommodation or plot, please address these with the agent prior to making an appointment to view

Towers Wills

The White House, 114 Hendford Hill, Yeovil BA20 2RF

Yeovil 01935 577032 / South Petherton 01460 298530

info@towerswills.co.uk | www.towerswills.co.uk